

TANDEM 木櫃桶路軌

Full extension - drawer/inner drawer 全拉 – 櫃桶/內櫃桶 560H

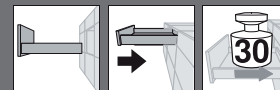

Space requirement in cabinet
櫃體內所需空間

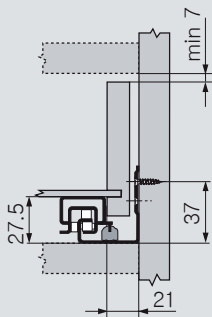

Drawer/inner drawer
櫃桶/內櫃桶

SKW Internal drawer width
櫃桶內闊
LW Inner cabinet width
櫃體內闊

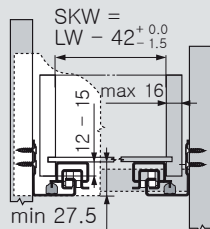

Drawer
櫃桶

SKL Drawer length 櫃桶長度
NL Nominal length 長度

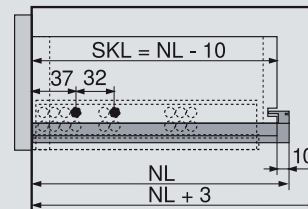

Inner drawer
內櫃桶

ISKL Inner drawer length
內櫃桶長度
SKL Drawer length 櫃桶長度
NL Nominal length 長度

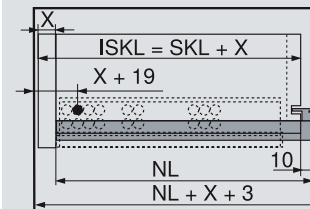

Cabinet profile screw positions 路軌螺絲鑽孔位置

Nominal length 長度 NL (mm)

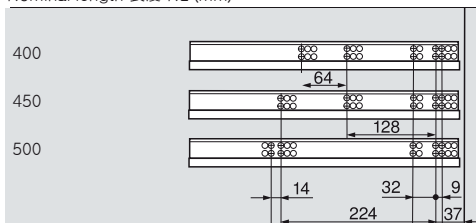

Min. internal cabinet depth = nominal length NL + 3 mm
櫃體最少內深 = 長度 NL + 3 mm

Fixing onto cabinet 安裝於櫃體

A Chipboard screws 木工螺絲
Ø 4 x 15 mm

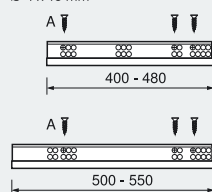

Drawer assembly 櫃桶安裝

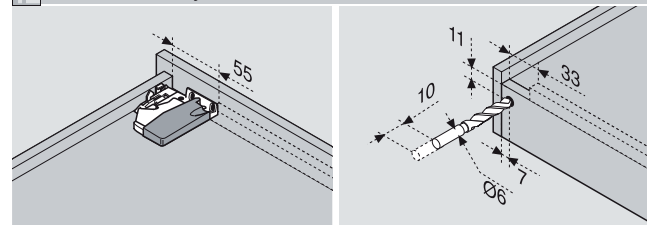

Use drilling template 使用鑽孔工具 T65.1000.02

Full extension - drawer/inner drawer 全拉 – 櫃桶/內櫃桶 560H

Assembly, removal and adjustment 安裝, 拆卸及調節

Locking device 前接碼

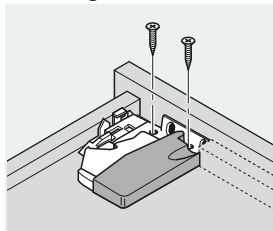

Four sided drawer
四邊櫃桶

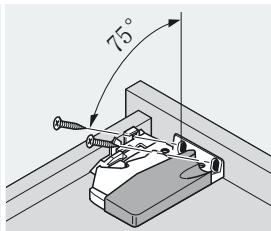

Three sided drawer
三邊櫃桶

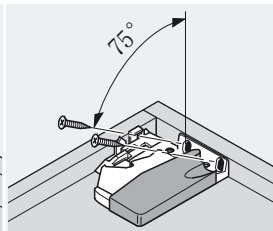

Inner drawer
內櫃桶

Adjustment 調節

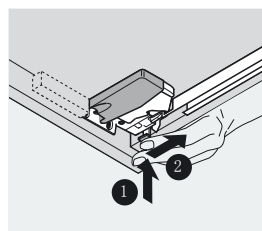

Height adjustment + 3 mm
高度調節 + 3 mm

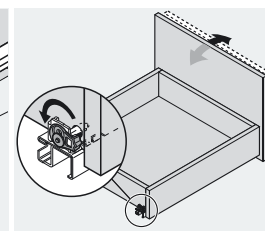

Tilt adjustment 斜度調節

Drawer insertion and removal 櫃桶嵌入及拆卸

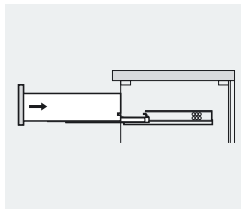

Insertion 嵌入

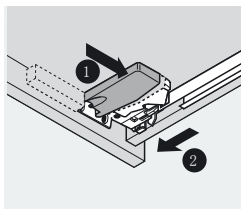
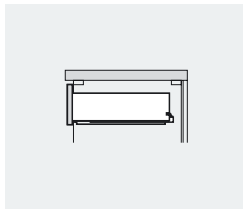

Removal 拆卸

Cleaning Instructions 清潔指引

- Wipe using lightly damp soft cloth
用微濕的軟布抹擦
- Only use clean water, do not use chemical cleaners
使用清水便可，請勿使用化學清潔劑

Attention:

Avoid dust get into the cabinet profile during installation

請注意：

安裝時請避免木屑掉進路軌

Blum Furniture Hardware
Hongkong Limited

Tel.: 852-2572 2816

Fax: 852-2572 2817

E-Mail: info.hk@blum.com

www.blum.com.hk

 **blum**®