

# AVENTOS HF top

Technical data sheet

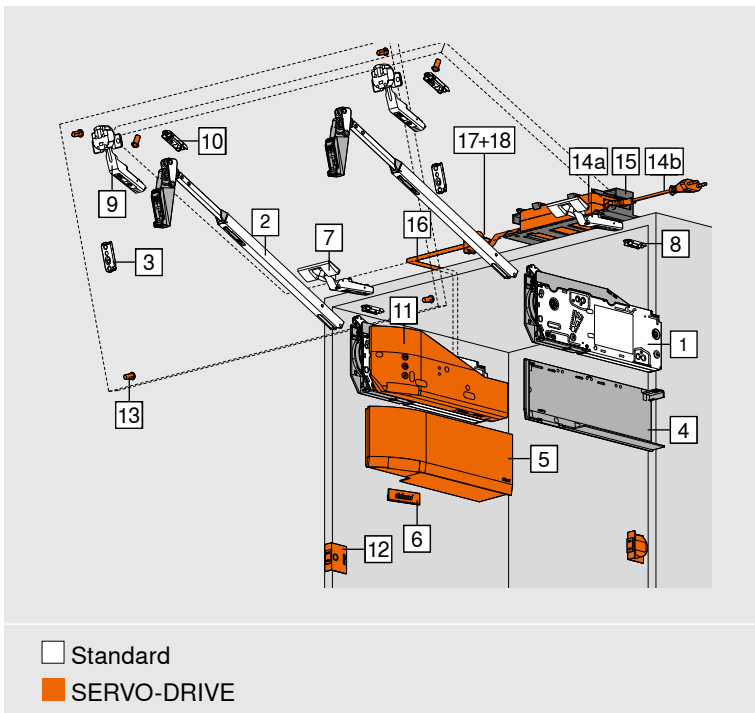

Wooden fronts and wide aluminium frames



- Ideal for higher wall cabinets with bi-fold fronts
- Cabinet height 480-1200 mm
- Cabinet width up to 1800 mm
- Internal depth of at least 264 mm
- Integrated BLUMOTION setting
- SERVO-DRIVE electrical motion support system
- Light operating forces
- Variable stop
- Integrated opening angle stop
- Standardised position of the lift mechanism and front fixing bracket
- Symmetrical lift mechanism and lever arm
- Tool-free assembly
- Two lift mechanism fixing methods
- 3-dimensional adjustment of both fronts
- Centre hinge with finger safety feature

Ordering information

Note

**Power factor (LF) = cabinet height\* (KH) [mm] x front weight including handle weight [kg]**

\* Calculate with theoretical cabinet height (TKH) for asymmetrical fronts

For asymmetrical fronts: **theoretical cabinet height TKH** = front height top FHo (mm) x 2 + gaps

The larger front must be at the top for asymmetrical fronts.

We recommend the more powerful lift mechanism for applications in overlapping ranges. A trial application is recommended when you are in a borderline area of the individual lift mechanism.

The power factor (LF) can be increased by 50% if you use a third lift mechanism.

1	<input type="checkbox"/> Standard <input type="checkbox"/> SERVO-DRIVE	Lift mechanism		
		Fixing with pre-mounted system screws		
		LF	OW	2 x
		1350–6750	81°–116°	22F2211
		2700–13500	81°–116°	22F2511
		10000–19300	81°–116°	22F2811
LF Power factor				
OW Opening angle (multi-stage adjustment)				
Symmetrical lift mechanism				
Incl. pre-mounted system screws				

1	<input type="checkbox"/> Standard <input type="checkbox"/> SERVO-DRIVE	Lift mechanism		
		Fixing with chipboard screws with positioning system		
		LF	OW	2 x
		1350–6750	81°–116°	22F2201
		2700–13500	81°–116°	22F2501
		10000–19300	81°–116°	22F2801
LF Power factor				
OW Opening angle (multi-stage adjustment)				
Symmetrical lift mechanism				
Incl. positioning system				

Wooden fronts and wide aluminium frames

Ordering information

	<b>2</b>	<b>Lever arm</b>	
		<b>Cabinet height (mm)*</b>	<b>2 x</b>
		480–610	<b>22F3201</b>
		600–910	<b>22F3501</b>
	840–1200	<b>22F3901</b>	

Symmetrical lever arm

\* For asymmetrical fronts: **theoretical cabinet height TKH** = front height top FHo (mm) x 2 + gaps

	<b>3</b>	<b>Mounting plate for lever arm</b>		
		<b>Fixing method</b>	<b>Spacing (mm)</b>	<b>2 x</b>
		Screw-on <sup>1</sup>	0	<b>175H3100</b>
		EXPANDO	0	<b>177H3100E</b>
	Knock-in	0	<b>177H3100</b>	

All horizontal steel mounting plates with 0 mm spacing possible

<sup>1</sup> Use 2 chipboard screws (609.1x00) per side for wooden fronts  
Use 2 countersunk self-tapping screws (660.0950) per side for wide aluminium frames

	<b>4</b>	<b>Cover cap right</b>		
		<b>Colour</b>	<b>Material</b>	
		SW, HGR, TGR	Nylon	<b>22.8001</b>

	<b>-</b>	<b>Cover cap left</b>		
		<b>Colour</b>	<b>Material</b>	
		SW, HGR, TGR	Nylon	<b>22.8001</b>

	<b>5</b>	<b>SERVO-DRIVE cover cap left</b>		
		<b>Colour</b>	<b>Material</b>	
		SW, HGR, TGR	Nylon	<b>23.8001</b>

	<b>6</b>	<b>Branding element</b>		
		<b>Material</b>	<b>Colour</b>	
		Nylon	SW-M, TGR	IN-G
		Printed *	2 x	<b>ABD.1000.BL</b> <b>ABD.1009.BL</b>
	Embossed *	2 x	<b>ABD.1000.BT</b> <b>ABD.1009.BT</b>	
	Plain	2 x	<b>ABD.1000</b> <b>ABD.1009</b>	

\* With Blum logo

**From 1000 pcs:**

Customised, printed branding element

**From 5000 pcs:**

Customised, embossed branding element

	<b>7</b>	<b>CLIP top 120° hinge</b>		
		<b>Boss</b>	<b>Spring</b>	<b>2 x</b>
		INSERTA	Unsprung	<b>70T5590BTL</b>
	Screw-on <sup>1</sup>	Unsprung	<b>70T5550.TL</b>	

**Boss overlay TO (fixed dimension)**

**11 mm**

3 hinges starting at cabinet width KB 1200 mm and/or 12 kg front weight

4 hinges for cabinet width KB 1800 mm and/or starting at 20 kg front weight

<sup>1</sup> Use chipboard screws (609.1x00) for wooden fronts  
Use countersunk self-tapping screws (660.0950) for wide aluminium frames

Alternative to 7

	<b>-</b>	<b>CLIP top 120° special hinge for larger front overlay</b>		
		<b>Boss</b>	<b>Spring</b>	<b>2 x</b>
		INSERTA	Unsprung	<b>72T5590BTL</b>
	Screw-on <sup>1</sup>	Unsprung	<b>72T5550.TL</b>	

**Boss overlay TO (fixed dimension)**

**13 mm**

3 hinges starting at cabinet width KB 1200 mm and/or 12 kg front weight

4 hinges for cabinet width KB 1800 mm and/or starting at 20 kg front weight

<sup>1</sup> Use chipboard screws (609.1x00) for wooden fronts  
Use countersunk self-tapping screws (660.0950) for wide aluminium frames

	<b>8</b>	<b>Mounting plate for CLIP top 120° hinge</b>		
		<b>Fixing method</b>	<b>Spacing (mm)</b>	<b>2 x</b>
		Screw-on <sup>1</sup>	0	<b>175H3100</b>
		EXPANDO	0	<b>177H3100E</b>
	Knock-in	0	<b>177H3100</b>	

Standard mounting plates, spacing depends on the upper front overlay

<sup>1</sup> Use chipboard screws (609.1x00) for wooden fronts  
Use countersunk self-tapping screws (660.0950) for wide aluminium frames

Colours and material

Name	
SW	Silk white
HGR	Light grey
TGR	Dark grey
SW-M	Silk white matt
IN-G	In-mould brushed stainless steel

Wooden fronts and wide aluminium frames

Ordering information

	<b>9 CLIP top centre hinge</b>		
	<b>Boss</b>	<b>Spring</b>	<b>2 x</b>
	Screw-on <sup>1</sup>	Unsprung	<b>78Z5500T</b>
	EXPANDO	Unsprung	<b>78Z553ET</b>
3 hinges starting at cabinet width KB 1200 mm and/or 12 kg front weight			
4 hinges for cabinet width KB 1800 mm and/or starting at 20 kg front weight			
<sup>1</sup> Use chipboard screws (609.1x00) for wooden fronts Use countersunk self-tapping screws (660.0950) for wide aluminium frames			

	<b>10 Mounting plate for CLIP top centre hinge</b>		
	<b>Fixing method</b>	<b>Spacing (mm)</b>	<b>2 x</b>
	Screw-on <sup>1</sup>	0	<b>175H3100</b>
	EXPANDO	0	<b>177H3100E</b>
	Knock-in	0	<b>177H3100</b>
Standard mounting plates with 0 mm spacing			
Only use cruciform mounting plates for wide aluminium frames with a frame width of less than 57 mm			
<sup>1</sup> Use chipboard screws (609.1x00) for wooden fronts Use countersunk self-tapping screws (660.0950) for wide aluminium frames			

	<b>11 Drive unit</b>		
	<b>Colour</b>	<b>Material</b>	
	TGR	Nylon	<b>23.A001</b>
For three lift mechanisms or more, we recommend two synchronised drive units			
We recommend one drive unit per set for connected fronts.			

	<b>12 SERVO-DRIVE switch</b>		
	<b>Colour</b>	<b>Material</b>	<b>2 x</b>
	SW, HGR, TGR	Nylon	<b>23P5020</b>
Incl. battery			

	<b>13 Blum distance bumper</b>		
	<b>Colour</b>	<b>Material</b>	<b>4 x</b>
	R7037	Nylon	
	Ø 5 mm		4 x <b>993.0530</b>
	Ø 8 mm		4 x <b>993.0830.01</b>

-	<b>SERVO-DRIVE power supply unit and accessories</b>		
	See page 7		

Colours and material

Name	
SW	Silk white
HGR	Light grey
TGR	Dark grey
R7037	RAL 7037 dust grey

**Narrow aluminium frames**

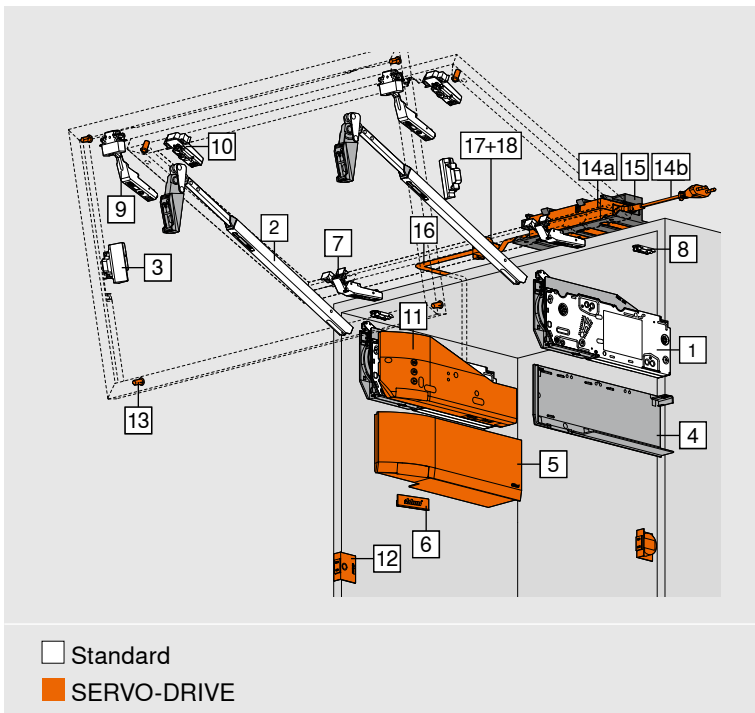

- Ideal for higher wall cabinets with bi-fold fronts
- Cabinet height 480-1200 mm
- Cabinet width up to 1800 mm
- Internal depth of at least 264 mm
- Integrated BLUMOTION setting
- SERVO-DRIVE electrical motion support system
- Light operating forces
- Variable stop
- Integrated opening angle stop
- Standardised position of the lift mechanism and front fixing bracket
- Symmetrical lift mechanism and lever arm
- Tool-free assembly
- Two lift mechanism fixing methods
- 3-dimensional adjustment of both fronts
- Centre hinge with finger safety feature

**Ordering information**

**Note**

**Power factor (LF) = cabinet height\* (KH) [mm] x front weight including handle weight [kg]**

\* Calculate with theoretical cabinet height (TKH) for asymmetrical fronts

For asymmetrical fronts: **theoretical cabinet height TKH** = front height top FHo (mm) x 2 + gaps

The larger front must be at the top for asymmetrical fronts.

We recommend the more powerful lift mechanism for applications in overlapping ranges. A trial application is recommended when you are in a borderline area of the individual lift mechanism.

The power factor (LF) can be increased by 50% if you use a third lift mechanism.

1	<input type="checkbox"/> Standard <input checked="" type="checkbox"/> SERVO-DRIVE	Lift mechanism		
	Fixing with pre-mounted system screws			
	LF	OW	2 x	
	1350–6750	81°–116°	22F2211	
	2700–13500	81°–116°	22F2511	
	10000–19300	81°–116°	22F2811	
LF Power factor				
OW Opening angle (multi-stage adjustment)				
Symmetrical lift mechanism				
Incl. pre-mounted system screws				

1	<input type="checkbox"/> Standard <input checked="" type="checkbox"/> SERVO-DRIVE	Lift mechanism		
	Fixing with chipboard screws with positioning system			
	LF	OW	2 x	
	1350–6750	81°–116°	22F2201	
	2700–13500	81°–116°	22F2501	
	10000–19300	81°–116°	22F2801	
LF Power factor				
OW Opening angle (multi-stage adjustment)				
Symmetrical lift mechanism				
Incl. positioning system				

Narrow aluminium frames

Ordering information

	<b>2</b>	<b>Lever arm</b>		
		<b>Cabinet height (mm)*</b>	<b>2 x</b>	
		480–610	22F3201	
		600–910	22F3501	
	840–1200	22F3901		
Symmetrical lever arm				
* For asymmetrical fronts: <b>theoretical cabinet height TKH = front height top FHo (mm) x 2 + gaps</b>				
	<b>3</b>	<b>CLIP adapter plate set for lever arms</b>		
		<b>Version</b>	<b>Spacing (mm)</b>	
		Left/right	0	175H5B00
	<b>4</b>	<b>Cover cap right</b>		
		<b>Colour</b>	<b>Material</b>	
		SW, HGR, TGR	Nylon	22.8001
	-	<b>Cover cap left</b>		
		<b>Colour</b>	<b>Material</b>	
		SW, HGR, TGR	Nylon	22.8001
	<b>5</b>	<b>SERVO-DRIVE cover cap left</b>		
		<b>Colour</b>	<b>Material</b>	
		SW, HGR, TGR	Nylon	23.8001
	<b>6</b>	<b>Branding element</b>		
		<b>Material</b>	<b>Colour</b>	
		Nylon	SW-M, TGR	IN-G
		Printed *	2 x	ABD.1000.BL ABD.1009.BL
	Embossed *	2 x	ABD.1000.BT ABD.1009.BT	
	Plain	2 x	ABD.1000 ABD.1009	
* With Blum logo				
<b>From 1000 pcs:</b>				
Customised, printed branding element				
<b>From 5000 pcs:</b>				
Customised, embossed branding element				
	<b>7</b>	<b>CLIP top 120° aluminium frame door hinge</b>		
		<b>Boss</b>	<b>Spring</b>	<b>2 x</b>
		Screw-on	Unsprung	72T550A.TL
3 hinges starting at cabinet width KB 1200 mm and/or 12 kg front weight				
4 hinges for cabinet width KB 1800 mm and/or starting at 20 kg front weight				
Fixing screws are included				

	<b>8</b>	<b>Mounting plate for CLIP top 120° hinge</b>		
		<b>Fixing method</b>	<b>Spacing (mm)</b>	<b>2 x</b>
		Screw-on <sup>1</sup>	0	175H3100
		EXPANDO	0	177H3100E
	Knock-in	0	177H3100	
Standard mounting plates, spacing depends on the upper front overlay				
<sup>1</sup> Use 2 countersunk self-tapping screws (660.0950) per side for narrow aluminium frames				
	<b>9</b>	<b>CLIP top aluminium centre hinge</b>		
		<b>Boss</b>	<b>Spring</b>	<b>2 x</b>
		Screw-on <sup>1</sup>	Unsprung	78Z550AT
3 hinges starting at cabinet width KB 1200 mm and/or 12 kg front weight				
4 hinges for cabinet width KB 1800 mm and/or starting at 20 kg front weight				
<sup>1</sup> Use 2 countersunk self-tapping screws (660.0950) per side for narrow aluminium frames				
	<b>10</b>	<b>CLIP adapter plate for centre hinges</b>		
		<b>Version</b>	<b>Spacing (mm)</b>	<b>2 x</b>
		Symmetrical	0	175H5A00
Fixing screws are included				
	<b>11</b>	<b>Drive unit</b>		
		<b>Colour</b>	<b>Material</b>	
		TGR	Nylon	23.A001
For three lift mechanisms or more, we recommend two synchronised drive units				
We recommend one drive unit per set for connected fronts.				
	<b>12</b>	<b>SERVO-DRIVE switch</b>		
		<b>Colour</b>	<b>Material</b>	<b>2 x</b>
		SW, HGR, TGR	Nylon	23P5020
Incl. battery				
	<b>13</b>	<b>Blum distance bumper</b>		
		<b>Colour</b>	<b>Material</b>	<b>4 x</b>
		R7037	Nylon	
	Ø 5 mm		4 x	993.0530
	Ø 8 mm		4 x	993.0830.01
-		<b>SERVO-DRIVE power supply unit and accessories</b>		
See page 7				

Colours and material

Name			
SW	Silk white	TGR	Dark grey
HGR	Light grey	SW-M	Silk white matt
IN-G	In-mould brushed stainless steel	R7037	RAL 7037 dust grey

SERVO-DRIVE power supply unit and accessories

Ordering information

14 <b>SERVO-DRIVE power supply unit incl. flex</b>					
Market	Language package		Market	Language package	
E	A	Z10NE04EA	I	A	Z10NE04IA
E	B	Z10NE04EB	K	I	Z10NE04KI
E	C	Z10NE04EC	N	H	Z10NE04NH
E	D	Z10NE04ED	R	H	Z10NE04RH
E	E	Z10NE04EE	S	K	Z10NE04SK
E	F	Z10NE04EF	T	H	Z10NE04TH
E	I	Z10NE04EI	U	G	Z10NE04UG
B	A	Z10NE04BA	U	J	Z10NE04UJ
B	I	Z10NE04BI	Z	I	Z10NE04ZI
H	I	Z10NE04HI			
<b>Consisting of:</b>					
14a	1 x	SERVO-DRIVE power supply unit Incl. operating and installation instructions			
14b	1 x	Flex Length 1.5–1.8 m, incl. plug			
15 <b>Power supply unit housing</b>					
		Colour	Material		
		WGR	Nylon	Z10NG120	
For SERVO-DRIVE power supply unit					
- <b>SERVO-DRIVE plug-in power supply unit</b>					
<b>Only suitable for one drive unit</b>					
Market	Language package		Market	Language package	
E	A	Z10NA40EA	E	F	Z10NA40EF
E	B	Z10NA40EB	B	A	Z10NA40BA
E	C	Z10NA40EC	K	I	Z10NA40KI
E	D	Z10NA40ED	N	H	Z10NA40NH
E	E	Z10NA40EE	U	G	Z10NA40UG
Item available on request					
<b>Consisting of:</b>					
-	1 x	SERVO-DRIVE plug-in power supply unit Incl. cable, 1120 mm (with SERVO-DRIVE distribution cable extendible to max. 2000 mm) Incl. operating and installation instructions			

Accessories

16 <b>SERVO-DRIVE distribution cable</b>				
		Colour	Length (m)	
		SZ	6	Z10K600A
		SZ	100	Z10K1HMA
For cutting to size				
17 <b>Connecting node</b>				
		Colour	Material	
		SZ	Nylon	Z10V1000.01
18 <b>Cable end protector</b>				
		Colour	Material	
		R7037	Nylon	Z10K0008
- <b>Cable holder</b>				
		Colour	Material	
		WS	Nylon	Z10K0009
E.g. for fixing the SERVO-DRIVE distribution cable				
- <b>SERVO-DRIVE switch attachment</b>				
		Colour	Material	
		SW, HGR, TGR	Nylon	2 x Z10P5216
For attaching the SERVO-DRIVE switch to the cabinet side without milling				

Markets and language packages

Name			
Markets		Language packages*	
E	Europa	A	DE, EN, FR, IT, NL
B	UK	B	DA, EN, FI, NO, SV
H	IN	C	EL, EN, HR, SR, SL, TR
I	IL	D	EN, ES, FR, IT, PT
K	AU	E	CS, HU, PL, SK
N	CN	F	BG, ET, LV, LT, RO, RU, UK
R	KR	G	EN, ES, FR
S	BR	H	EN, ZH, KO
T	TW	I	EN
U	US   CA   JP	J	JA
Z	ZA	K	EN, ES, PT

\* Language descriptions as per ISO-639

Colours and material

Name			
WS	White	TGR	Dark grey
SW	Silk white	SZ	Black
WGR	White grey	R7037	RAL 7037 dust grey
HGR	Light grey		

Wooden fronts, wide and narrow aluminium frames

Planning

**Wooden fronts and wide aluminium frames**

A	Cabinet
B	Top front
C	Bottom front
KB	Cabinet width
KH	Cabinet height
LT	Internal cabinet depth

**Narrow aluminium frames**

A	Cabinet
B	Top front
C	Bottom front
KB	Cabinet width
KH	Cabinet height
LT	Internal cabinet depth

**Drilling position**

**System screws**

KH (mm)	H (mm)	X (mm)	Y (mm)
480-519	93.5	38.5	102
520-1200	116	38.5	124

KH Cabinet height

**Chipboard screws incl. positioning system**

KH (mm)	H (mm)	X (mm)	Y (mm)
480-519	93	38.5	102
520-1200	115.5	38.5	124

4 x chipboard screws Ø 4 x 35 mm

KH Cabinet height

KH (mm)
520-1200

KH Cabinet height



Wooden fronts, wide and narrow aluminium frames

Planning

**Space requirement**

Lever arm		LH min. (mm)	
22F3201		443	
22F3501		512	
22F3901		632	
KH (mm)	A (mm)	B (mm)	C min. (mm)
480-519	66.5	171.5	172
520-1200	89.0	194.0	195

KH Cabinet height  
LH Internal cabinet height

**Space requirement above**

$X\ max = FH \times 0.9 + 1.5 \times FD + 35$

Opening angle stop	Y (mm)
116°	$FH \times 0.44 + 38$
107°	$FH \times 0.29 + 35$
97°	$FH \times 0.12 + 31$
88°	28
81°	0

FD Front thickness  
FH Front height

**Symmetrical front**

$KH = FHo \times 2 + Fo + Fm + Fu$

Fo	Top gap
Fm	Middle gap
Fu	Bottom gap
FHo	Front height top
FHu	Lower front height
KH	Cabinet height

**Asymmetrical front**

$TKH = FHo \times 2 + Fo + Fm + Fu$

Fo	Top gap
Fm	Middle gap
Fu	Bottom gap
FHo	Front height top
FHu	Lower front height
TKH	Theoretical cabinet height

Wooden fronts and wide aluminium frames

Planning

Front assembly

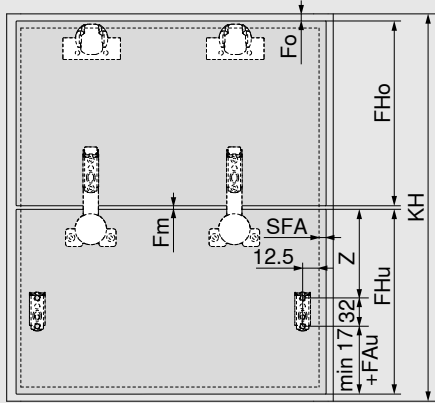

Cabinet height KH (mm)	Z (mm)
480–519	170
520–1200	189

- Fo Top gap
- Fm Middle gap
- FAu Bottom front overlay
- FHo Front height top
- FHu Lower front height
- SFA Side front overlay

CLIP top 120° hinge

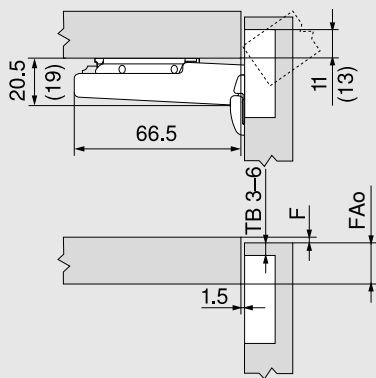

TB Boss drilling distance

FAo Upper front overlay

F Gap

() CLIP top 120° special hinge

Boss drilling distance TB

MD	Front overlay FA (mm)												
	5	6	7	8	9	10	11	12	13	14	15	16	17
0										3	4	5	6
3							3	4	5	6			
6				3	4	5	6						
9	3	4	5	6									

MD Mounting plate spacing (mm)

The front overlay must always be 2 mm bigger for the CLIP top 120° special hinge.

CLIP top centre hinge

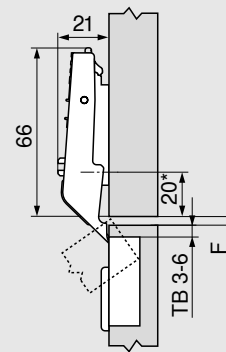

TB Boss drilling distance

F Min. gap 1.5 mm

\* 37 mm for cruciform mounting plates (37/32)

Boss drilling distance TB

MD	Horizontal gap F between fronts (mm)									
							3	4	5	6
0							6	5	4	3
3										
6										
9										

MD Mounting plate spacing (mm)

Screw-on assembly

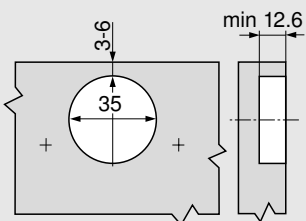

INSERTA | EXPANDO assembly

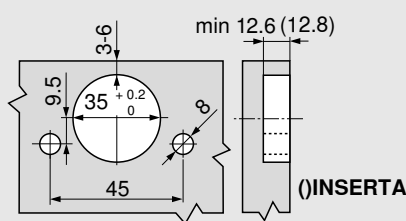

Hinge boss dimensions

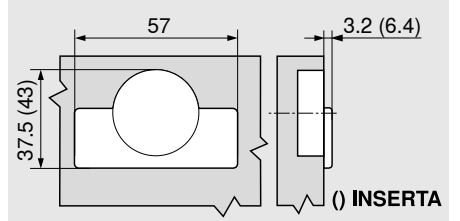

Narrow aluminium frames

Planning

Front assembly

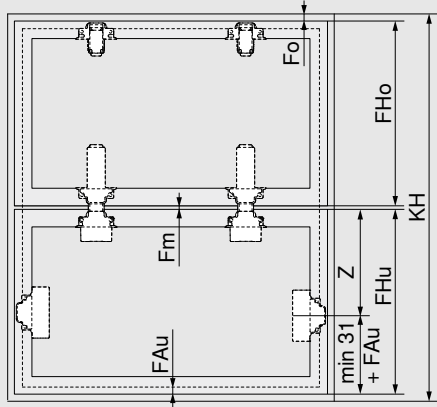

Cabinet height KH (mm)	Z (mm)
480–519	188
520–1200	207

- Fo Top gap
- Fm Middle gap
- FAu Bottom front overlay
- FHo Front height top
- FHu Lower front height

CLIP top 120° aluminium frame door hinge

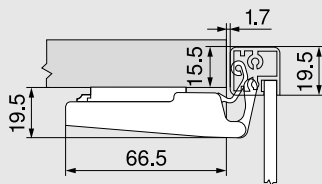

CLIP top aluminium centre hinge

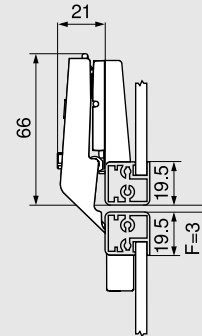

- F Min. gap 1.5 mm
- The gap needs to be adjusted for a frame thickness of 20.5 mm or greater

Screw-on assembly (hinge | adapter plate)

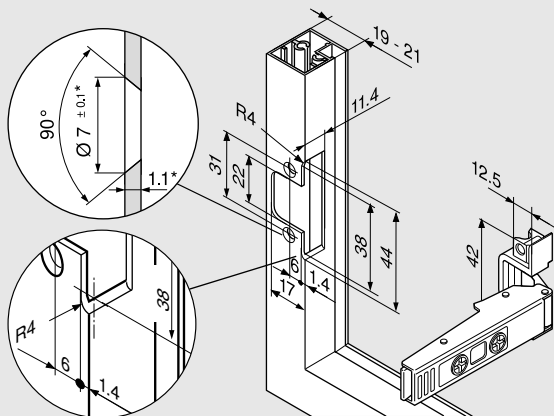

\* When changing material thickness, adjust the assembly dimensions accordingly



Find more information on assembly and adjustment of AVENTOS HF top at [www.blum.com/hftopassembly](http://www.blum.com/hftopassembly)

SERVO-DRIVE for AVENTOS HF top

Planning

Blum distance bumper (SERVO-DRIVE application only)

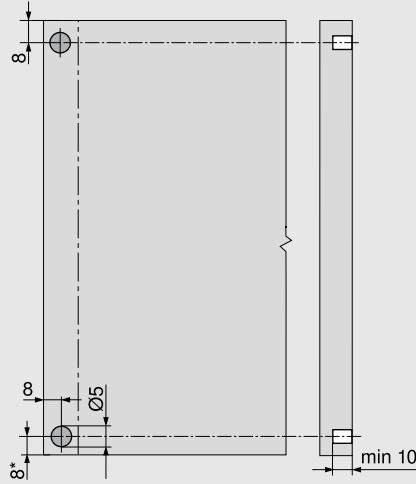

Insert Blum distance bumper (do not glue)

Recommendation for aluminium frames

Drill hole into cabinet side for Blum distance bumper

A trial application must be carried out if fixed to the front

\* From cabinet bottom edge for fronts that protrude below

SERVO-DRIVE switch

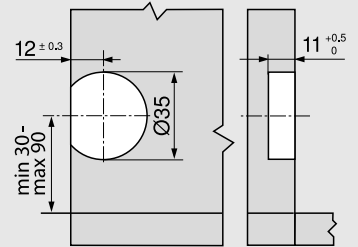

Our EASY ASSEMBLY app provides information about assembly and adjustment of AVENTOS HF top and SERVO-DRIVE

[www.blum.com/eaapp](http://www.blum.com/eaapp)

SERVO-DRIVE power supply unit and accessories

Planning

Space requirement and safety distance

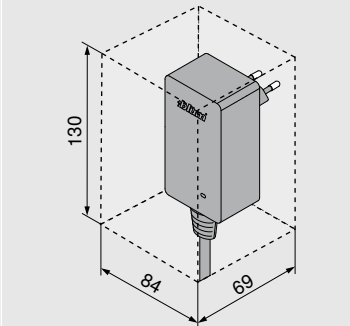
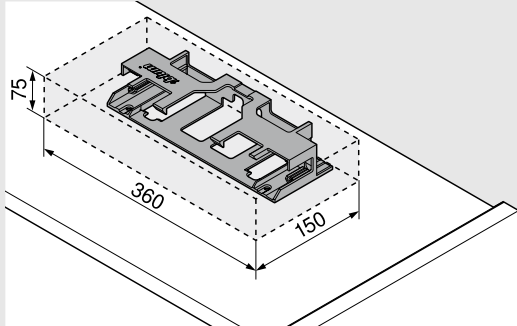

**i** A safety distance of 30 mm must be maintained for air circulation (see graphic); otherwise, there is a risk that the SERVO-DRIVE power supply unit or SERVO-DRIVE plug-in power supply unit could overheat.

Assembly on the cabinet top panel

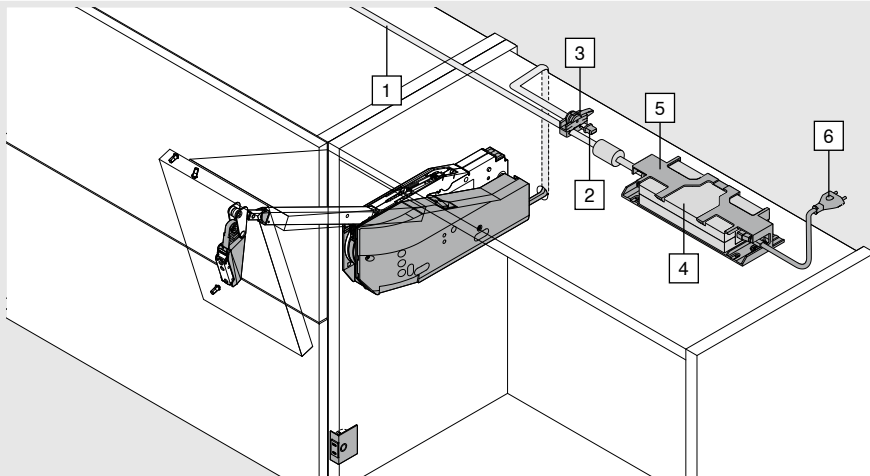

- 1 SERVO-DRIVE distribution cable
- 2 Connecting node
- 3 Cable end protector
- 4 SERVO-DRIVE power supply unit
- 5 Power supply unit housing
- 6 Flex

**i** Only one SERVO-DRIVE power supply unit can be connected to each SERVO-DRIVE distribution cable!

Back cabling

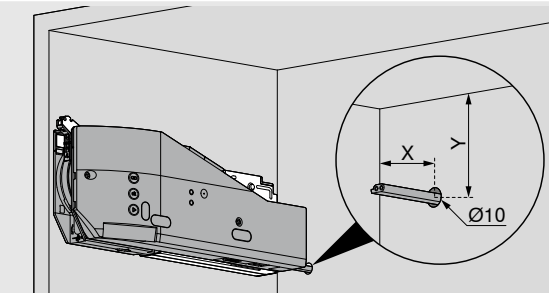

		X (mm)	Y (mm)
AVENTOS HF top	Cabinet height KH (mm)	480–519	102
		520–1200	124



Find more information on assembly and adjustment of SERVO-DRIVE for AVENTOS top at [www.blum.com/servodrive-aventos-assembly](http://www.blum.com/servodrive-aventos-assembly)

Accessories for AVENTOS HF top

Ordering information

Hinge set – wooden fronts



Ordering information

Fixing method

INSERTA | Knock-in | EXPANDO

☎ 78Z5530T11

Consisting of:

2 x	CLIP top 120° hinge unsprung 70T5590BTL
2 x	CLIP top centre hinge unsprung 78Z5530T
6 x	Horizontal cam mounting plate 177H3100

Hinge set – wooden fronts and wide aluminium frames



Ordering information

Fixing method

Screw-on<sup>1</sup>

☎ 78Z5500T12

Consisting of:

2 x	CLIP top 120° hinge unsprung 70T5550.TL
2 x	CLIP top centre hinge unsprung 78Z5500T  For wide aluminium frames, an additional cruciform mounting plate is required for the CLIP top centre hinge.
6 x	Horizontal cam mounting plate 175H3100

<sup>1</sup> Use chipboard screws (609.1x00) for wooden fronts  
Use countersunk self-tapping screws (660.0950) for wide aluminium frames

Hinge set – narrow aluminium frames



Ordering information

Fixing method

Screw-on

☎ 78Z550AT11

Consisting of:

2 x	CLIP top 120° aluminium frame door hinge unsprung 72T550A.TL
2 x	CLIP top aluminium centre hinge unsprung 78Z550AT
2 x	Horizontal cam mounting plate 175H5400
2 x	CLIP adapter plate symmetrical 175H5A00
2 x	CLIP adapter plate left/right 175H5B00

Julius Blum GmbH  
6973 Höchst, Austria  
Tel.: +43 5578 705-0  
Fax: +43 5578 705-44  
E-mail: [info@blum.com](mailto:info@blum.com)  
[www.blum.com](http://www.blum.com)

Our sites in Austria, Poland and China are certified to the international standards mentioned below.  
Our site in the USA is certified to ISO 9001.  
Our site in Brazil is certified to ISO 9001, ISO 14001 and ISO 45001.



**ISO 9001**  
Certified Quality  
System



**ISO 14001**  
Certified Environmental  
System



**ISO 50001**  
Certified Energy  
System

 **blum**®



Look for our  
FSC™-certified  
products

All content is copyrighted by Blum.  
Subject to technical modifications and changes to the range without notice.  
TD-142/2 EN-AL/07.24