

Hinges

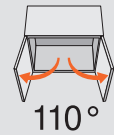

COMPACT 33

Product discontinued 2023



Features

- 110° opening angle
- Two piece assembly
- Edge or face mount
- 1/2" cup depth
- ±9/64" height adjustment
- 1/8" side adjustment only
- Zinc die-cast hinge and mounting plates
- Can be used with BLUMOTION 971A9700

Minimum Reveal

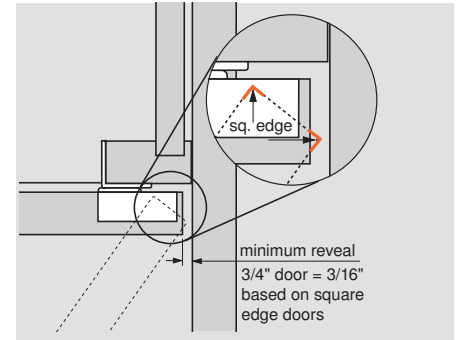

Boring pattern

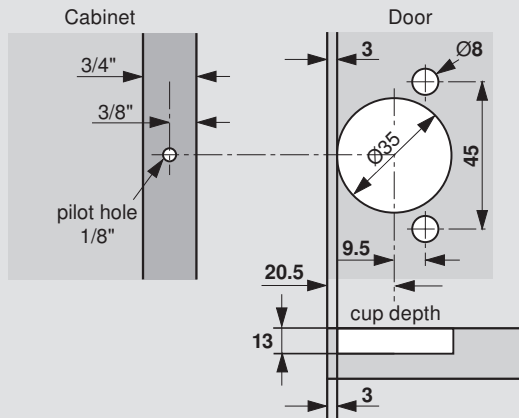

NOTE: Maximum door thickness 3/4"

Attachment options

Edge mount

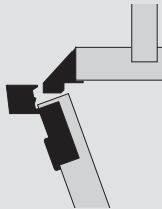

Face mount

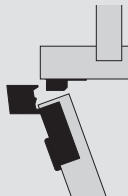

| Attachment | Screw-on | Press-in |
|------------|----------|----------|
| | 33.3600 | 33.3630 |

Installation screw

| | |
|------------|--------------|
| Wood screw | 606N or 606P |
|------------|--------------|

Edge mount specifications

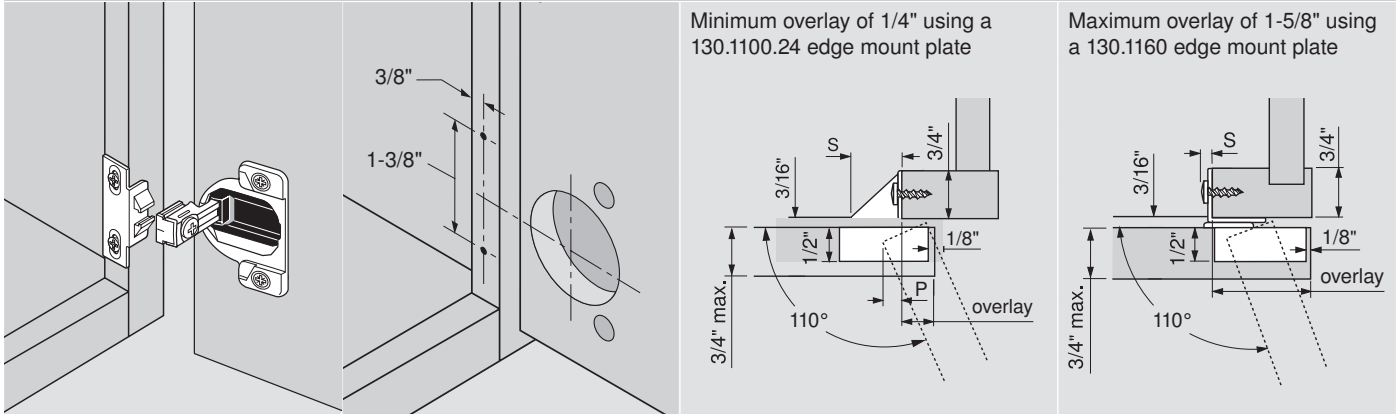

Edge mount mounting plates



- Zinc die-cast, nickel-plated
- Attaches with #6 x 5/8" wood screws (606N or 606P)
- Overlays from 1/4" to 1-5/8"

NOTE: An additional screw is required on mounting plates with 1-3/8" to 1-5/8" overlays to insure stability. Install after height adjustments have been made.

| Overlay | Hinge arm protrusion (S) | Door protrusion (P) | Mounting plate |
|---------|--------------------------|---------------------|----------------|
| 1/4" | 1-1/8" | 1/2" | 130.1100.24 |
| 1/2" | 7/8" | 1/4" | 130.1100.23 |
| 5/8" | 3/4" | 1/8" | 130.1100.26 |
| 3/4" | 5/8" | 0 | 130.1100.22 |
| 1" | 3/8" | 0 | 130.1110.02 |
| 1-1/8" | 1/4" | 0 | 130.1120.02 |
| 1-1/4" | 3/16" | 0 | 130.1130.02 |
| *1-3/8" | 3/16" | 0 | 130.1140.02 |
| *1-1/2" | 3/16" | 0 | 130.1150.02 |
| *1-5/8" | 3/16" | 0 | 130.1160 |

Face mount mounting plate

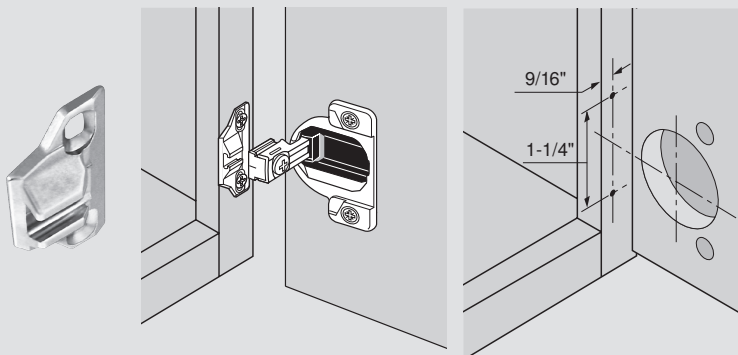

- Zinc die-cast, nickel-plated
- Attaches with #6 x 5/8" wood screws (606N or 606P)
- Overlays 1-3/8" or greater

Mounting plate

Part no.

Face mount

133.0240

Hinges



COMPACT 33 hinge & mounting plate adjustments

Product discontinued 2023

Side adjustment

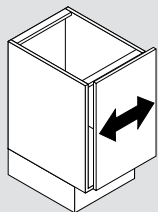

Loosen front screw. Adjust door to position and retighten screw.

Range = 3 (1/8")

Full overlay

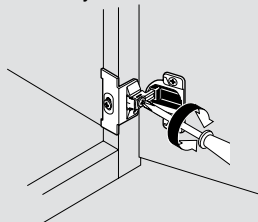

Partial overlay

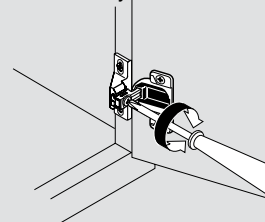

Height adjustment

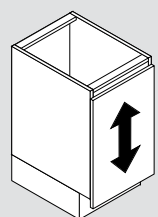

Loosen installation screws on the mounting plate. Adjust door to position and retighten screws.

Range = 7 (9/32")

Full overlay

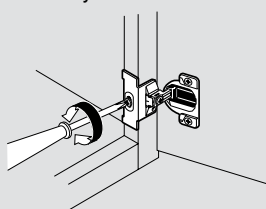

Partial overlay

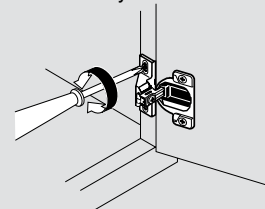

Door installation

To reinstall, slide hinge onto mounting plate, tighten screws.

NOTE: Before finishing hinge installation, place set screw in hinge plate to prevent hinge plate movement (1-3/8" or greater overlays only)

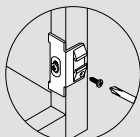

Full overlay

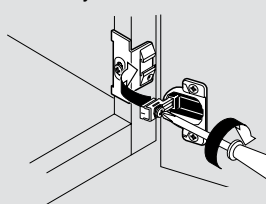

Partial overlay

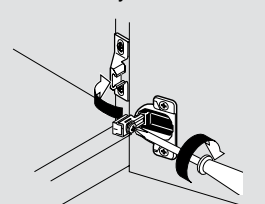

Door removal

Loosen side adjustment screws. Slide hinge off mounting plate towards center of cabinet.

Full overlay

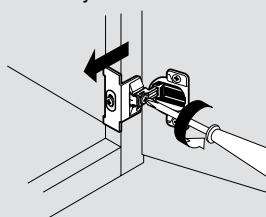

Partial overlay

