

BOXFIX plus ZMM.2500

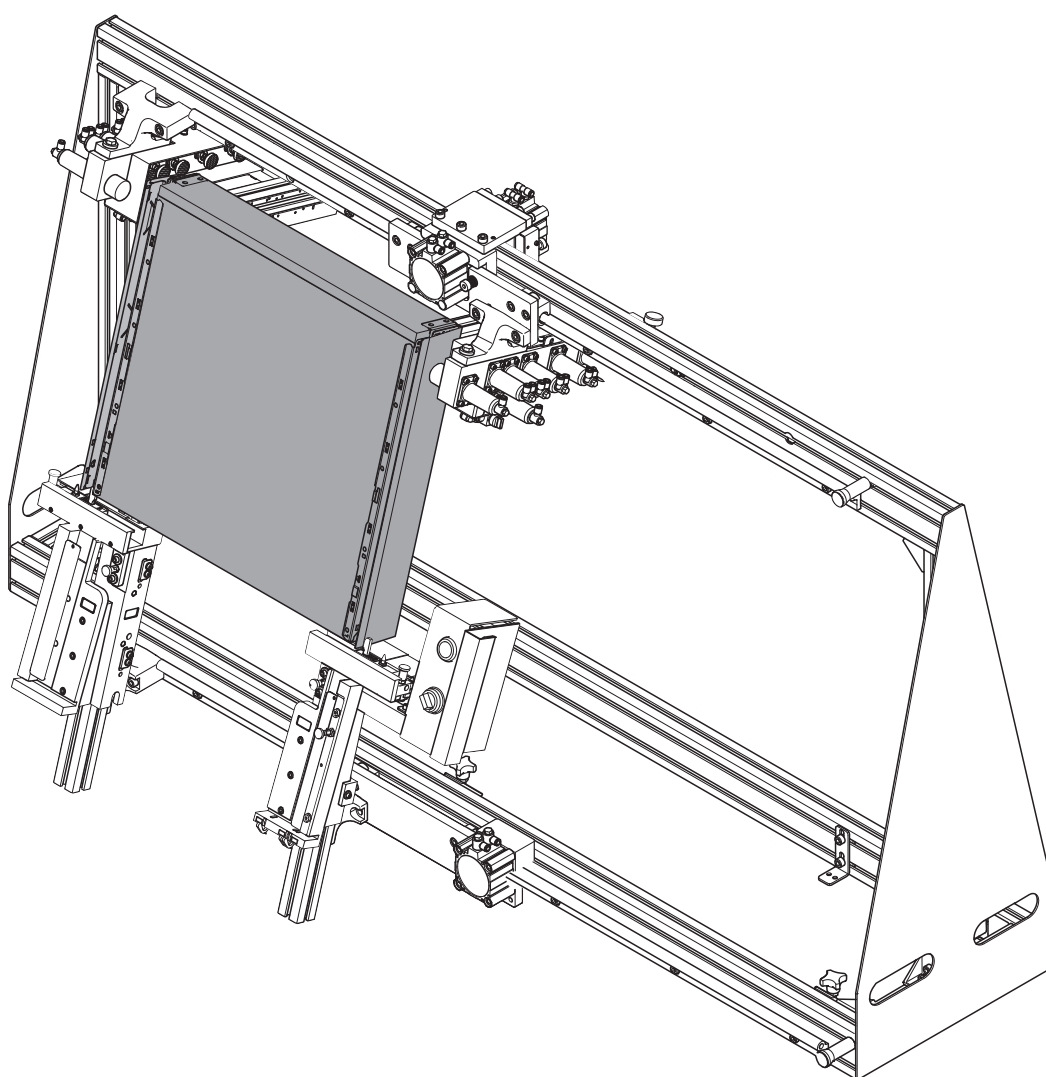

Handling

- Please read the operating instructions and the safety information before start-up of the assembly machine.
- We recommend that you use the reference diagrams to make it easier to identify the parts being described.

Safety principle

- The assembly machine complies with current safety standards. Nevertheless, there will still be certain residual risks if the information contained in these operating instructions is not observed.

**Residual risk according to
EN ISO 12100:2010**

- The assembly machine is equipped with all the necessary protection features.
- However, there will still be some residual risks for the user, particularly when removing the safety equipment or when control units fail.
- Other residual risks are identified by warning signs and safety information. It is therefore necessary to observe the safety information.

Intended use

- The assembly device is designed for manufacturing LEGRABOX, MERIVOBX and TANDEMBOX drawers.
- The assembly device may only be used in skilled OEM and distribution applications. The manufacturer accepts no liability for uses other than those described in the operating instructions!
- Only use in dry, enclosed rooms.
- The device can be extended to include a nailer set (ZMZ.20S1).

Areas of responsibility**The operator**

- must ensure that only fully-trained personnel, who have read and understood the operating instructions, especially the chapter on safety, operate and service the assembly machine.
- is responsible for the safety-related condition of the assembly machine.
- will take the assembly machine out of service immediately when faults are discovered that affect safety.

Risk levels



WARNING

- WARNING indicates a danger that could lead to serious injury if not avoided.



CAUTION

- CAUTION indicates a danger that could lead to injury if not avoided.



NOTE

- This NOTE symbol indicates information that should be observed.

Safety information



WARNING

Serious cut injuries. Caution, danger of crushing
Failure to heed this warning may result in personal injury.

- The assembly machine must be disconnected from the pressurised air system before cleaning and maintenance.

- Before changing tools, retooling or working in the vicinity of the pneumatic unit, disconnect the assembly device from the pressurised air supply.
- Do not make any changes or alterations to the assembly machine.
- Protection equipment must not be removed.
- Before starting work, before any shift change or change of personnel, you should check that the protection equipment and machine parts are functioning properly. Any damaged parts should be replaced by original parts from Blum.
- Every time before starting work, check the pneumatic hoses for damage.
- Repairs may only be performed by authorised personnel.
- If there are any questions, please contact the BLUM Customer Service Department.

Personal protective equipment

- All national regulations regarding labour law, industrial safety as well as all disposal guidelines must be followed.
- Wear eye protection.
- Wear ear protection.
- Wear appropriate work clothing.
- Wear gloves.
- Wear safety boots.

Warning signs



Before connecting the assembly machine to the pressurised air system, you must ensure that you have understood ALL the safety instructions, warning signs and the operating instructions.



Keep unauthorised persons away from the assembly machine. Only **1** person at a time should operate the assembly machine.



Always wear eye protection when operating this machine.



Always wear ear protection when operating this machine.



Wear gloves.



Caution, danger of crushing



Wear safety boots.



People with pacemakers or implanted defibrillators must not enter this area.



Warning of magnetic field.

Position of warning signs and danger zones

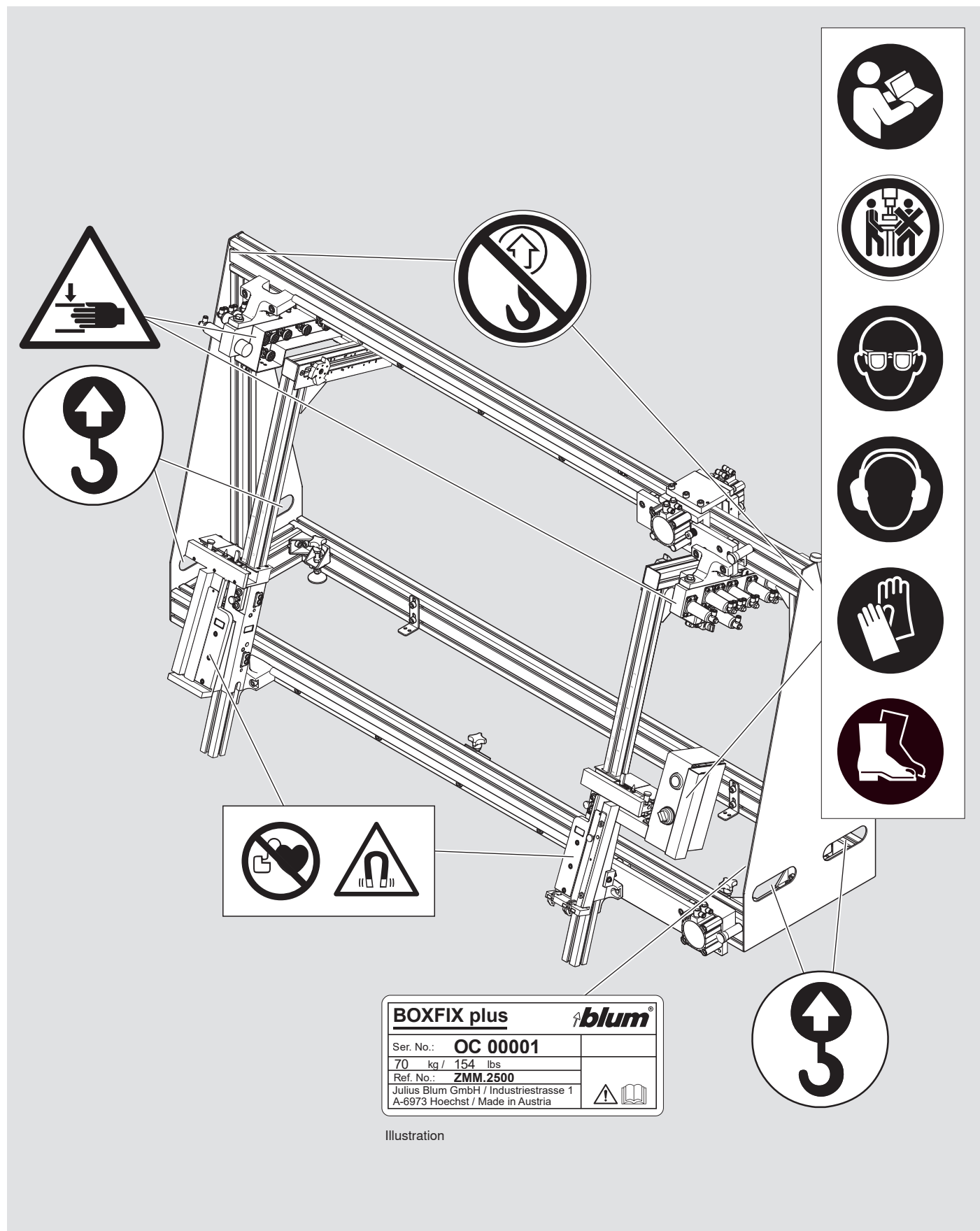

Connecting the pressurised air network

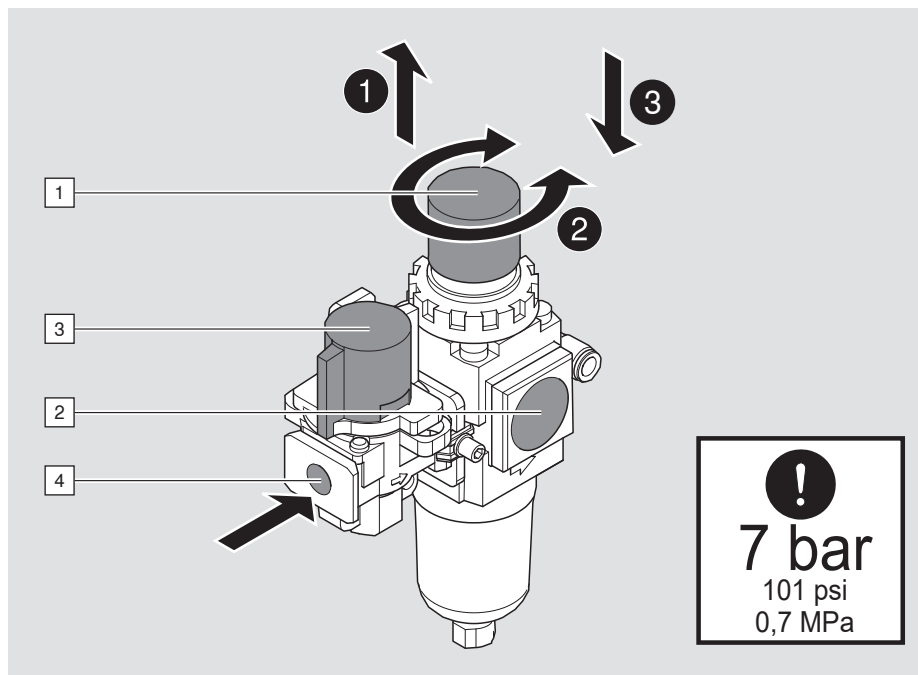

i NOTE

- Only oil-free pressurised air may be used.
- Connect the air supply [4] to the air filter unit.
- Open the compressed air shut-off valve [3].
- The pressure indicated on the pressure gauge [2] must show 7 bar / 101 psi / 0.7 MPa.
- The pressure can be set using the revolving handle [1].

Air consumption per work cycle is 2 litres.

Operating elements

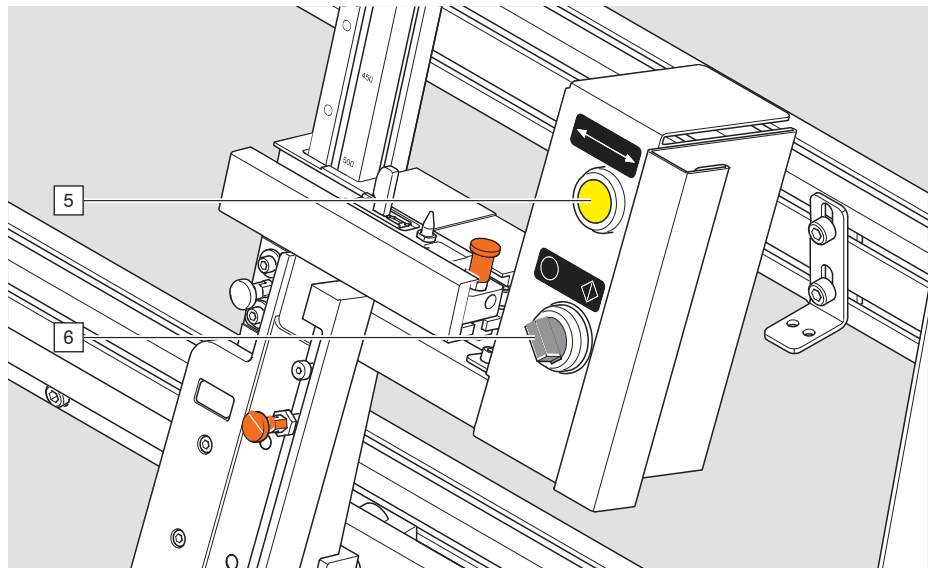

- 5 "Loosen clamp" button
- 6 "Joining" rotary switch

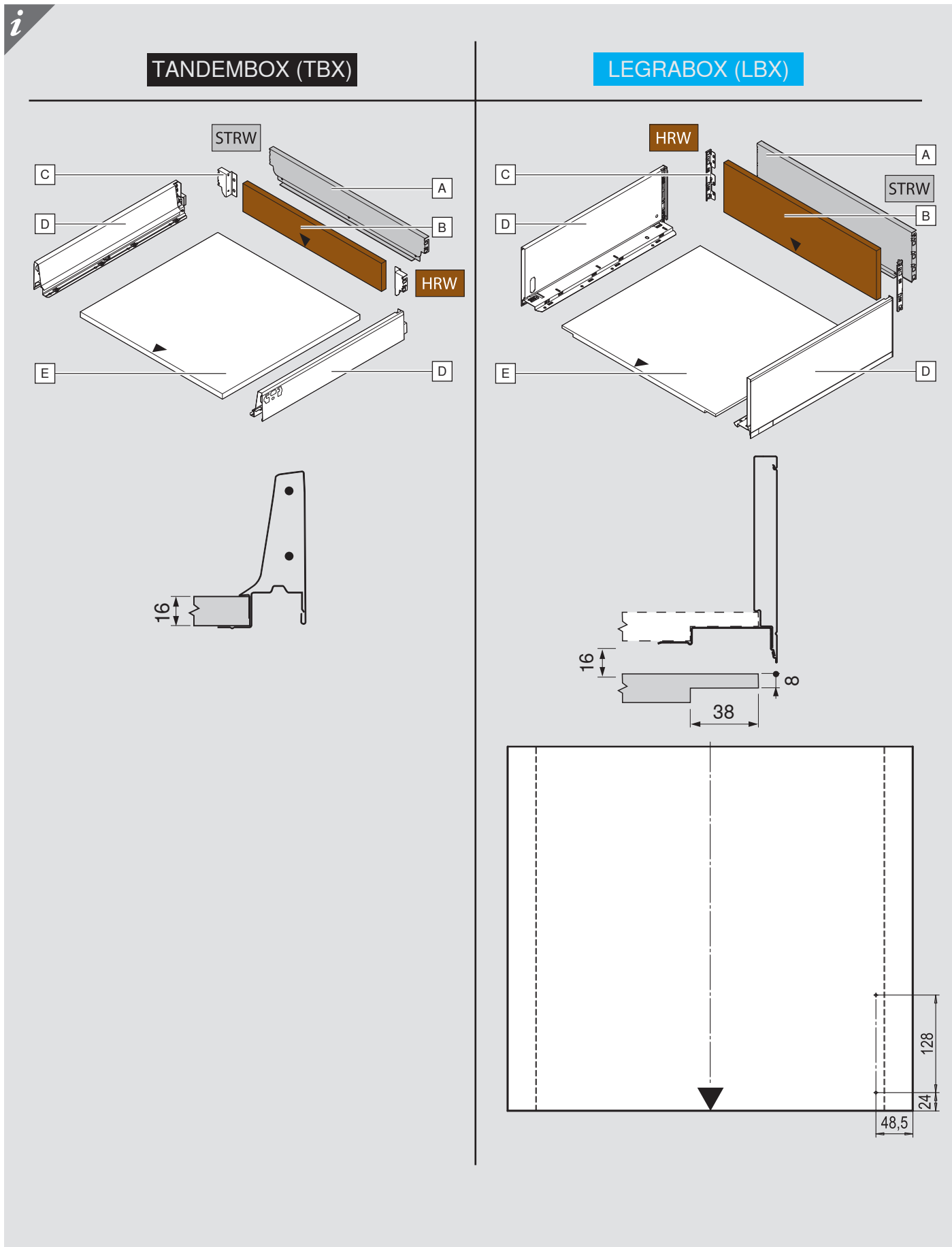

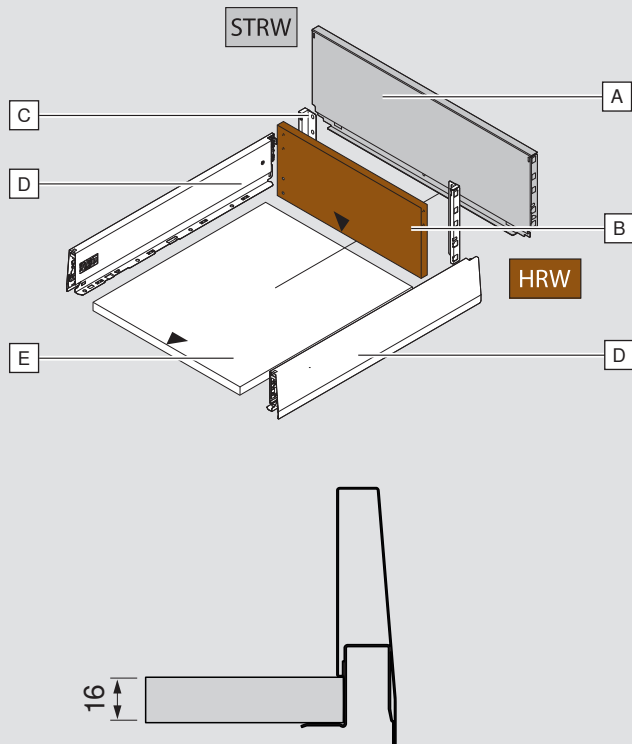
*i***MERIVOBOX (MVX)****STRW** Steel back**HRW** Chipboard back

- A** Steel back
- B** Chipboard back
- C** Back fixing
- D** Drawer side
- E** Base

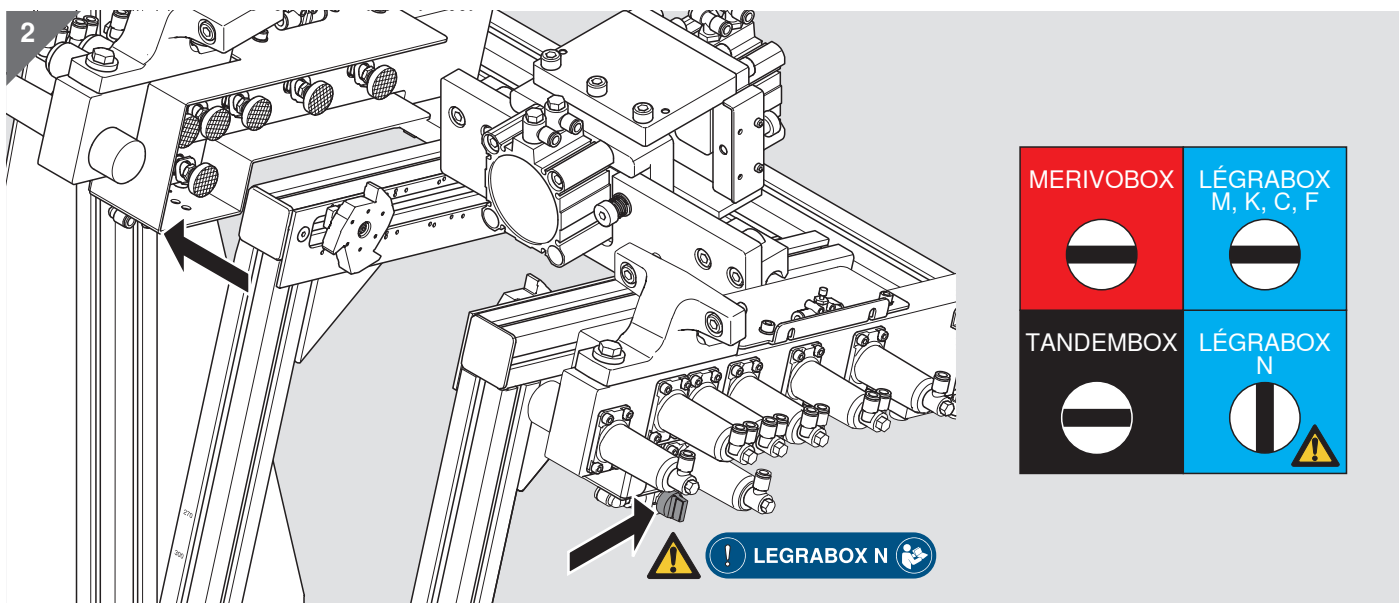
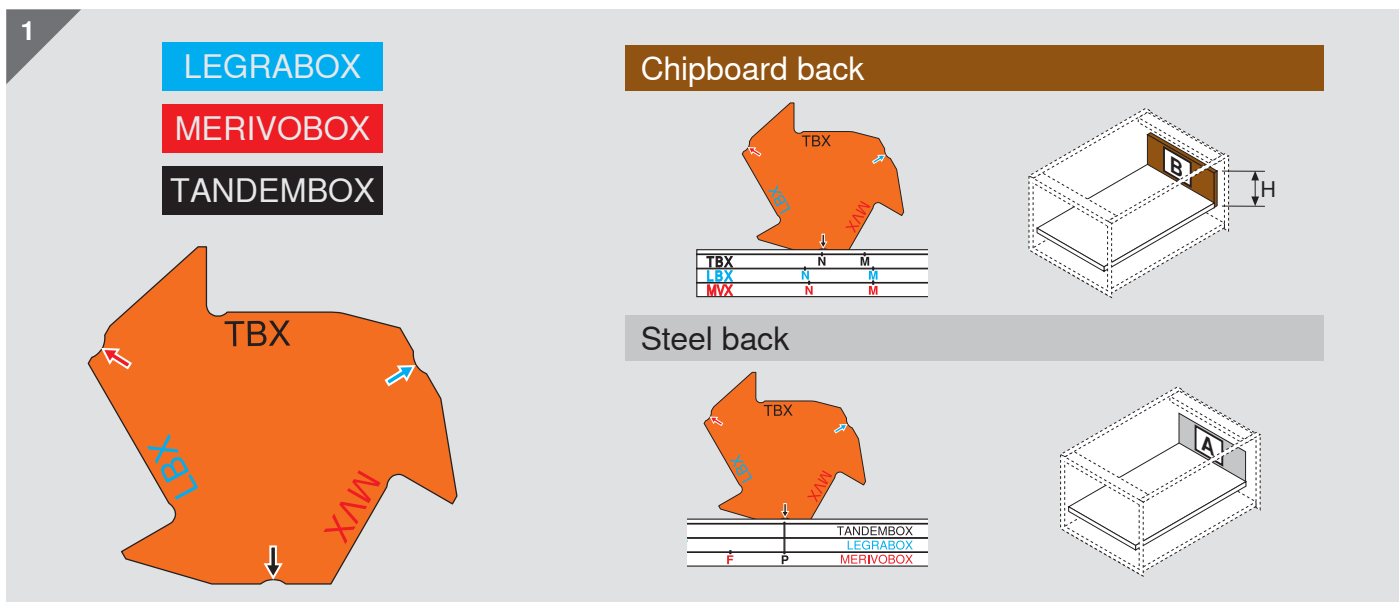
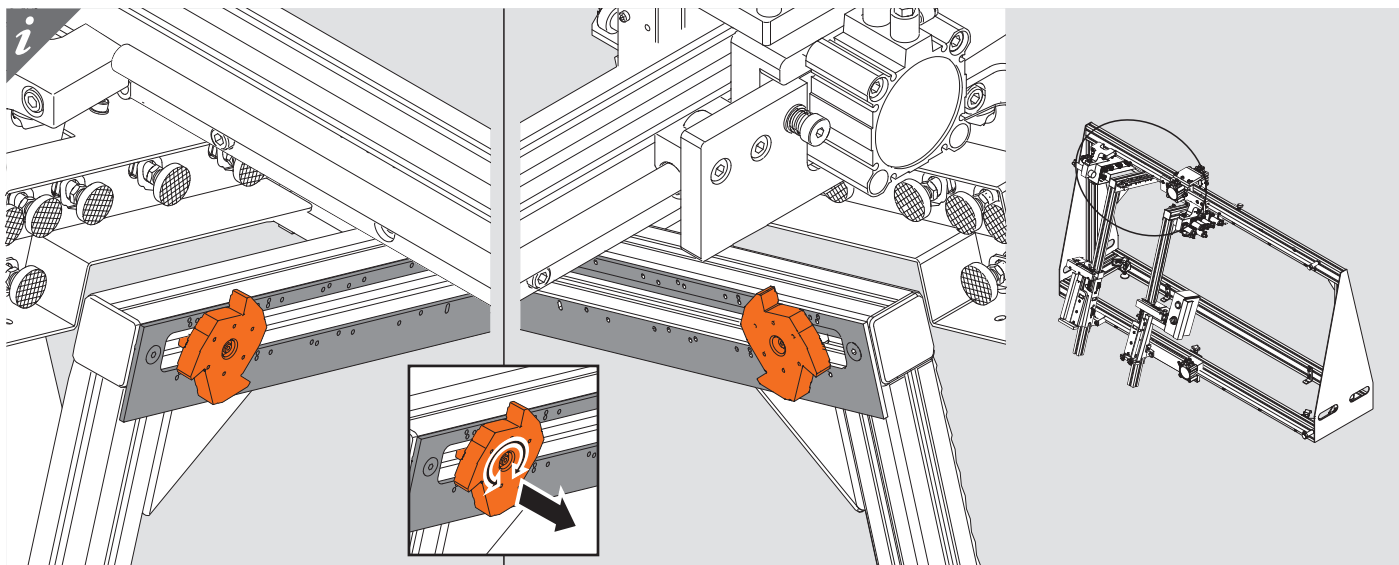

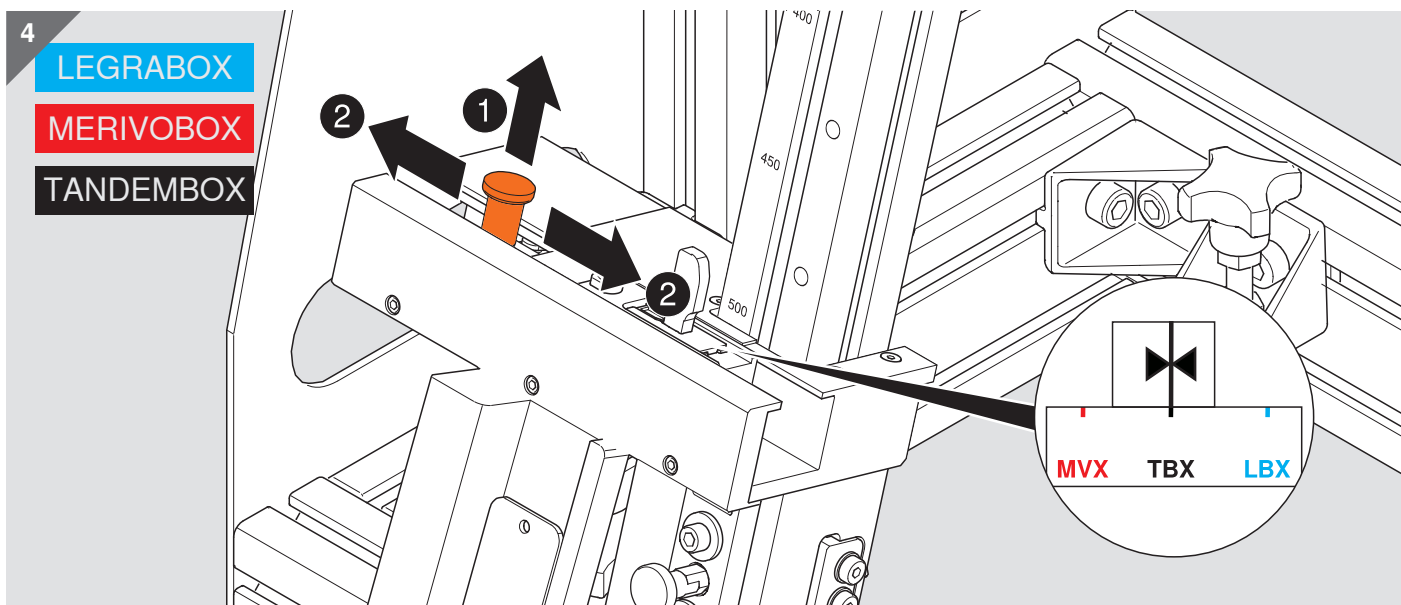
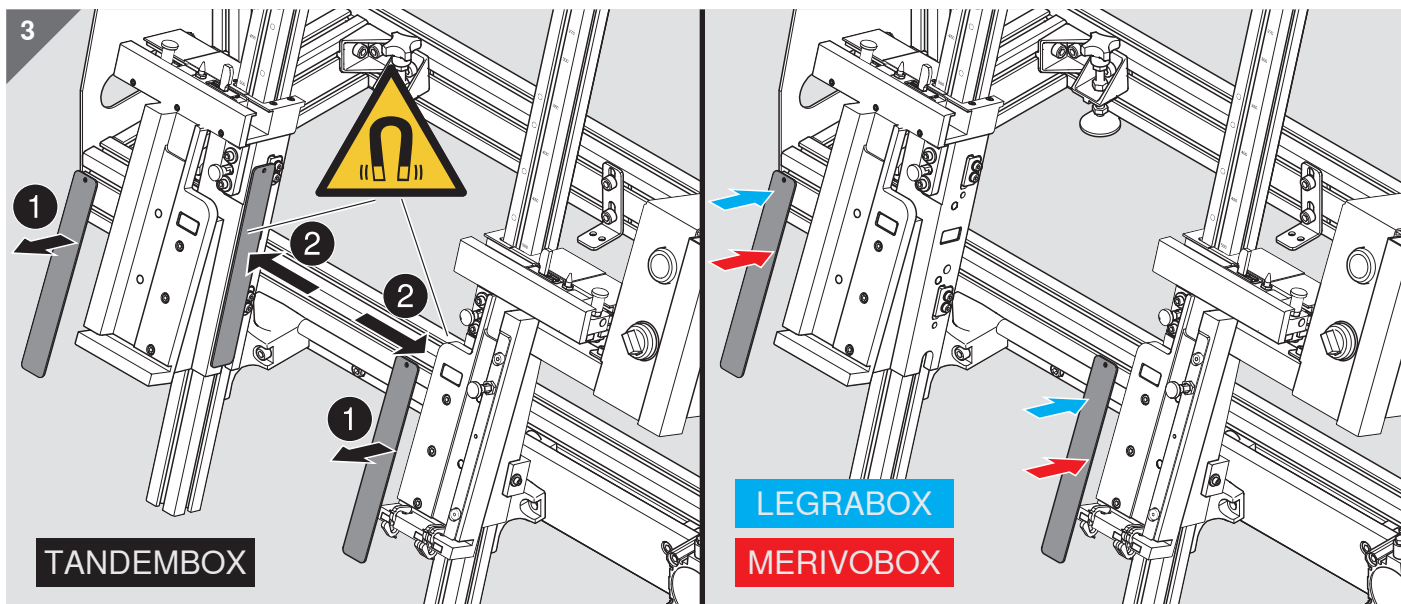
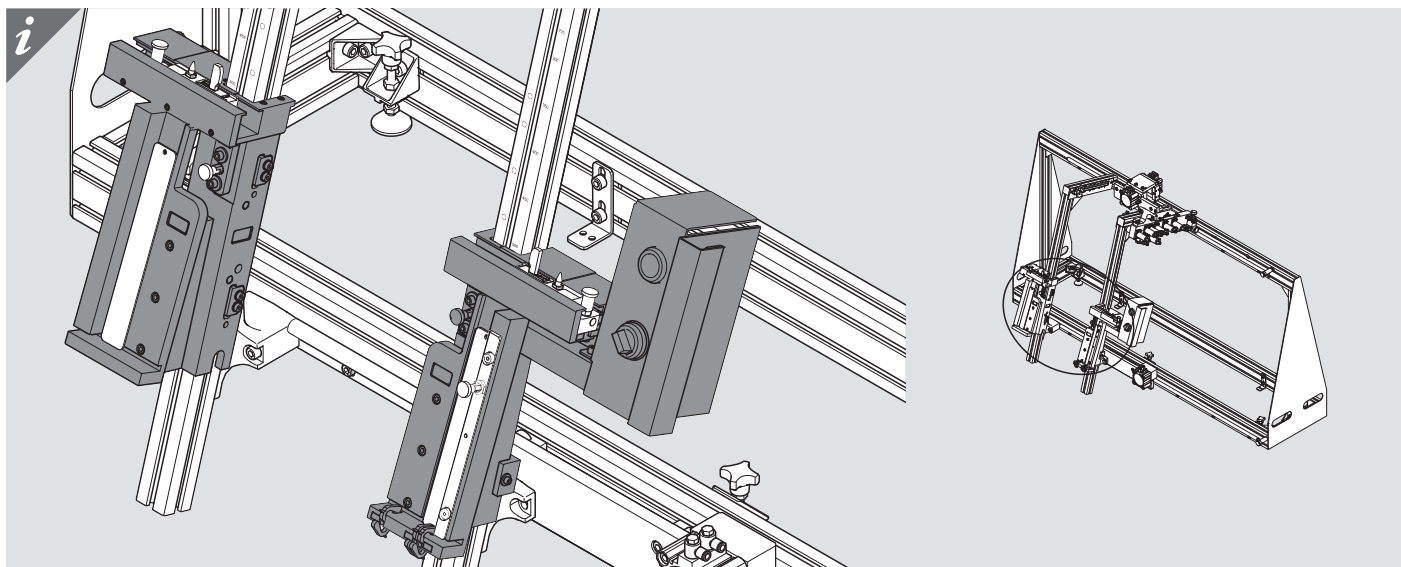

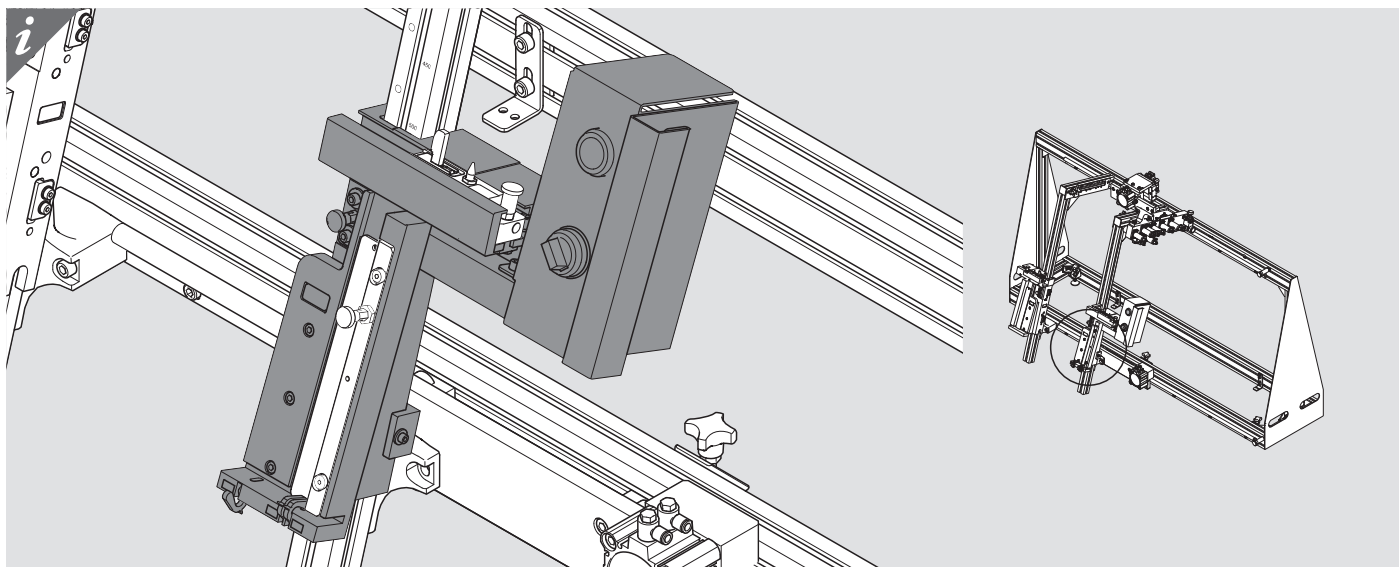

5

LEGRABOX

MERIVOBX

TANDEMBOX

Chipboard back

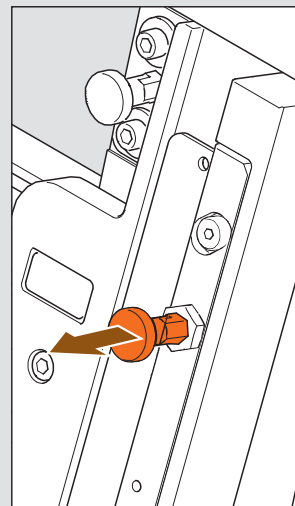
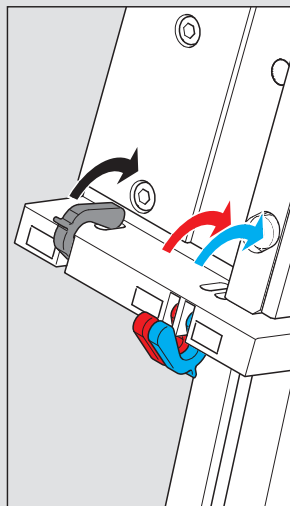

Steel back

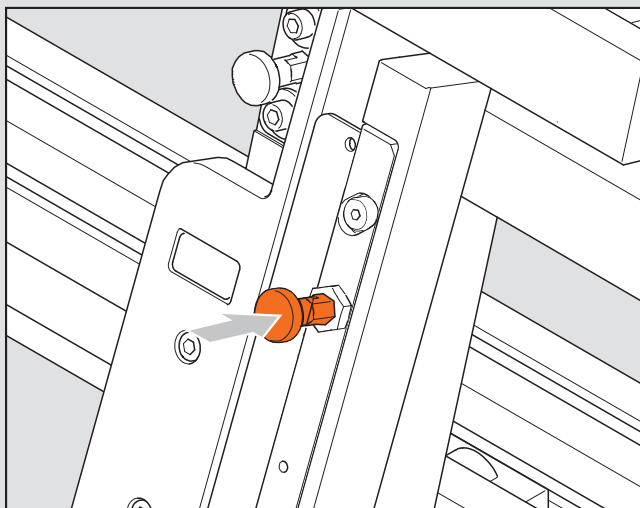

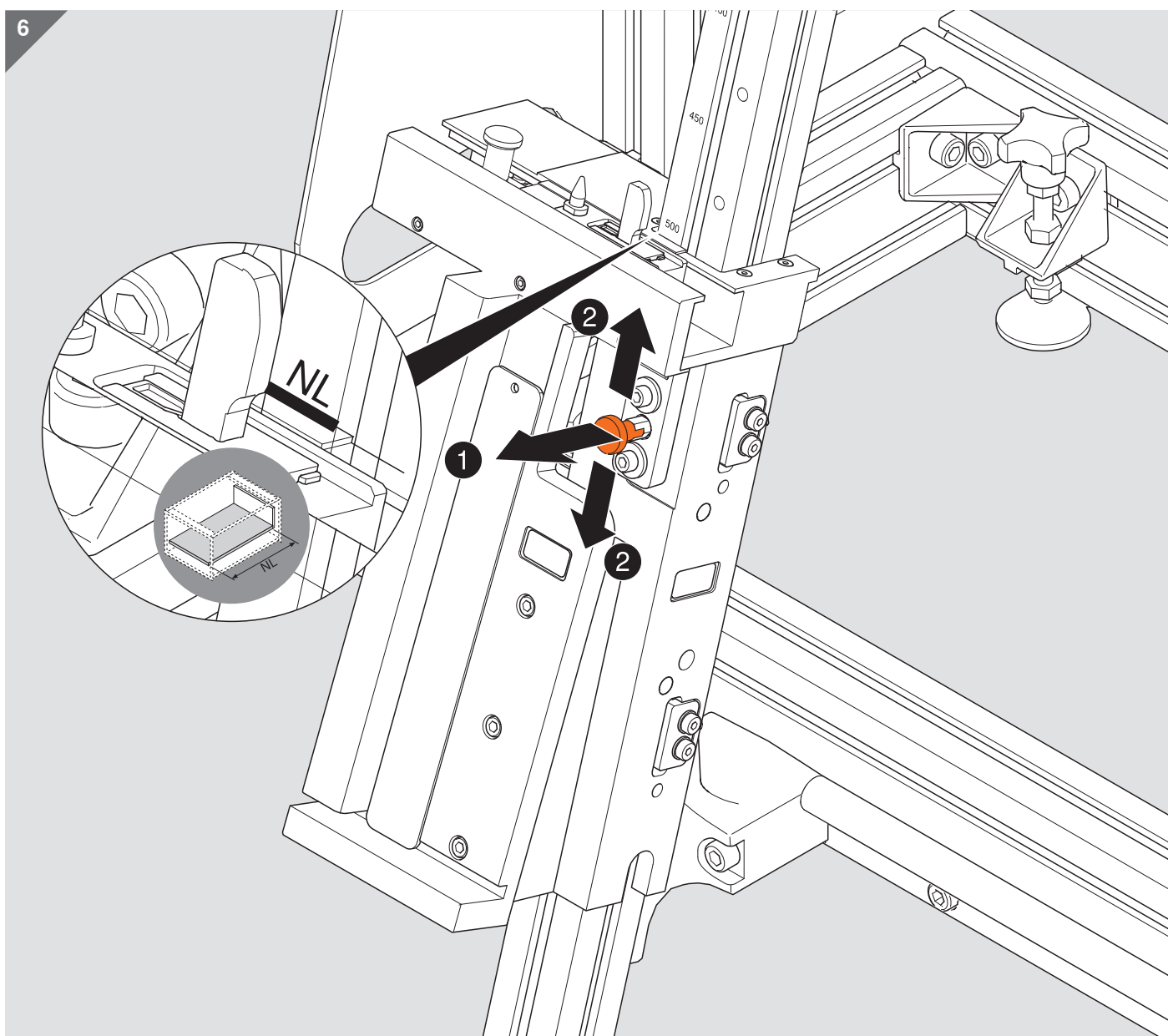
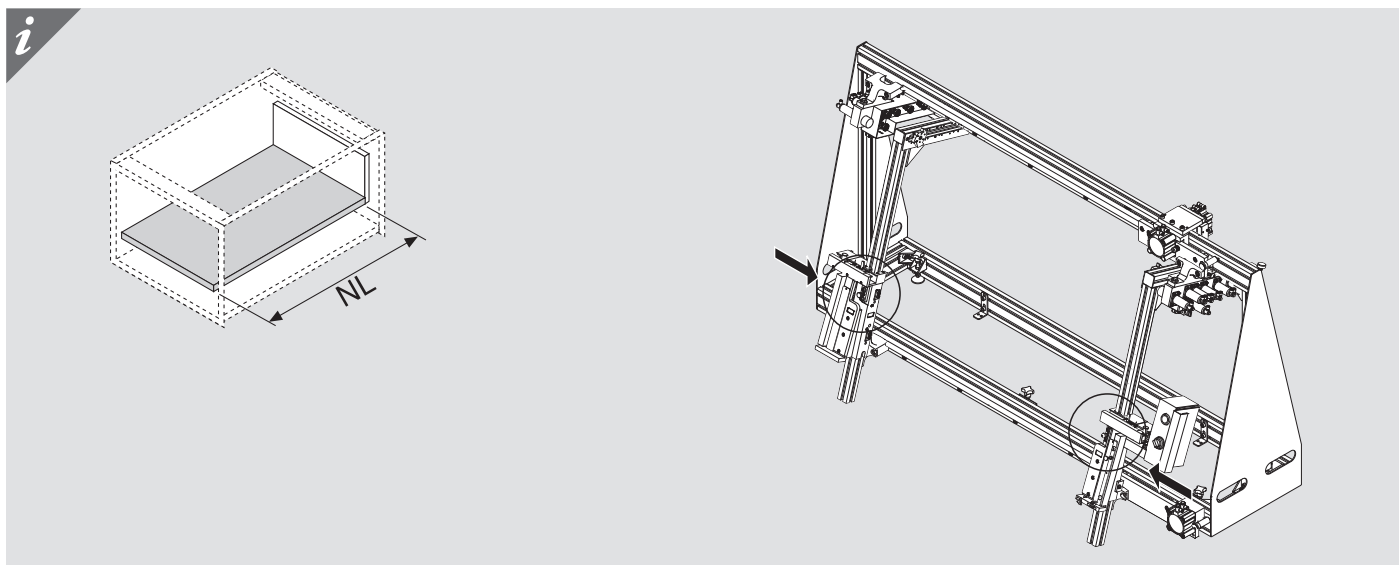

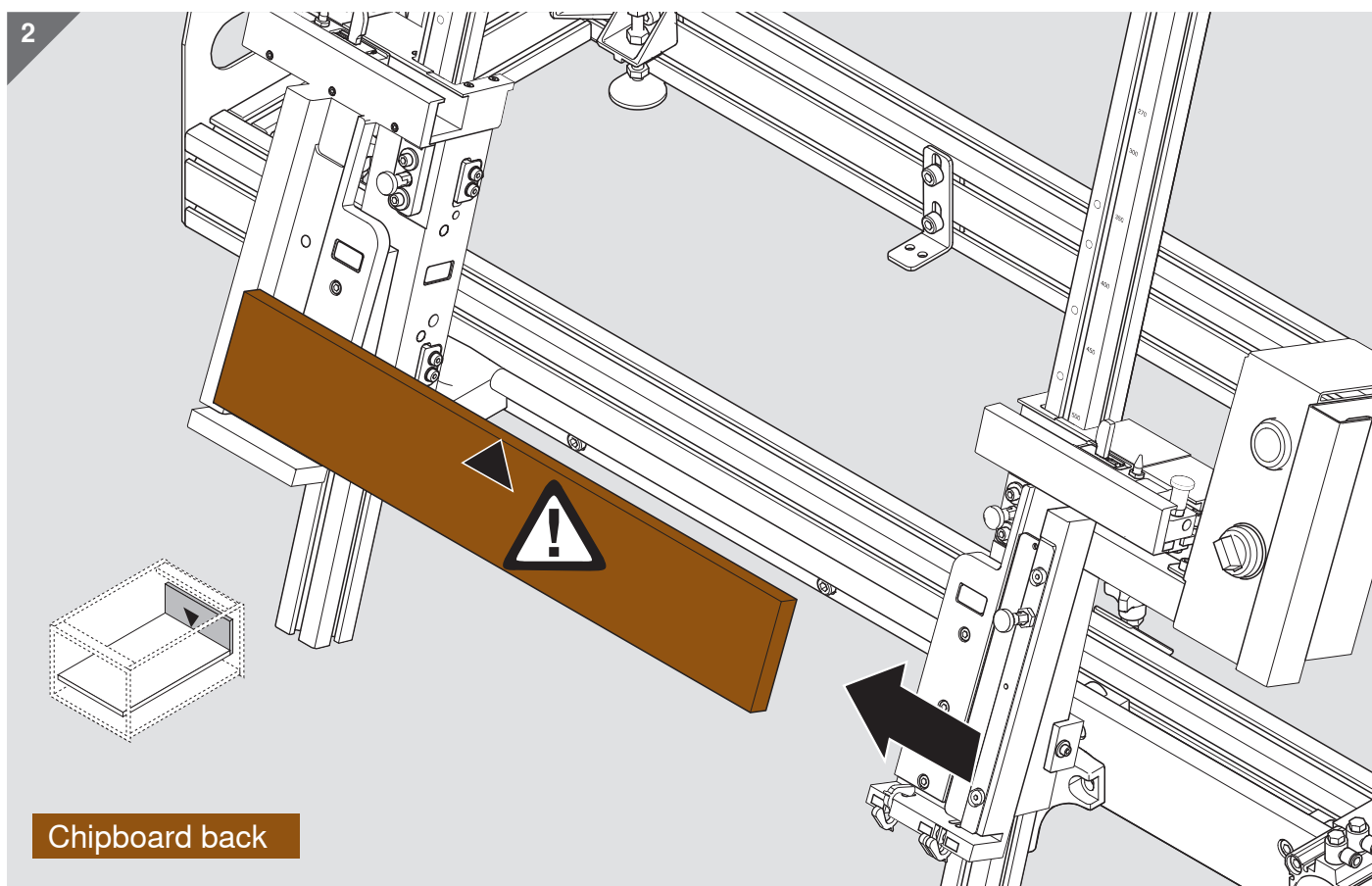
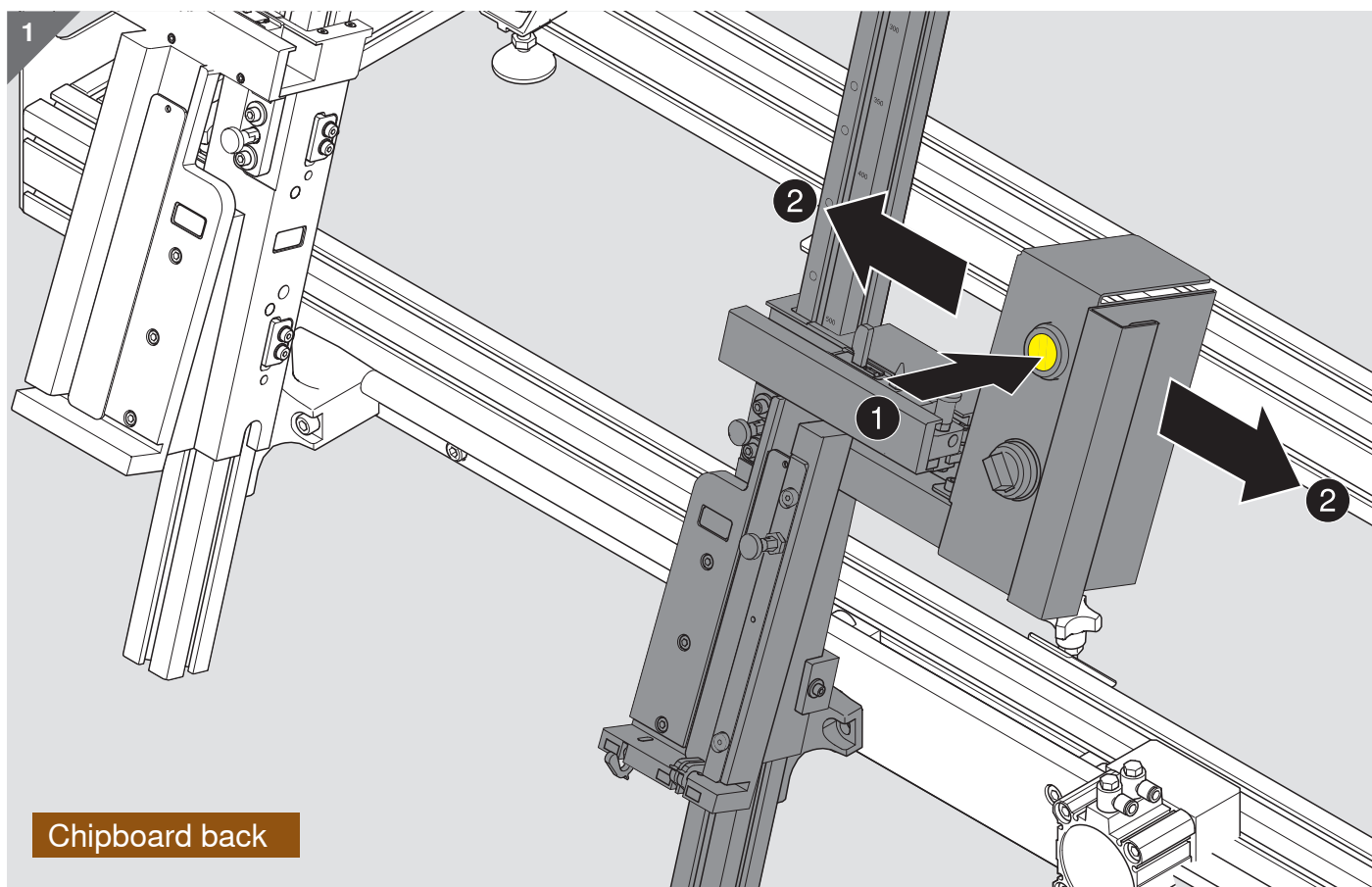

3

B

Chipboard back

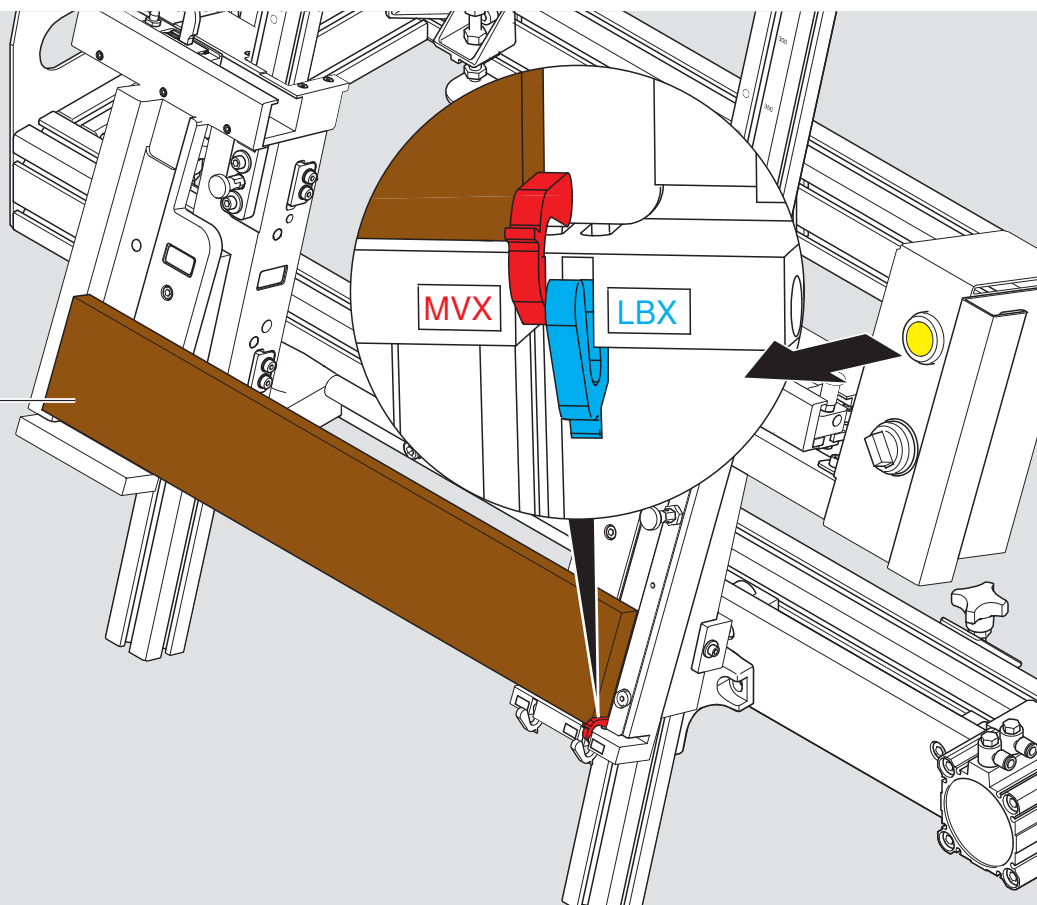

4

C

Chipboard back

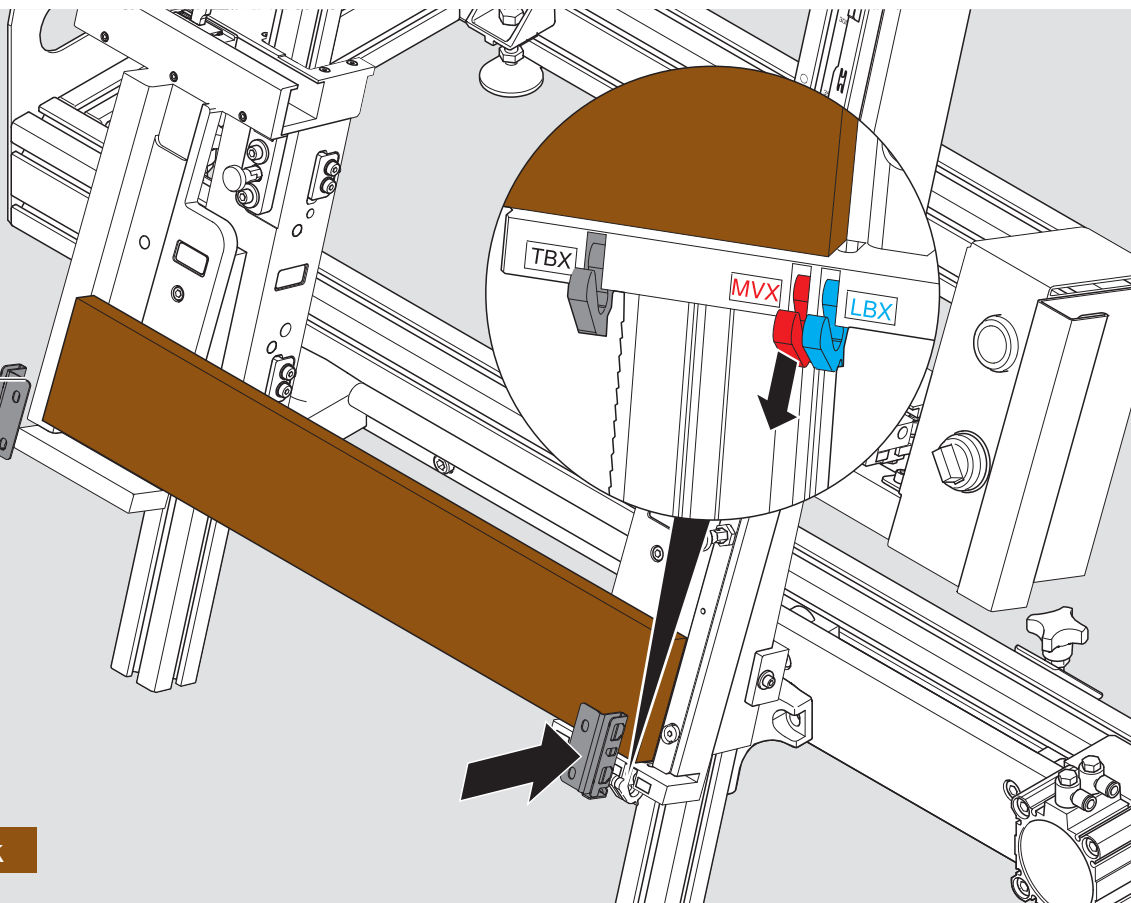

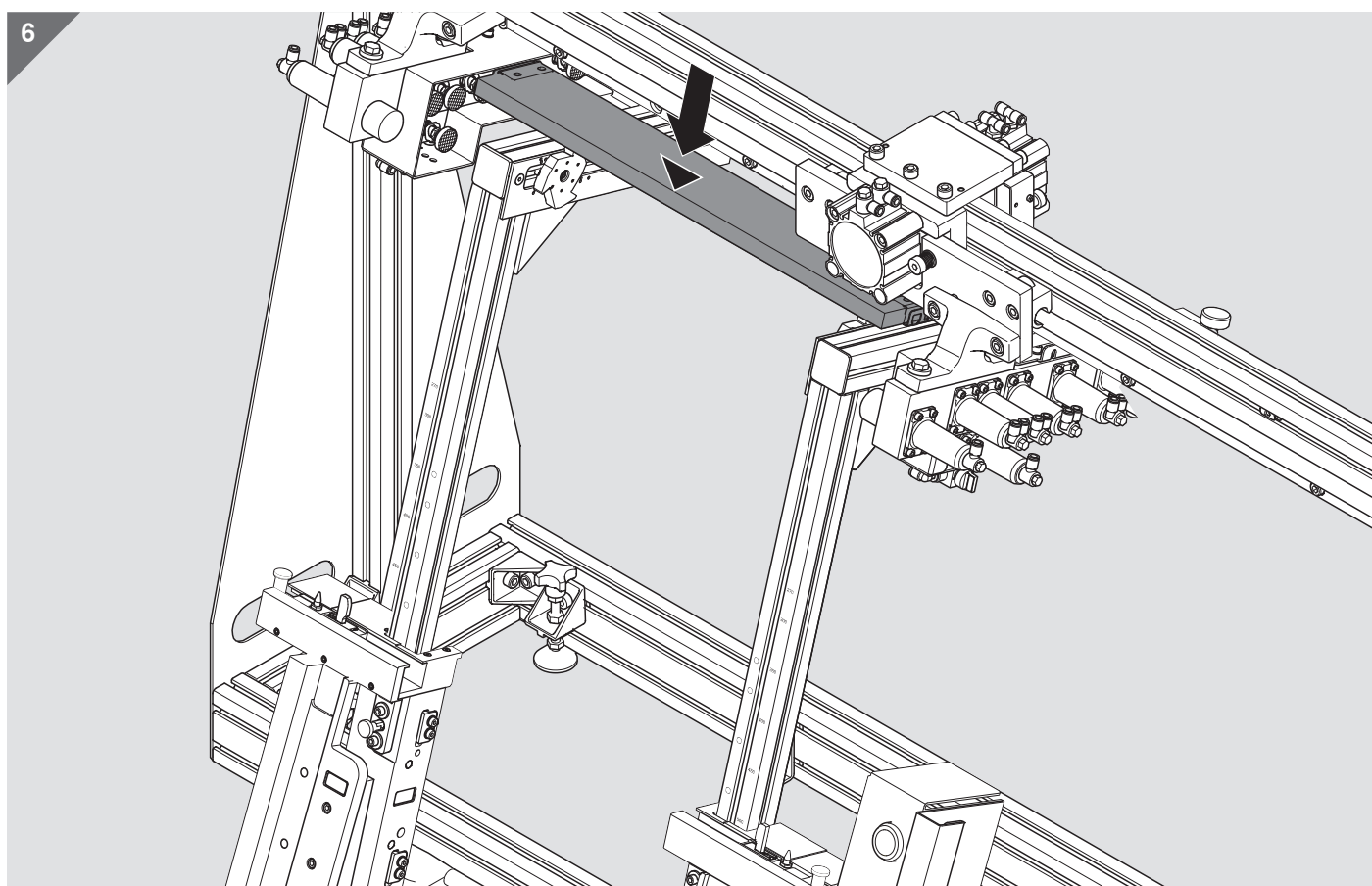
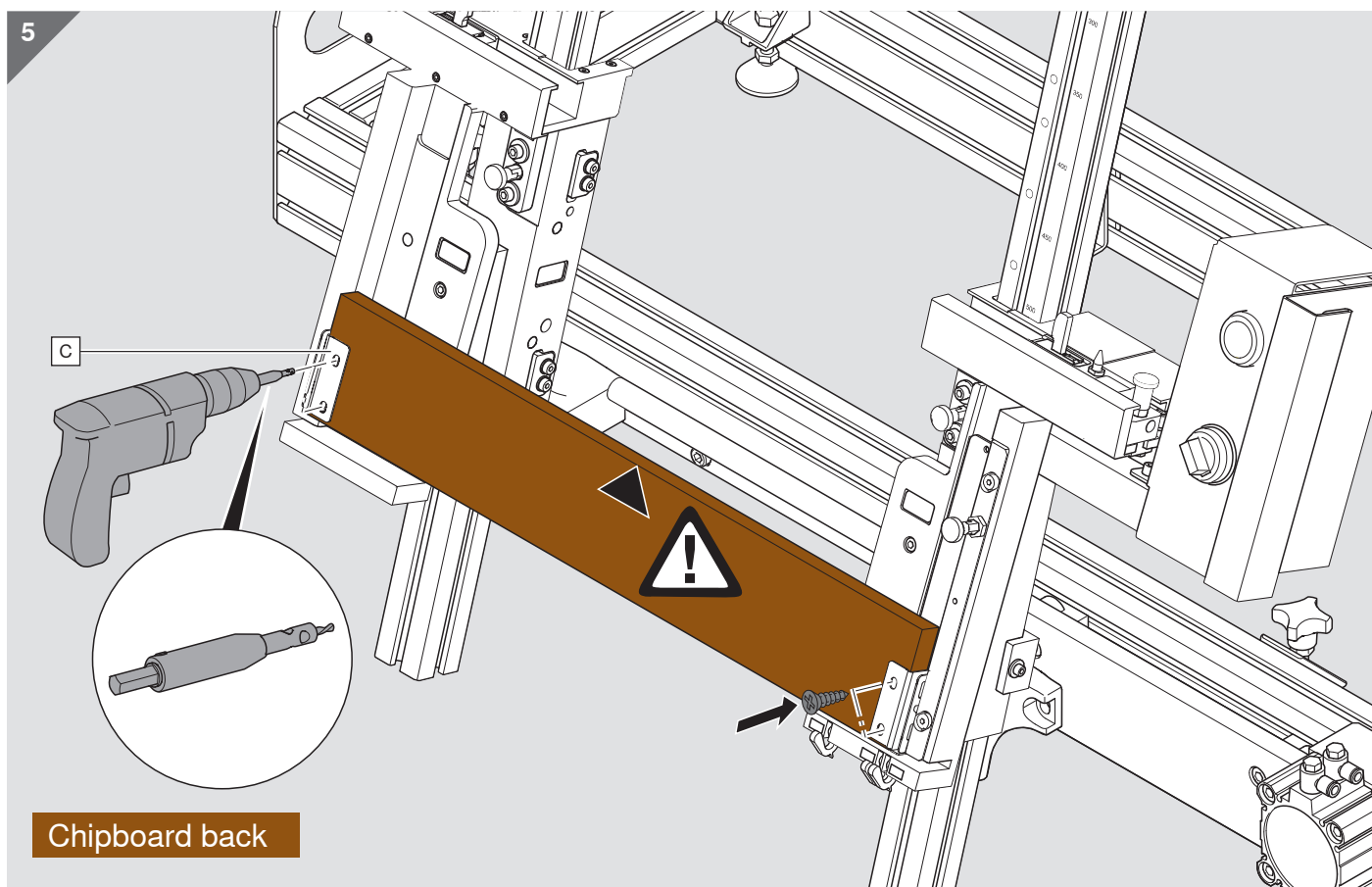

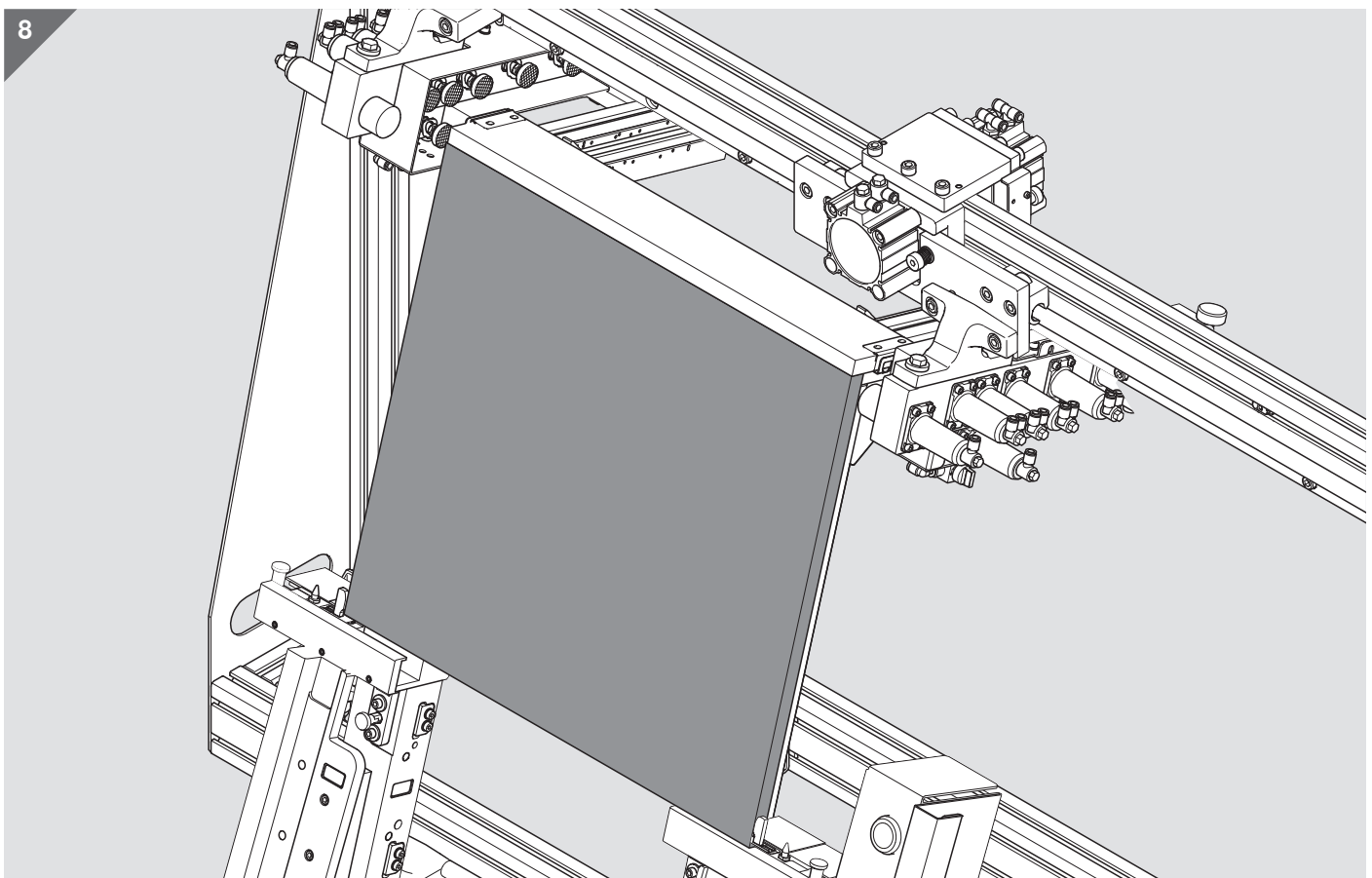
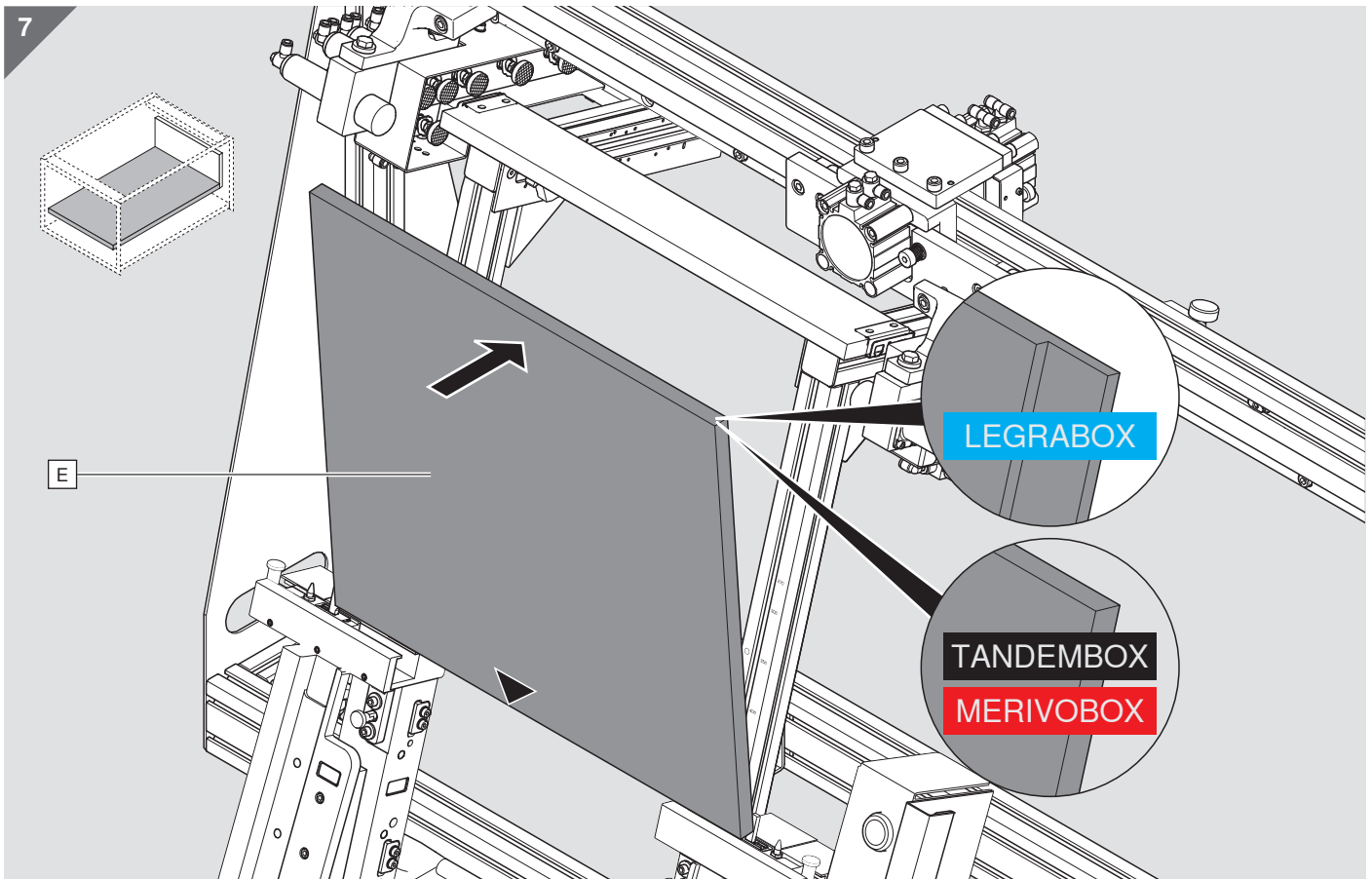

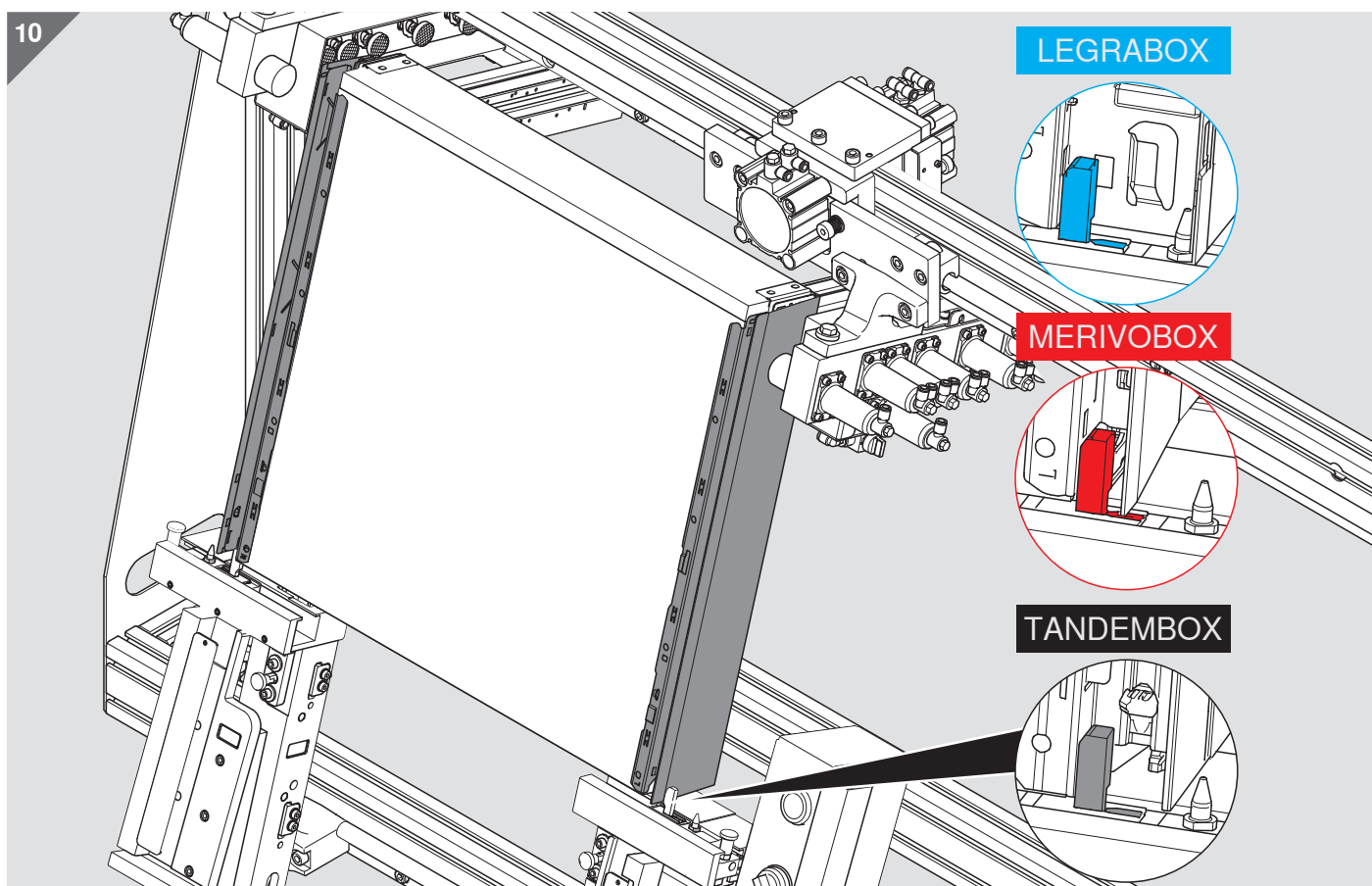
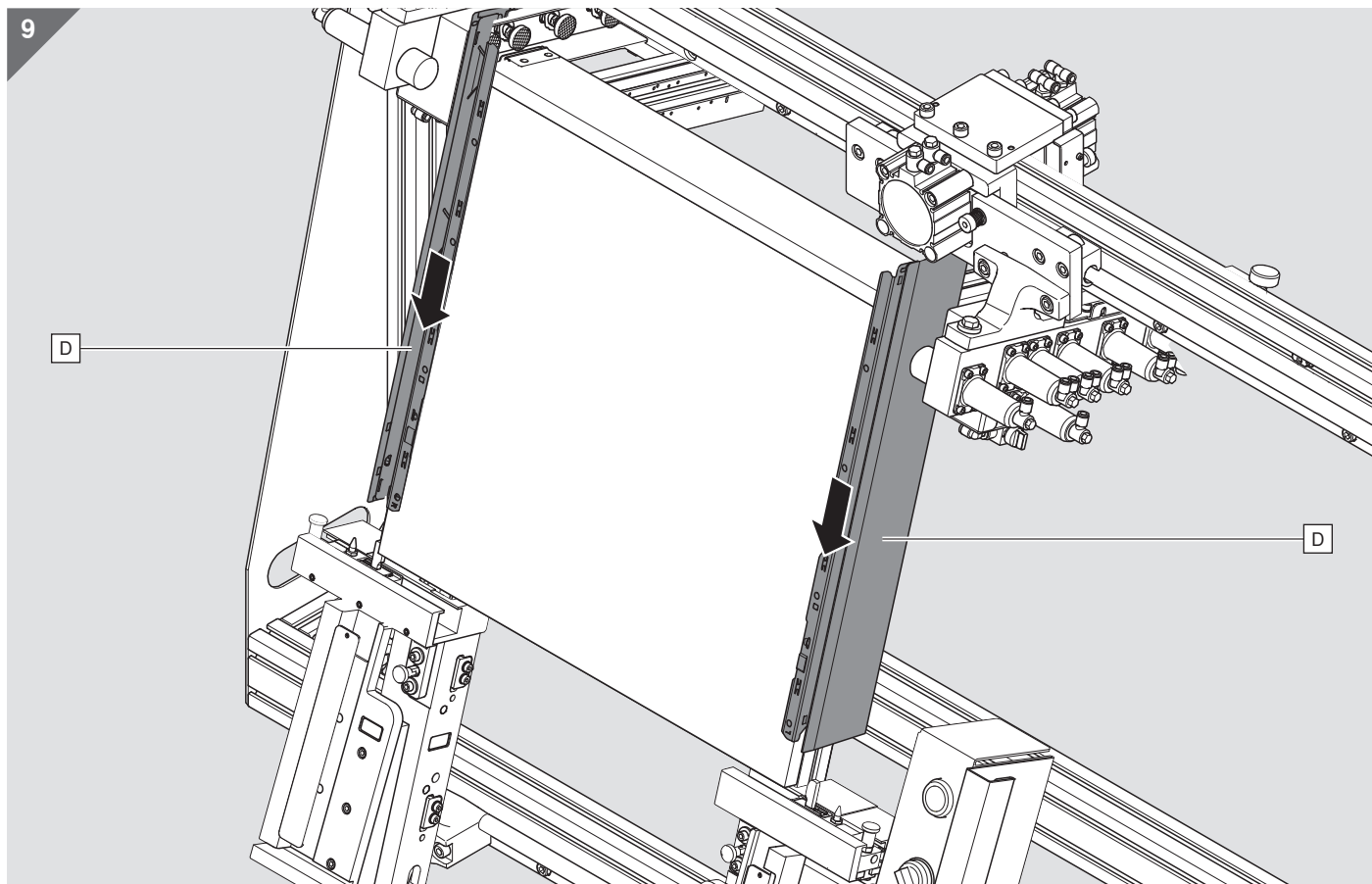

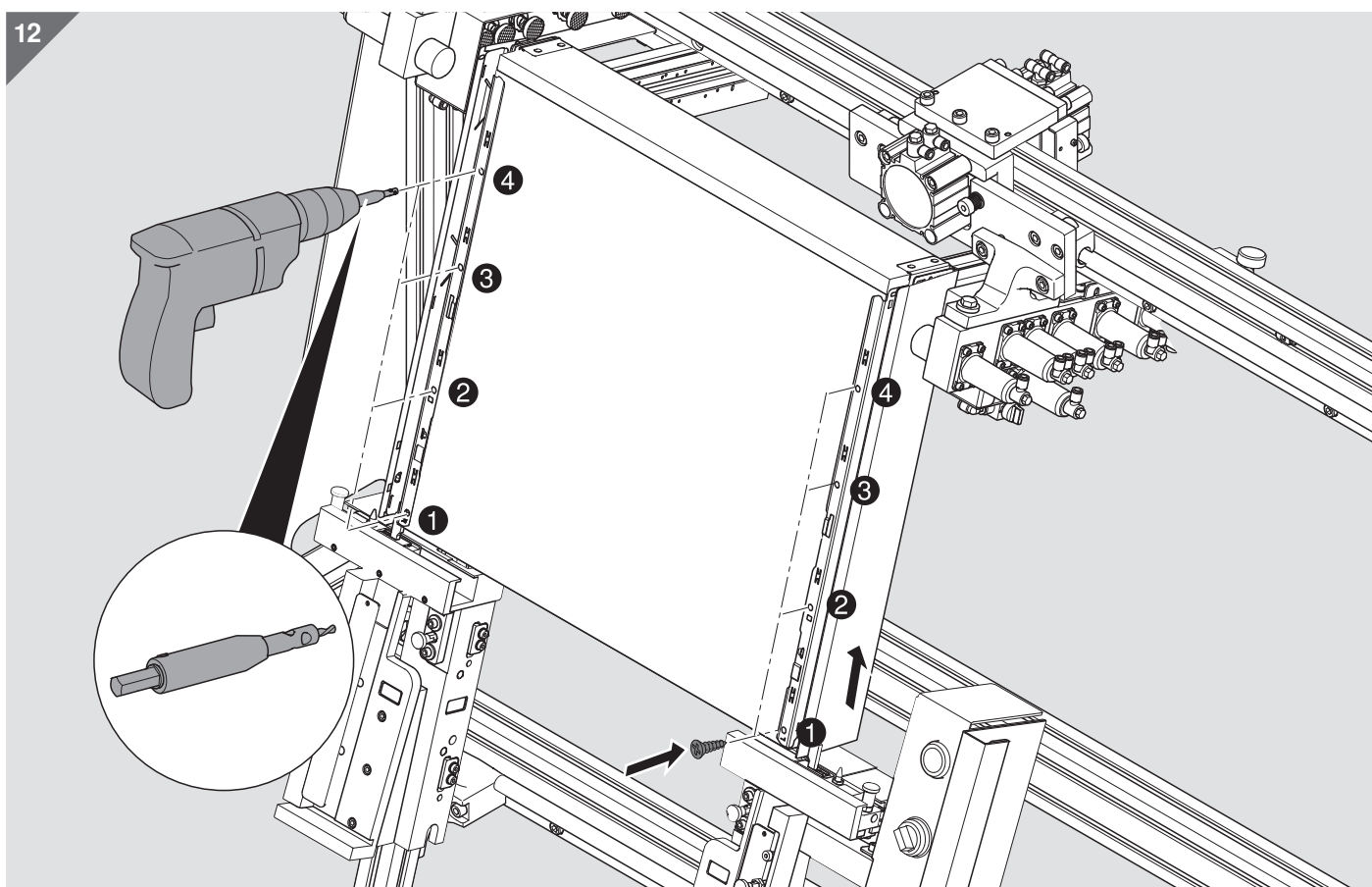
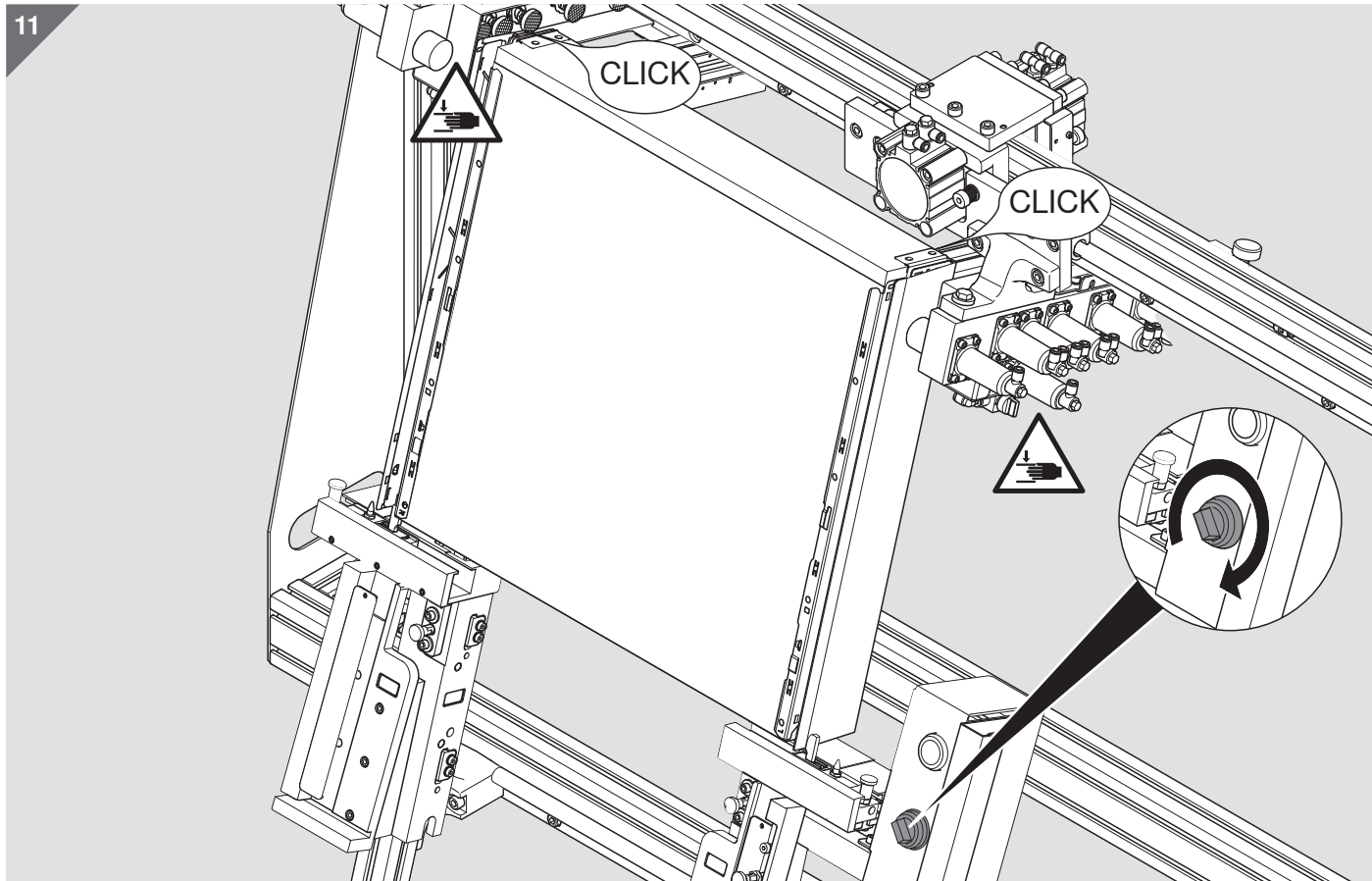

13

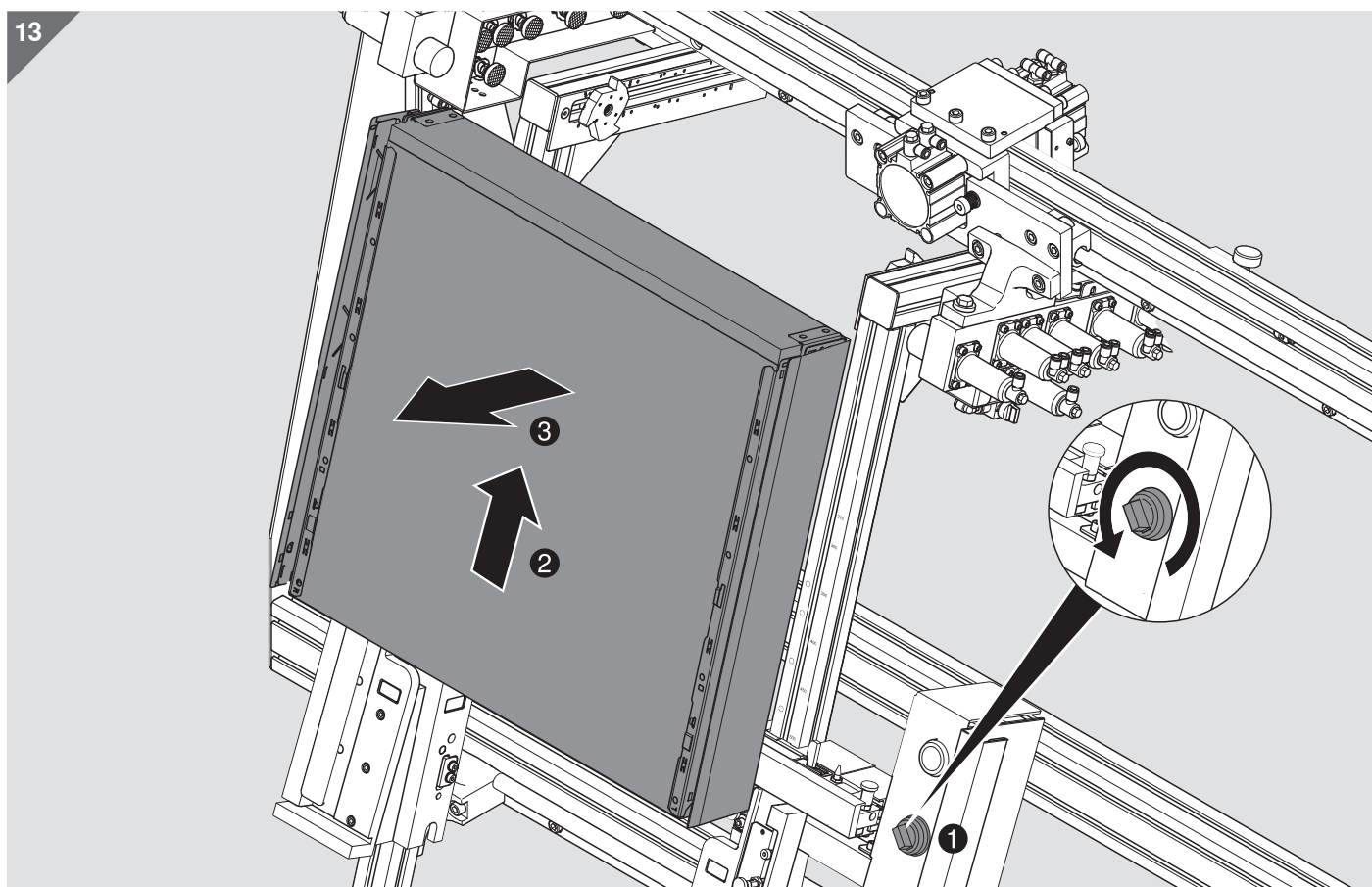

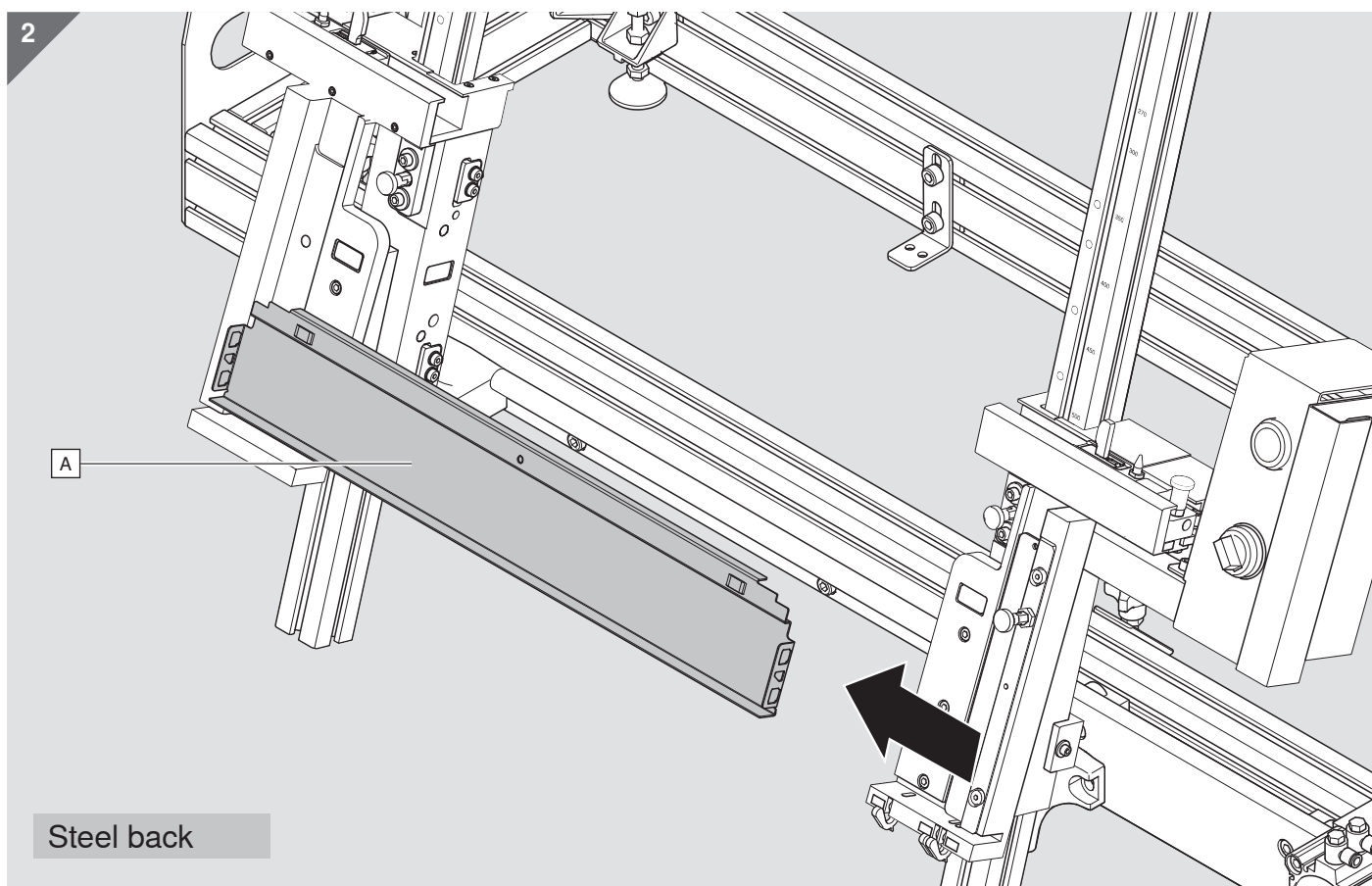
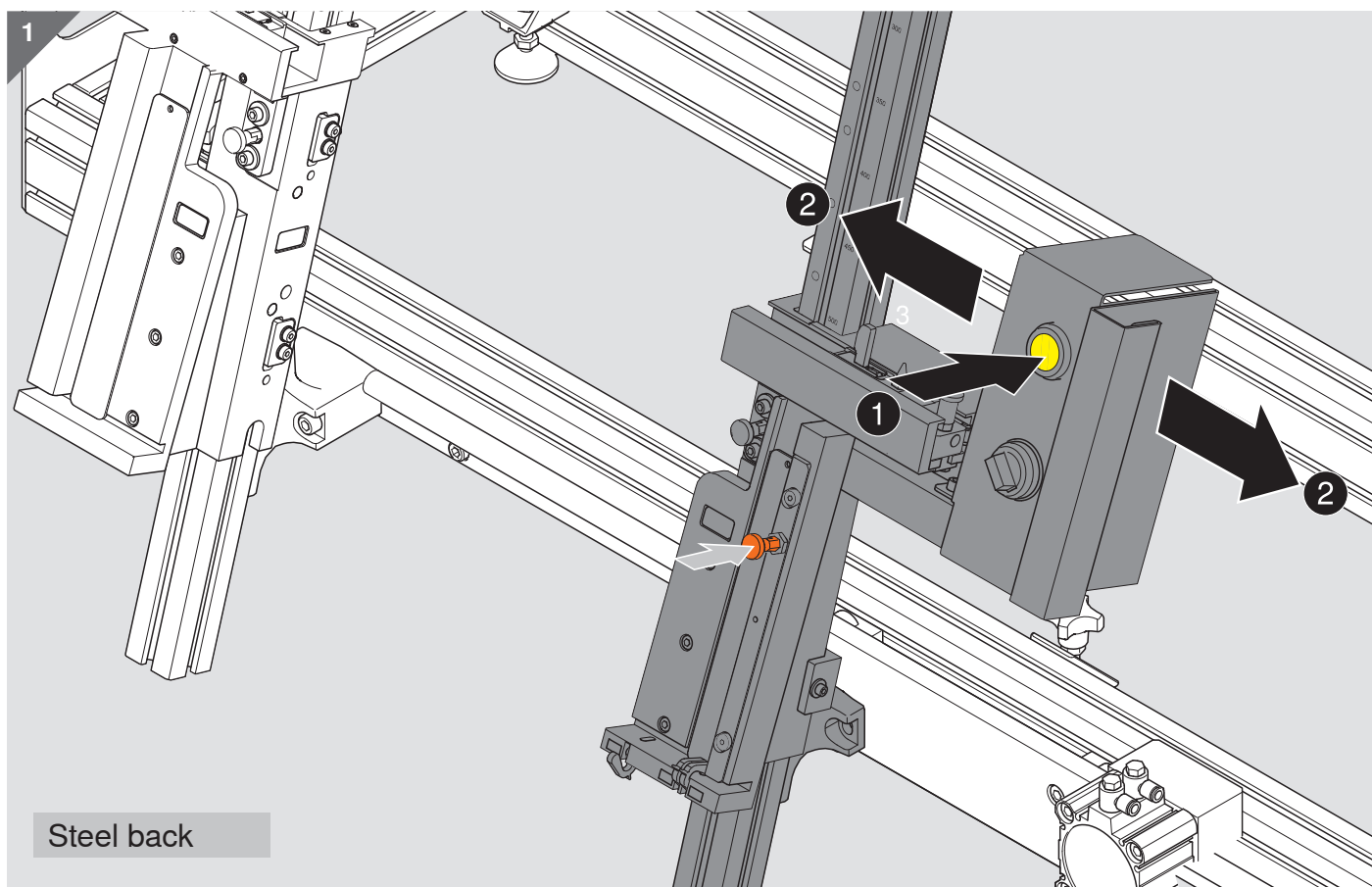

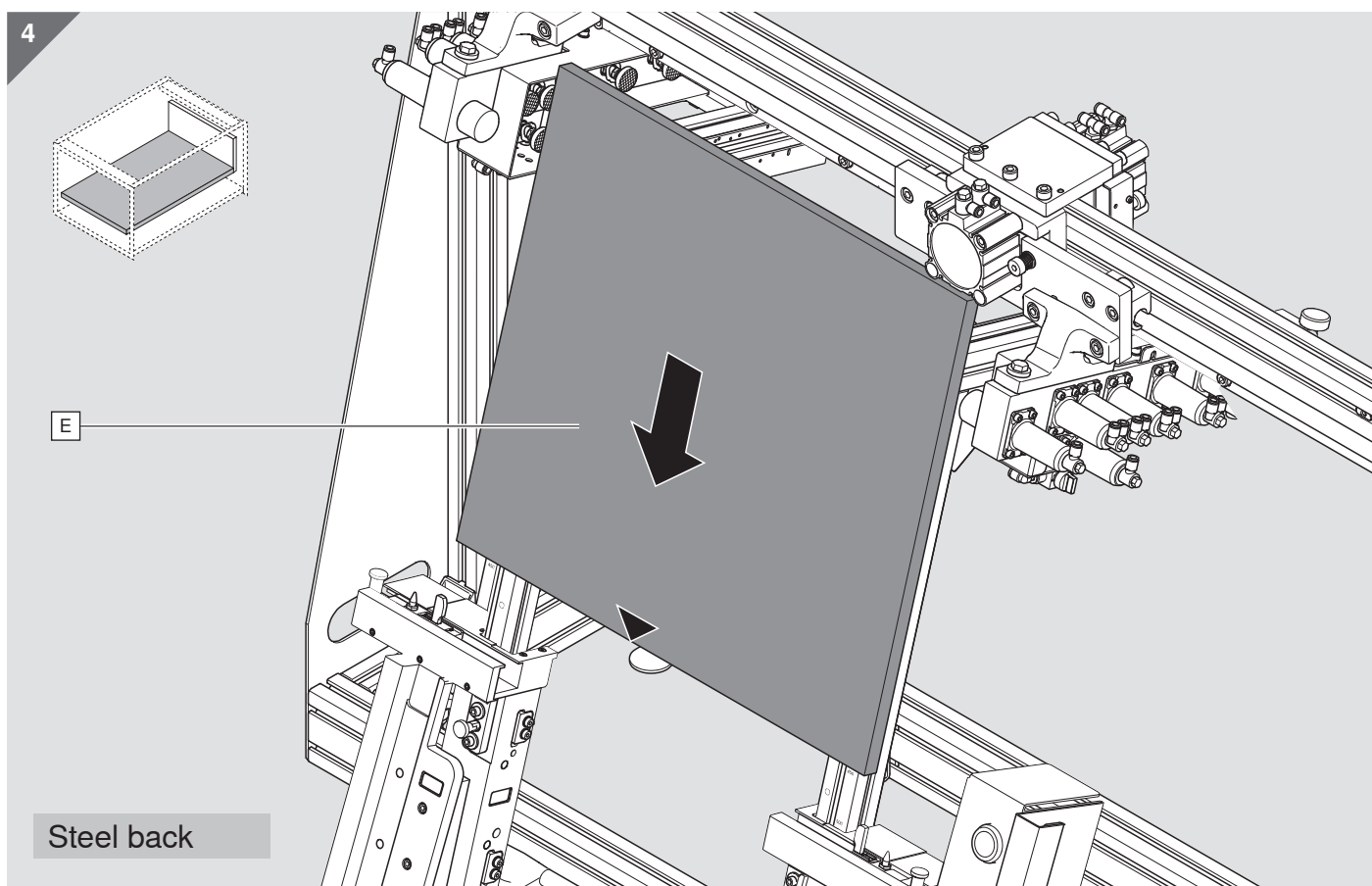
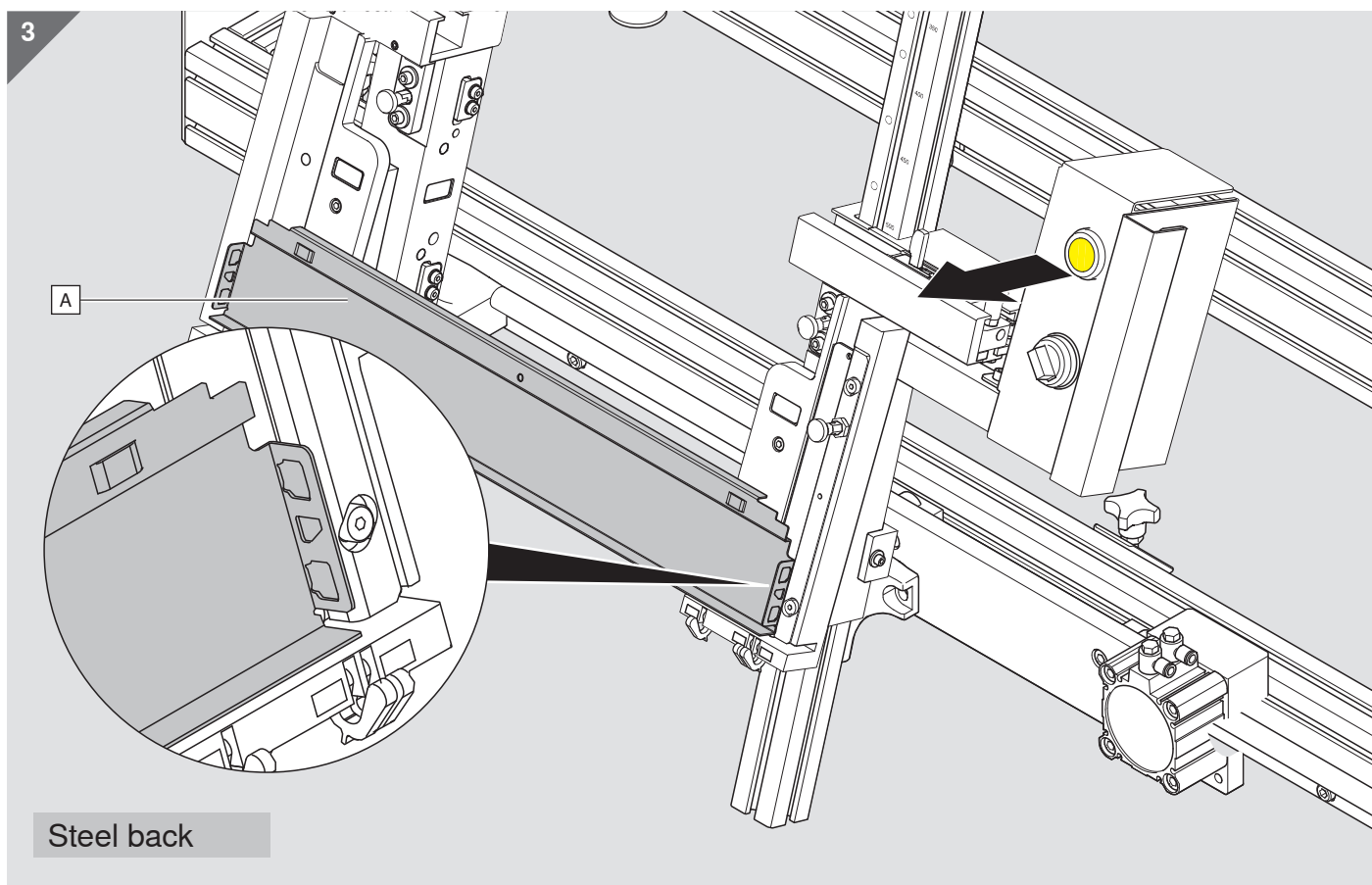

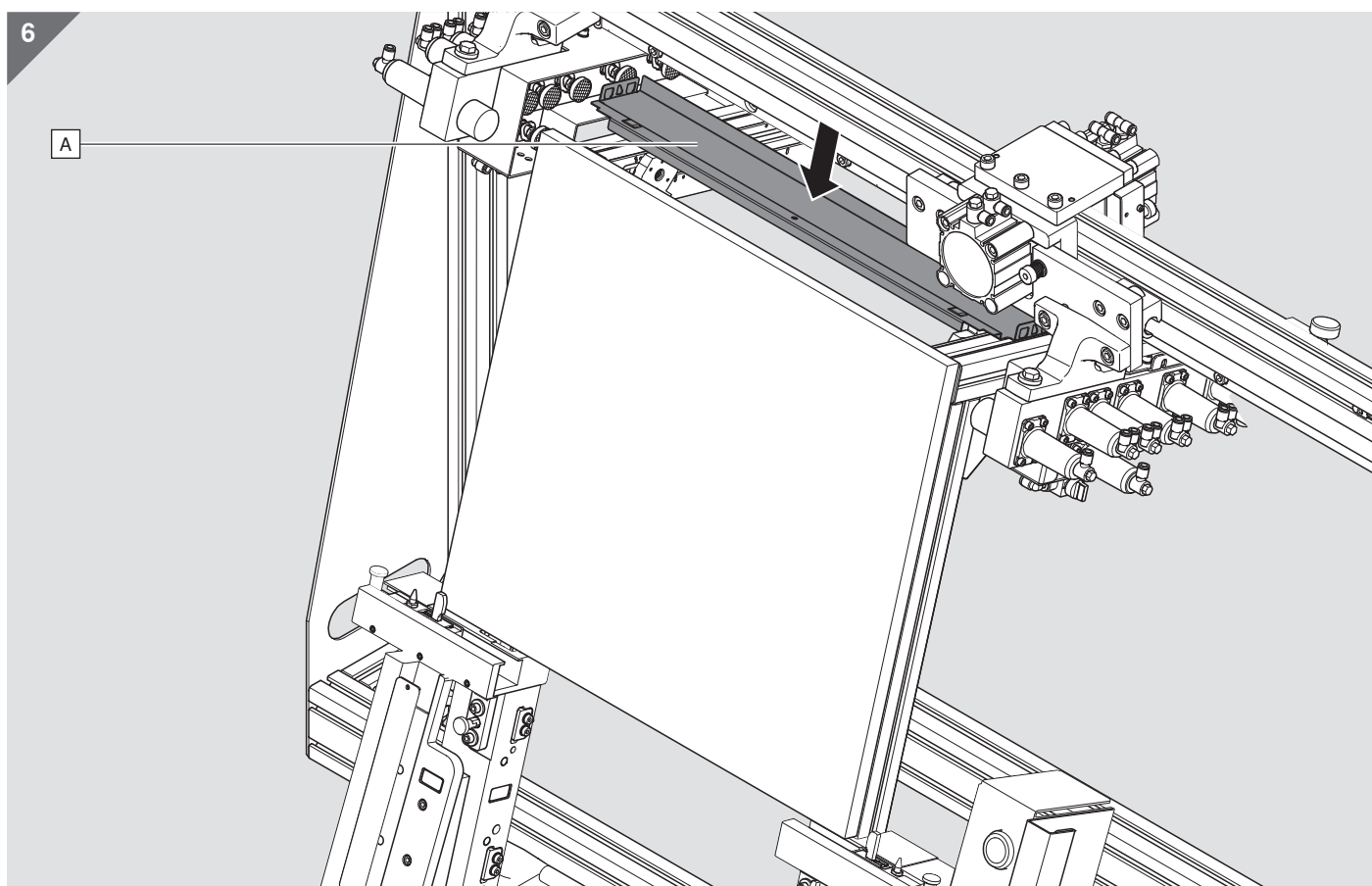
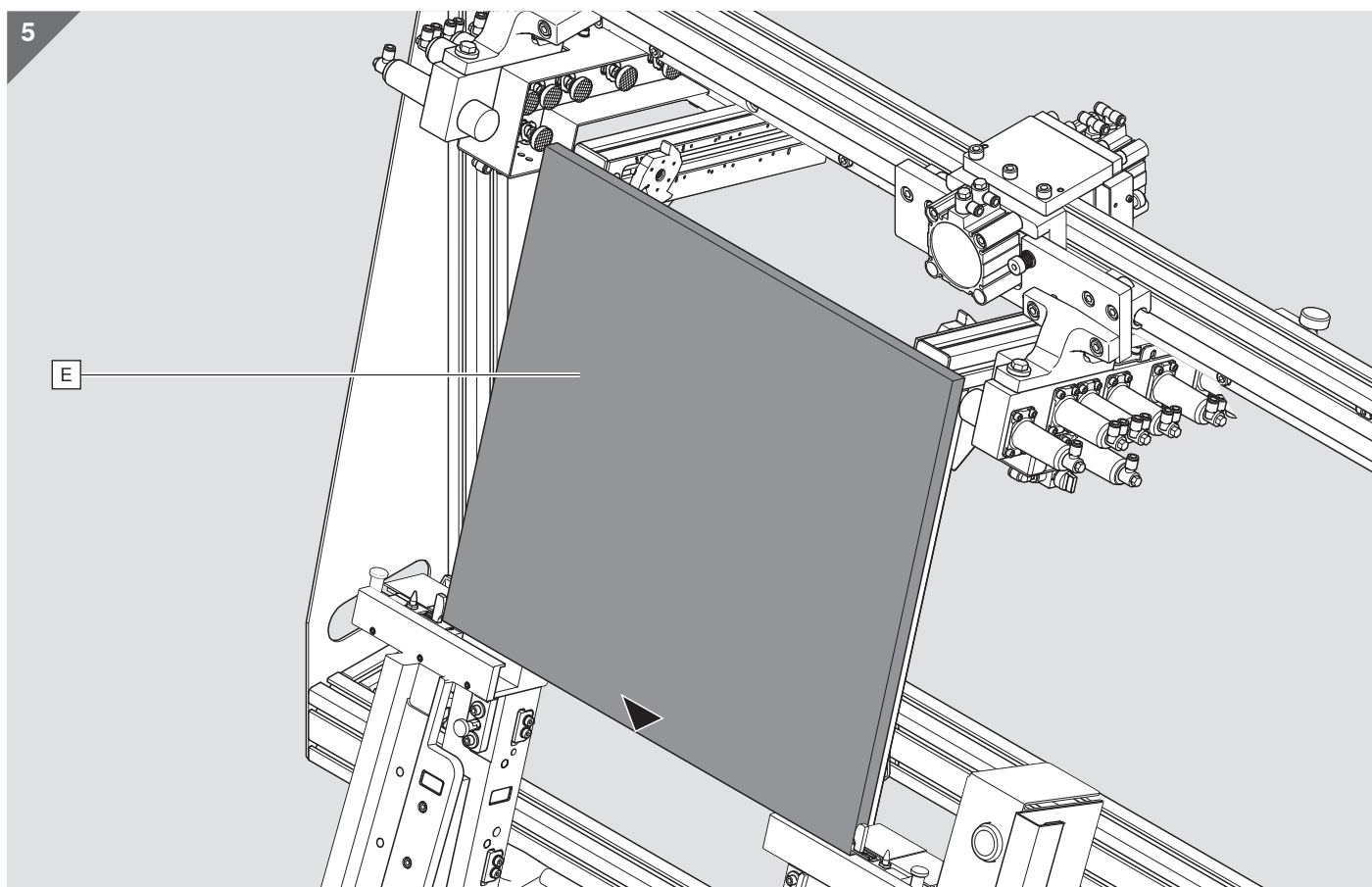

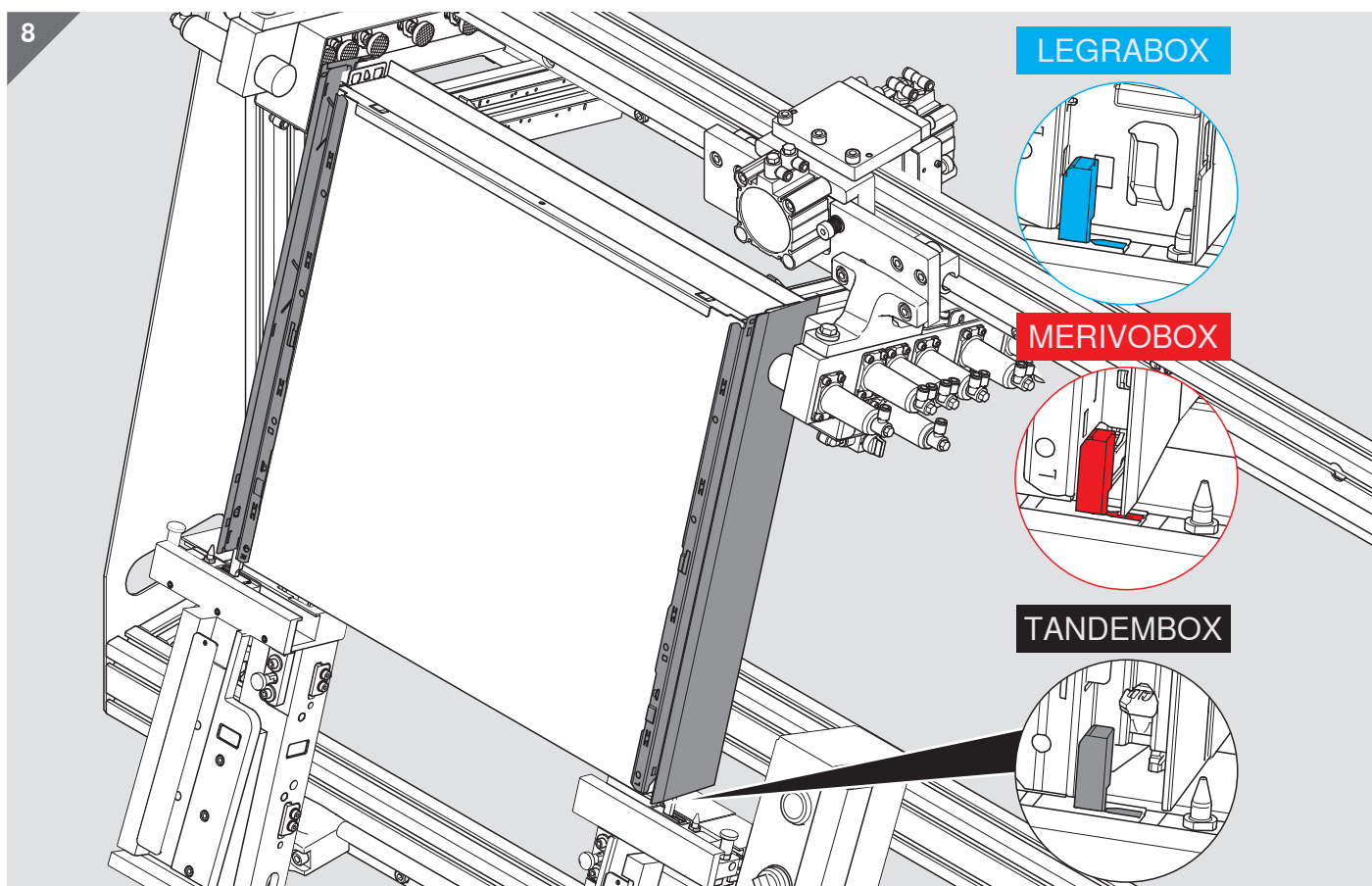
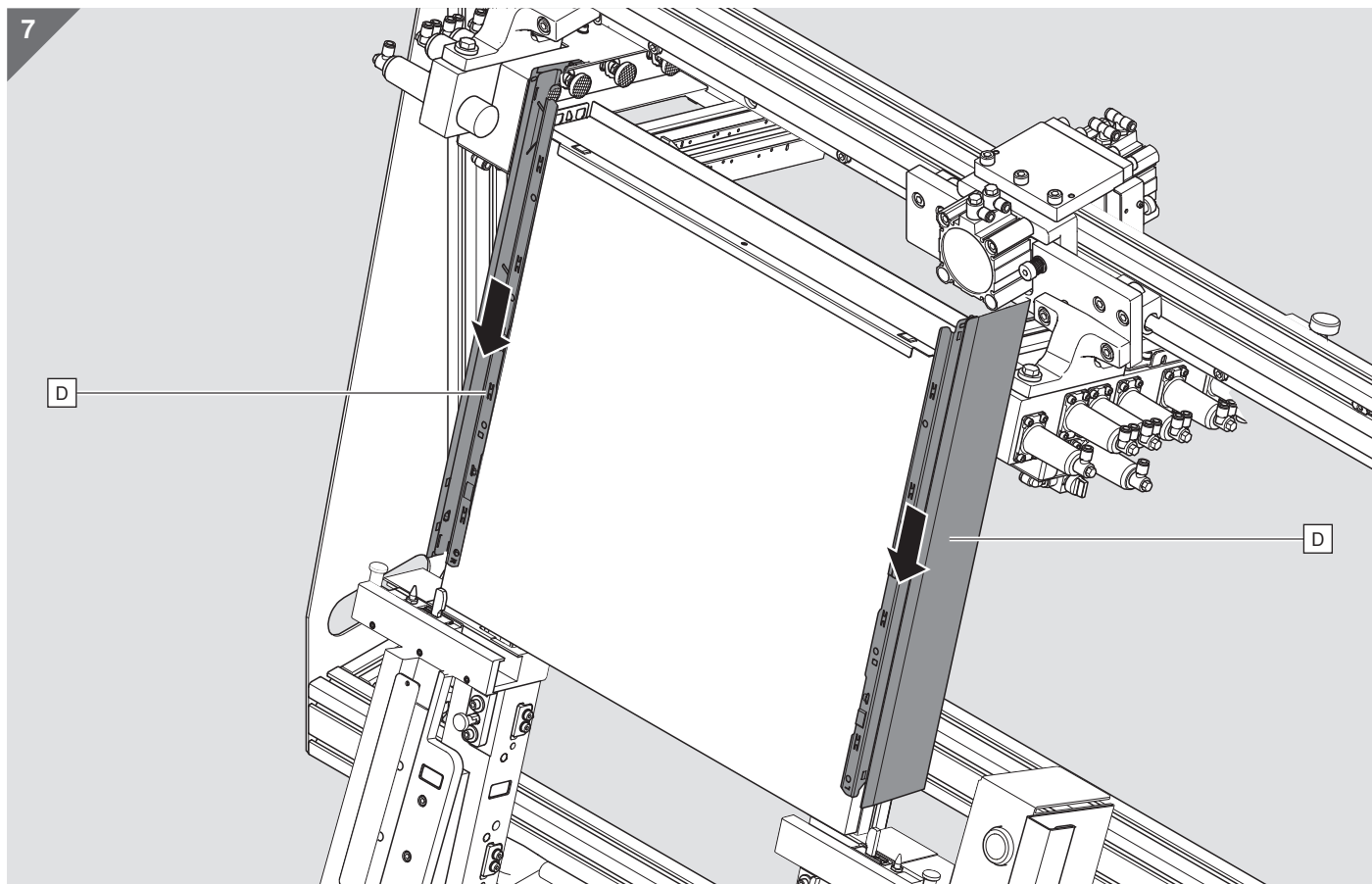

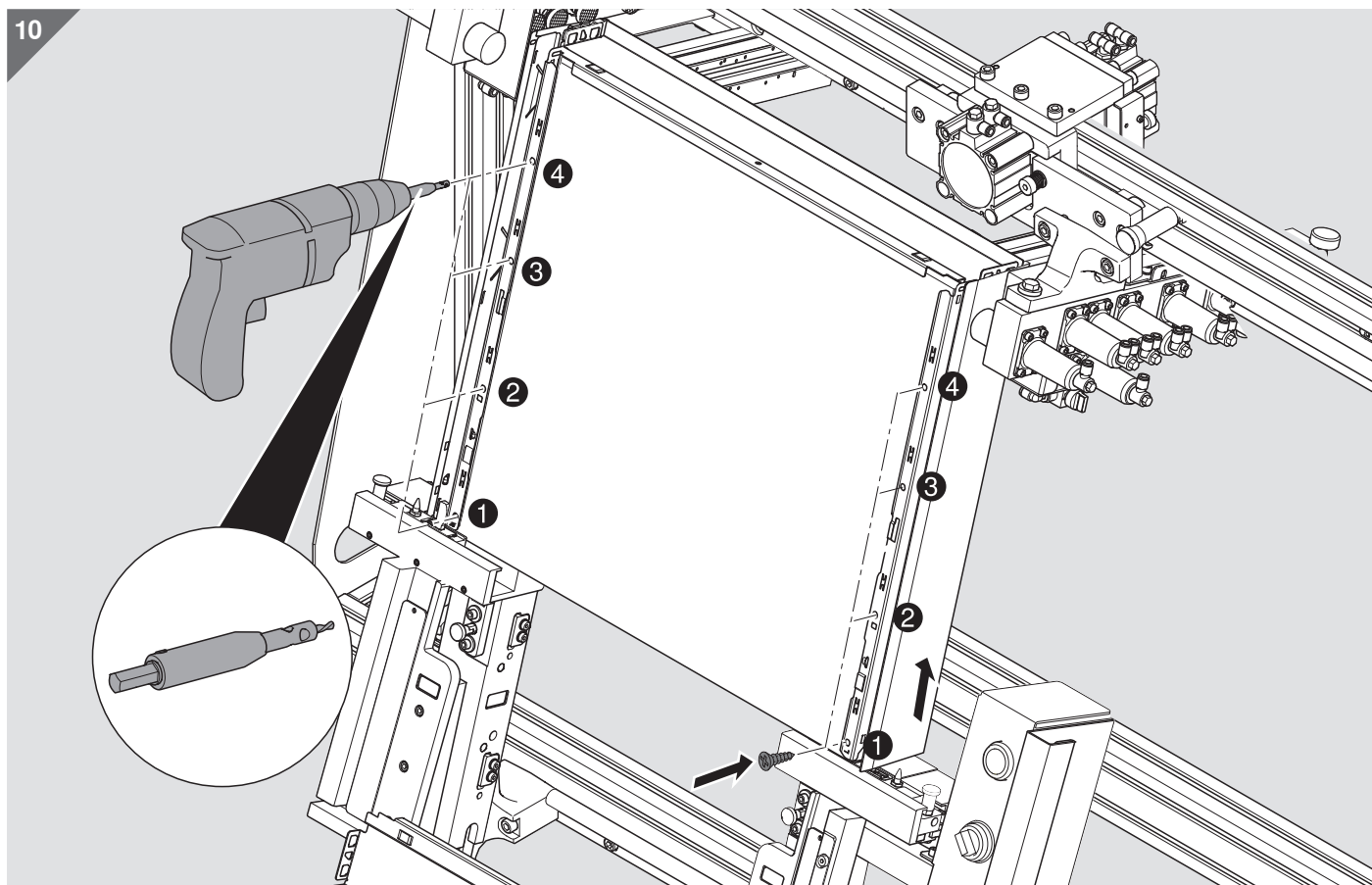
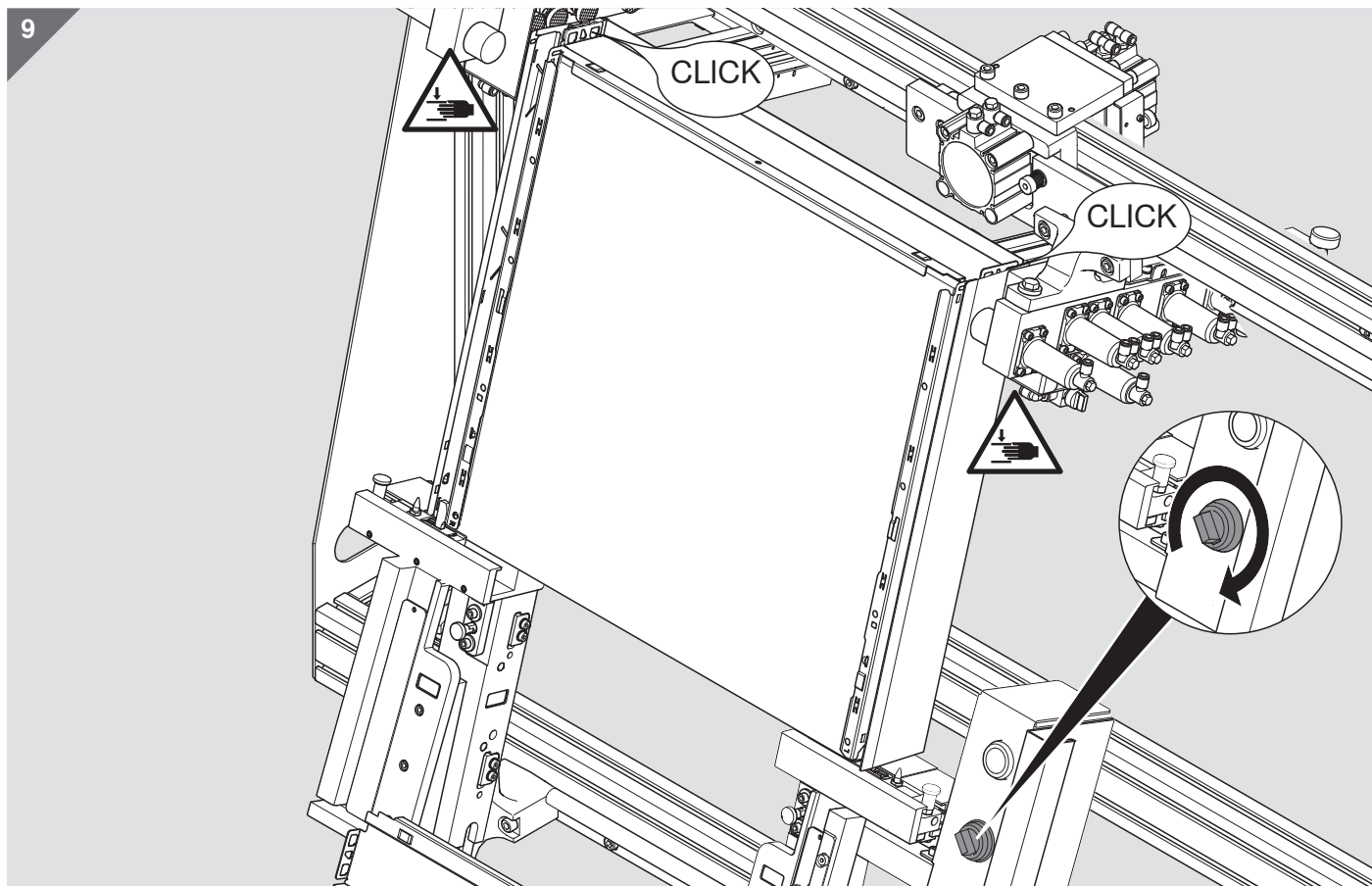

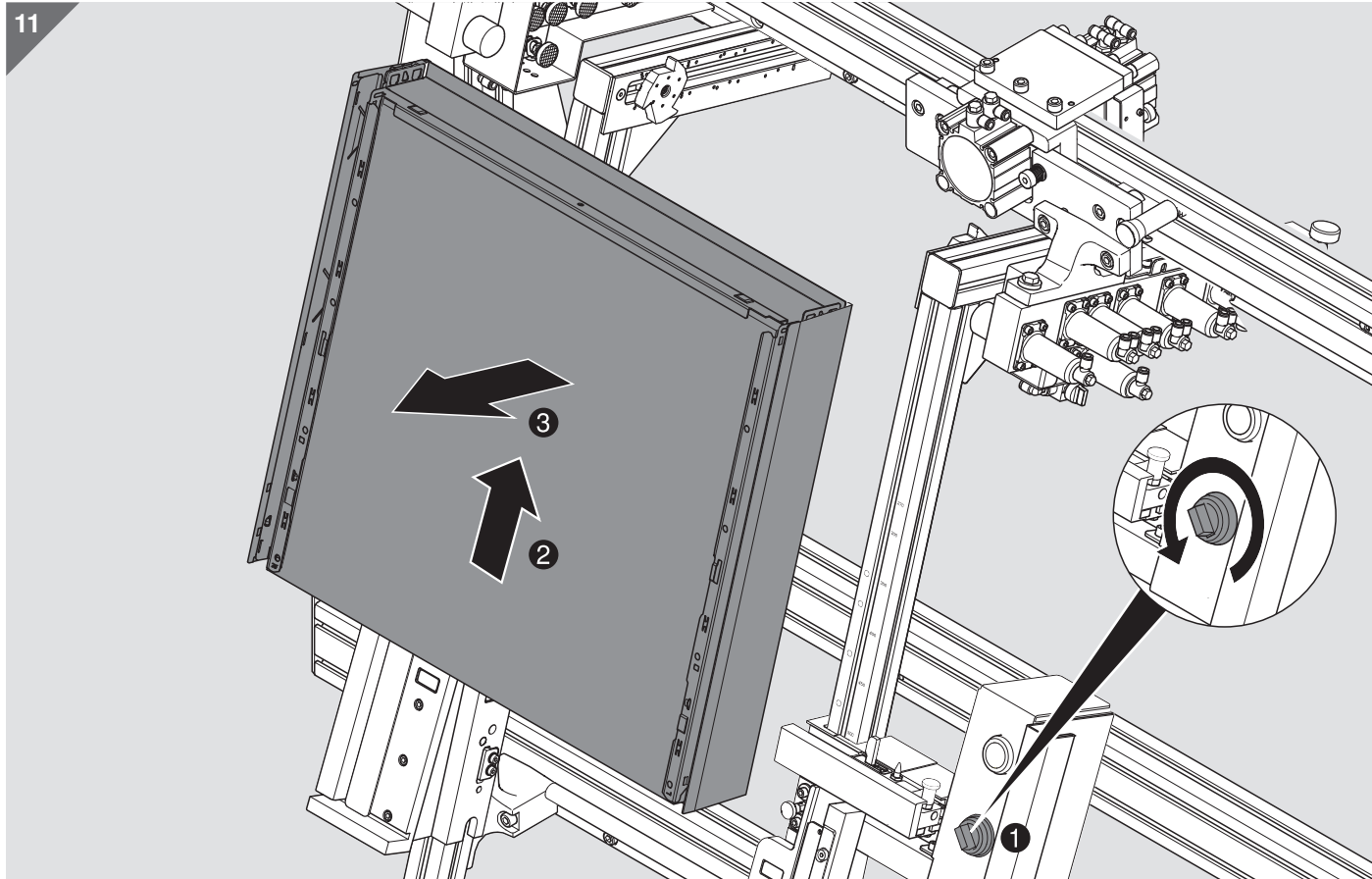

Disassembling the BOXFIX plus and lifting it again



WARNING

The assembly machine weighs 70 kg.

Failure to follow this information may lead to serious personal injury or property damage.

- Slide the movable carriage to the right.
- Fit the transportation locks.
- Detach the assembly machine from the subsurface.

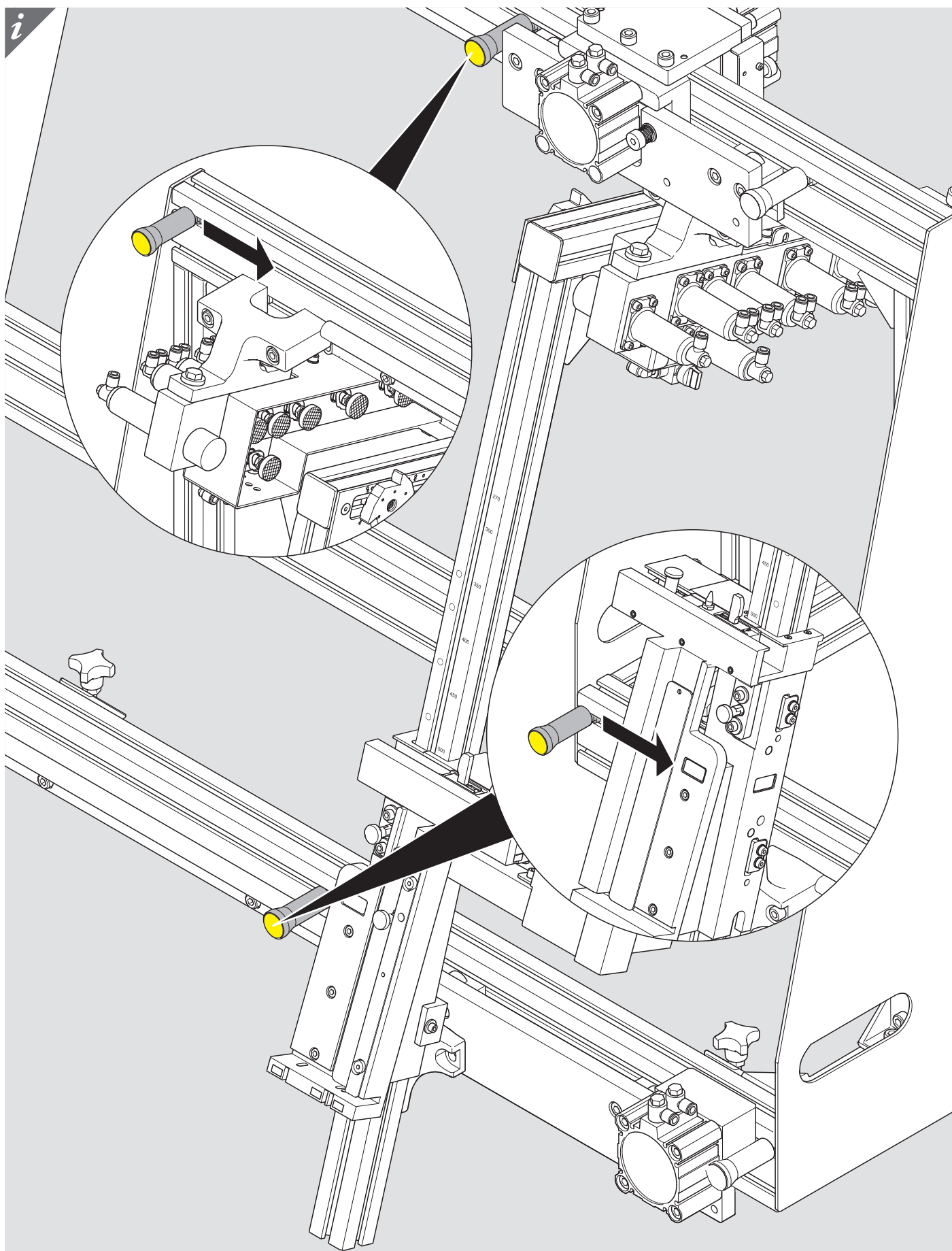

Simplified EU declaration of conformity for BOXFIX plus

Julius Blum GmbH hereby declares that machine type ZMM.2500 complies with Machinery Directive 2006/42/EC.

The complete text of the EU declaration of conformity is available at the following Internet address:

www.blum.com/compliance

Technical data

Only use in dry, enclosed rooms.

Dimensions / weight:

Height: _____ 1072 mm
 Width: _____ 1717 mm
 Depth: _____ 633 mm
 Weight: _____ 70 kg

Pressurised air supply:

Air pressure: _____ 7 bar / 101 psi / 0.7 MPa
 Air consumption: _____ 2 litres

Sound:

Emission – sound pressure level (LAeq): _____ 75 dB(A)
 Measuring uncertainty: _____ +/- 4 dB(A)

ID tag

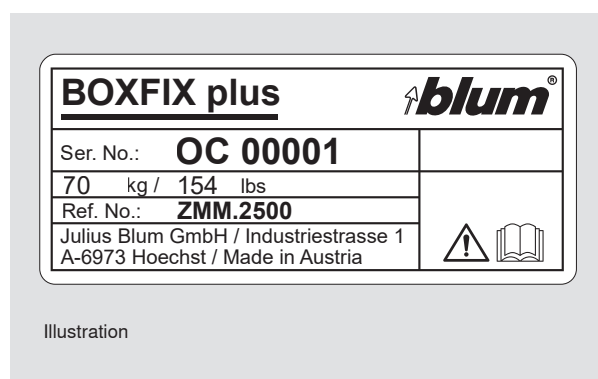

Device type: assembly equipment – Blum box systems.

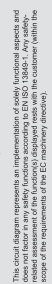



CAUTION

- Wear eye protection during cleaning work.



NOTE

- Replace damaged parts immediately.
Only use BLUM original parts.
- Do not use oil or lubricants for cleaning.
All runners and bearings are maintenance-free.
- Do not use sharp-edged or metallic objects to remove dust or chips.
- We recommend using microfibre cloths for cleaning work.



NOTE

- Daily maintenance work should be performed before starting work, a shift change or operator change.
- You should read the Safety chapter to ensure safe handling of the assembly machine.

Daily maintenance work

- Before starting work, check the pressurised air line for damage. Damaged lines should only be replaced by authorised personnel.
- Check the protection equipment of the assembly machine.
- Perform a visual inspection of the runners; if necessary, wipe away the dust using a microfibre cloth.
- Defective parts may only be replaced by authorised personnel.

Monthly maintenance work

- Check the air filter unit for water residue, which can collect in the air filter unit; empty if necessary.

Blum partners worldwide can be found at:
www.blum.com/addresses

Look for our
FSC™-certified
products



BAU2471789370 · IDX: 02 · IDNR: 03826155 · BA-225/0EN · 11.24 · © Copyright by Blum

Julius Blum GmbH
6973 Höchst, Austria
Tel.: +43 5578 705-0
Fax: +43 5578 705-44
E-mail: info@blum.com
www.blum.com

Our sites in Austria, Poland and China are certified to the international standards mentioned below.
Our site in the USA is certified to ISO 9001.
Our site in Brazil is certified to ISO 9001, ISO 14001 and ISO 45001.



ISO 9001
Certified Quality
System



ISO 14001
Certified Environmental
System



ISO 50001
Certified Energy
System

