

TANDEMBOX



Dual Sink Drawer

Application



Features

- Full extension drawer system with BLUMOTION
- TANDEM smooth running mechanism
- Three-dimensional drawer front adjustment
- Static load capacity of 100 lb

M Height

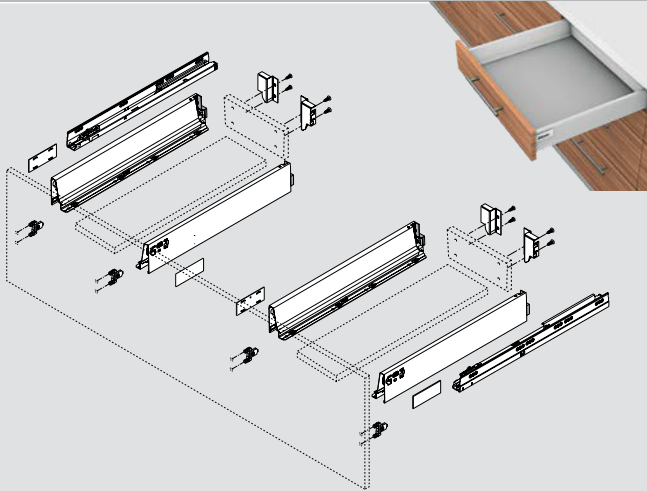

See M Height required components and specifications

D Height with Single Gallery

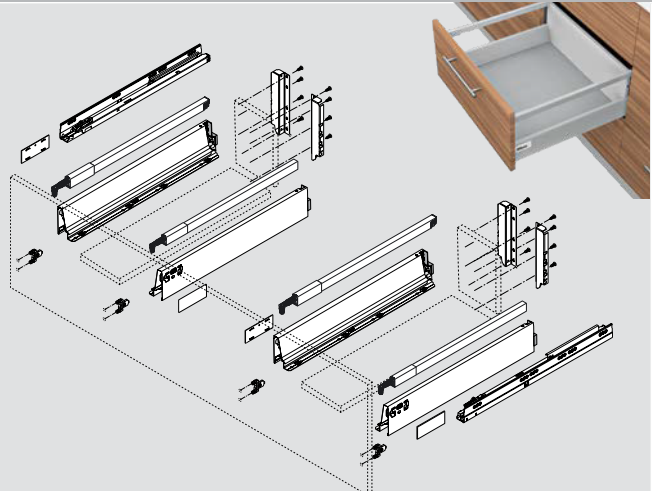

See D Height required components and specifications

Cutting dimensions for bottom and back

A Drawer back

Width = Y minus 12 then subtract 12
 M Height = 84 (3-5/16")
 D Height = 199 (7-13/16")
 Y minimum = 48 (1-7/8")
 Y maximum = **Trial recommended**

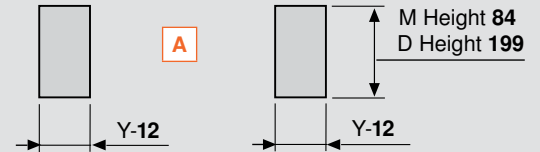

B Drawer bottom

Minimum width = 43 (1-11/16") each
 Length = Actual cabinet profile length minus 24 (15/16")
 Y = Drawer bottom width minus (SW+63) divided by 2

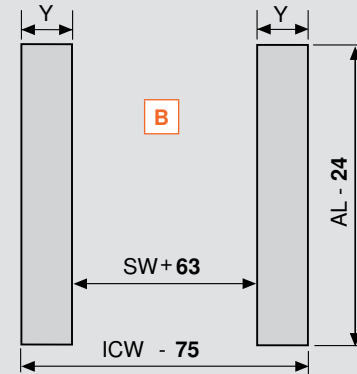
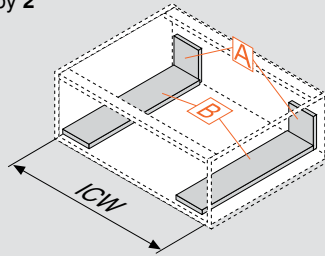

AL = Actual cabinet profile length

ICW = Inside cabinet width

SW = Width of the sink

Y = Drawer bottom width of side 1 or 2 (variable)

Z = Actual cabinet profile length minus 164 (6-7/16")

NOTE: Use 16 (5/8") material for bottom and back

Drawer front preparation

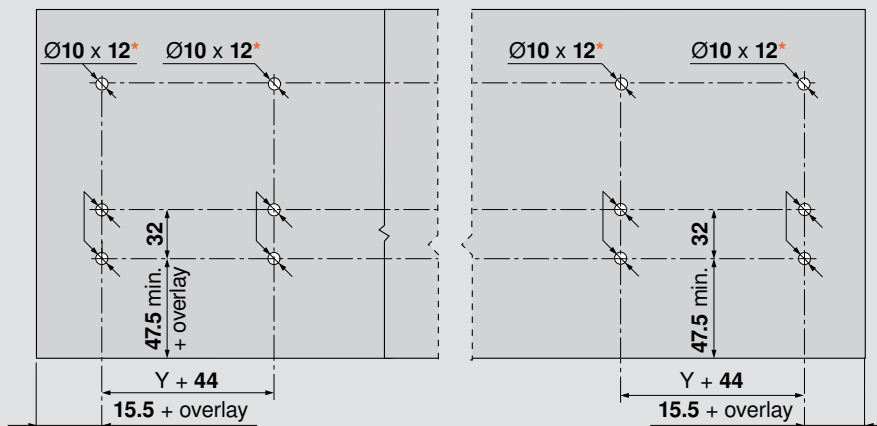

*Pre-boring dimensions for INSERTA and EXPANDO only, for screw-on pre-bore Ø2 x 2.5

TANDEMBOX



M Height

Application



Features

- Full extension drawer system with BLUMOTION
- TANDEM smooth running mechanism
- Two-dimensional drawer front adjustment
- Static load capacity of 100 lb
- Drawer side height **84** (3-5/16")

Space Requirements

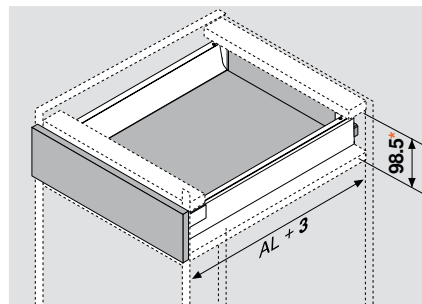

AL = Actual cabinet profile length
*Minimum opening height based on 3 (1/8") clearance

Components

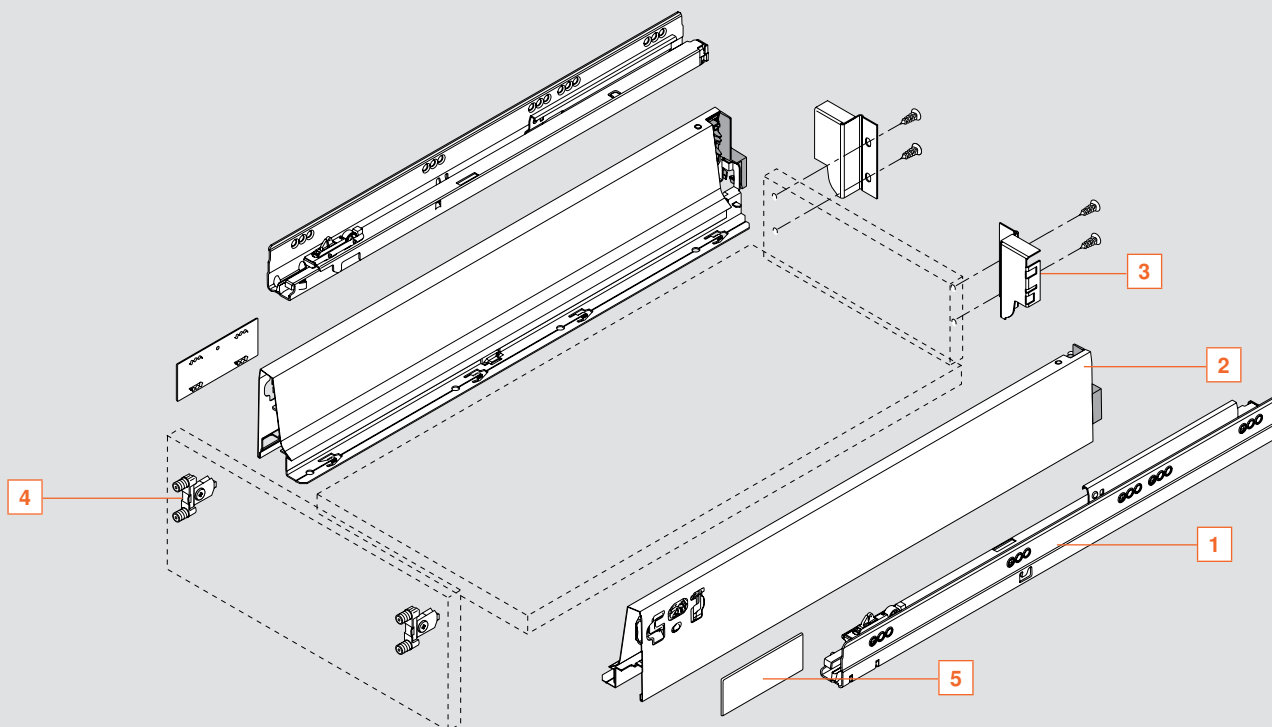

NOTE: Parts identified on right page



Cabinet and drawer profiles

- Left and right drawer & cabinet profiles must be ordered separately

1 Cabinet profile

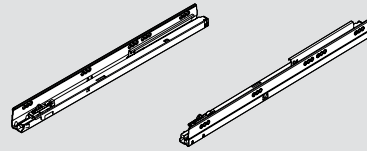

2 Drawer profile

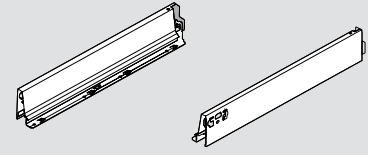

Nominal length	Actual cabinet profile length	100 lb		Gray	
16"	400 (15-3/4")	578.4001B L	578.4001B R	378M4002SA L	378M4002SA R
18"	450 (17-11/16")	578.4501B L	578.4501B R	378M4502SA L	378M4502SA R
20"	500 (19-11/16")	578.5001B L	578.5001B R	378M5002SA L	378M5002SA R
22"	550 (21-5/8")	578.5501B L	578.5501B R	378M5502SA L	378M5502SA R
Installation wood screw		707N	707N	612TH	
Installation system screw		661.1300.HG	661.1300.HG		

Rear fixing bracket set

3

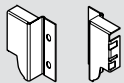

- Set includes:**
- Left and right bracket
 - Gray (R906)

Part no.

Rear fixing bracket set	Z30M000S.04
Installation screw	612TH

Front fixing bracket

4

- Two required per drawer
- M height drawer profiles only

INSERTA



Screw-on



Part no.

INSERTA	ZSF.39A2
Screw-on*	ZSF.35A2

*Use of #6 x 3/4" minimum truss head screw is recommended

TANDEMBOX cover caps

5

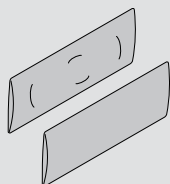

- For use with TANDEMBOX drawers
- Non-handed, symmetrical design
- Gray
- Custom logo printing available
- Order two cover caps per drawer

Part no.

Blum logo cover cap	ZAA.532C.BT
Blank cover cap	ZAA.532C

Cabinet profile installation

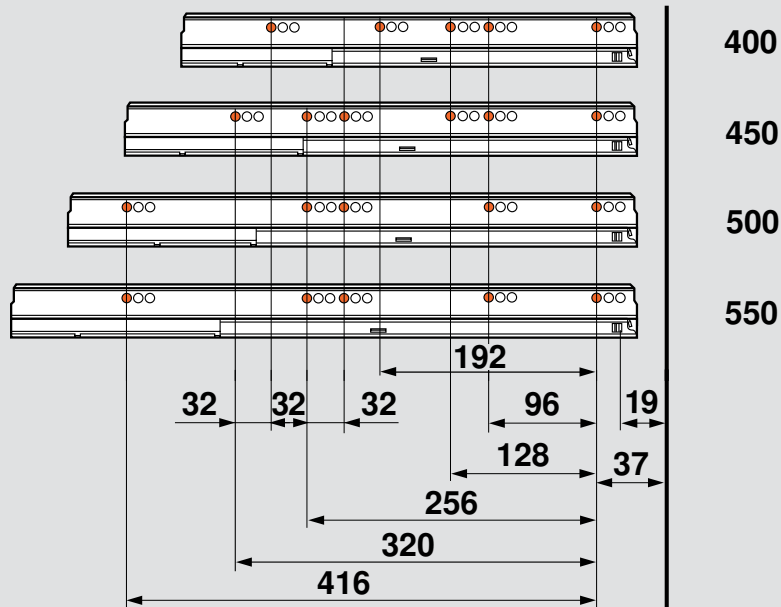

NOTE: Recommended screw locations in orange (system screws or #7 wood screws)

Cutting dimensions for bottom and back

Drawer bottom

Width = Inside cabinet width minus 75 (2-15/16")
 Length = Actual cabinet profile length minus 24 (15/16")

Drawer back

Width = Inside cabinet width minus 87 (3-7/16")
 Height = 84 (3-5/16")

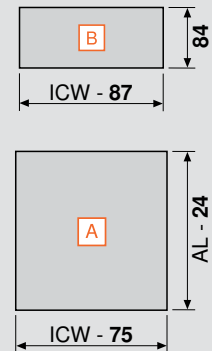
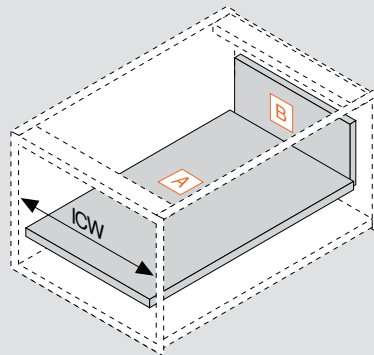

AL = Actual cabinet profile length
 ICW = Inside cabinet width

NOTE: Use 16 (5/8") material for bottom and back

Front fixing bracket installation

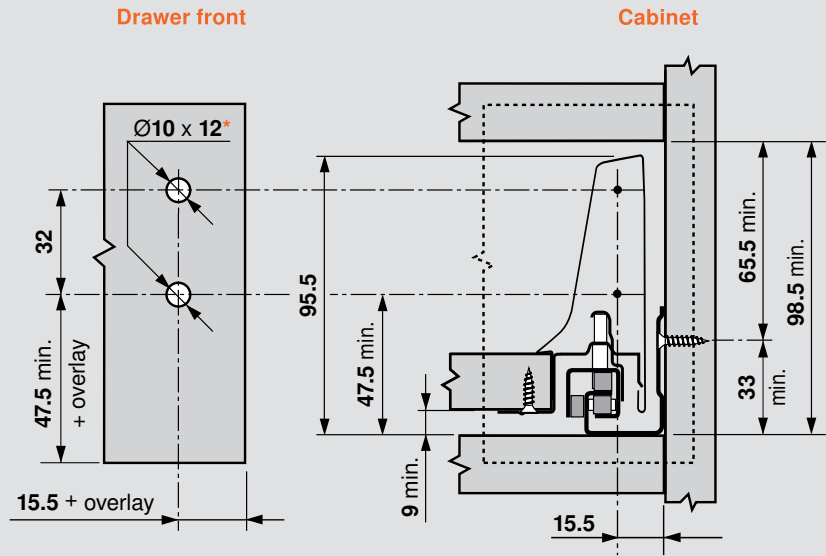

*Pre-boring dimensions for INSERTA and EXPANDO only, for screw-on pre-bore $\text{Ø}2 \times 2.5$

Rear fixing bracket installation

Drawer back

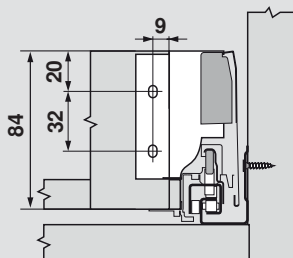

TANDEMBOX



D Height with Single Gallery

Application



Features

- Full extension drawer system with BLUMOTION
- TANDEM smooth running action
- Three-dimensional drawer front adjustment
- Static load capacity of 100 lb
- Drawer side height 207 (8-1/8")

Space Requirements

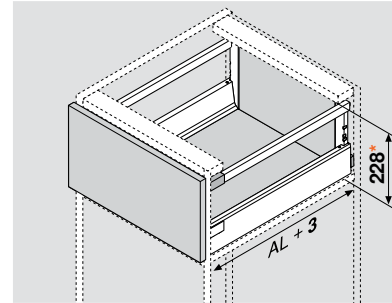

AL = Actual cabinet profile length
*Minimum opening height based on 3 (1/8") clearance

Components

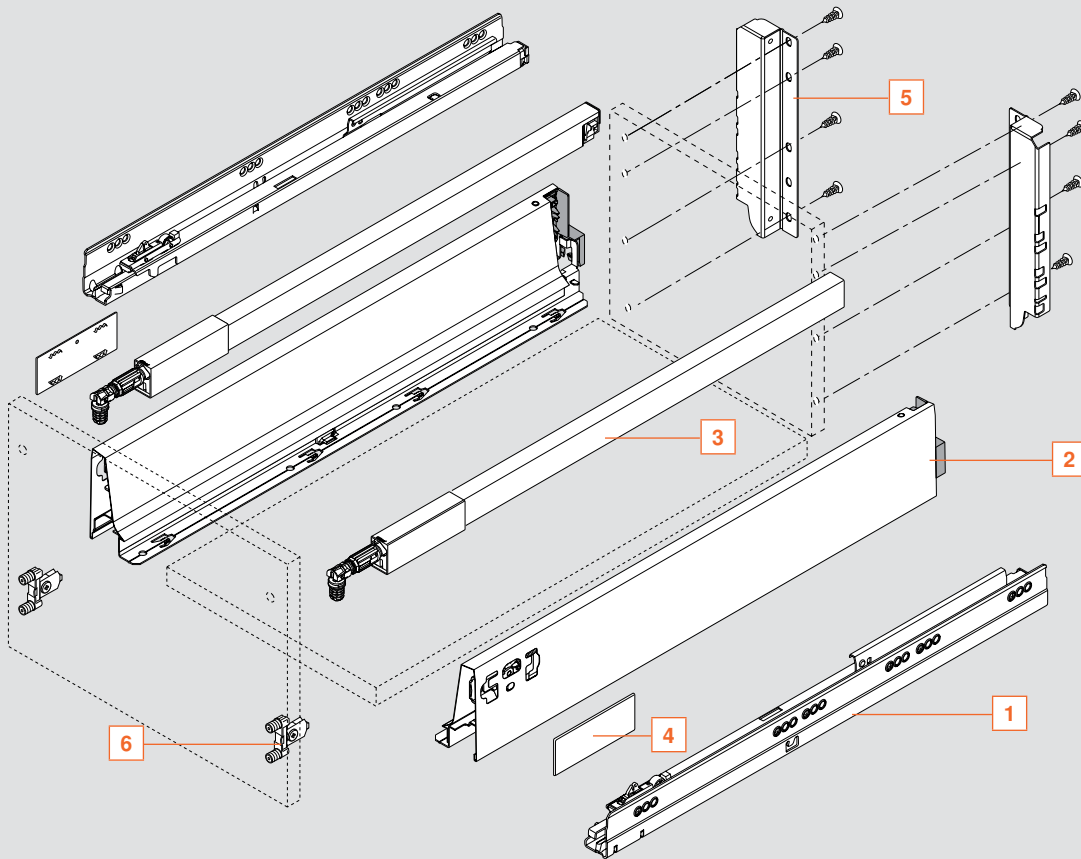

NOTE: Parts identified on right page

Required Parts

TANDEMBOX



Cabinet and drawer profiles

- Left and right drawer & cabinet profiles must be ordered separately

1 Cabinet profile

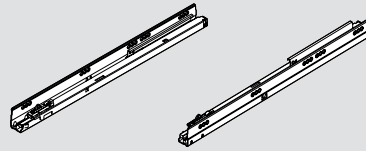

2 Drawer profile

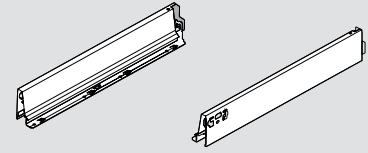

Nominal length	Actual cabinet profile length	100 lb		Gray	
16"	400 (15-3/4")	578.4001B L	578.4001B R	378M4002SA L	378M4002SA R
18"	450 (17-11/16")	578.4501B L	578.4501B R	378M4502SA L	378M4502SA R
20"	500 (19-11/16")	578.5001B L	578.5001B R	378M5002SA L	378M5002SA R
22"	550 (21-5/8")	578.5501B L	578.5501B R	378M5502SA L	378M5502SA R
Installation wood screw		707N	707N	612TH	
Installation system screw		661.1300.HG	661.1300.HG		

Top gallery rails

3

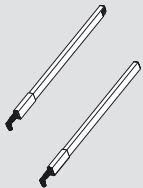

- Left and right gallery rails must be ordered separately

Actual cabinet profile length	Gray	
400 (15-3/4")	ZRG.337RSIC L	ZRG.337RSIC R
450 (17-11/16")	ZRG.387RSIC L	ZRG.387RSIC R
500 (19-11/16")	ZRG.437RSIC L	ZRG.437RSIC R
550 (21-5/8")	ZRG.487RSIC L	ZRG.487RSIC R

TANDEMBOX cover caps

4

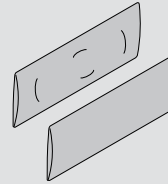

- For use with TANDEMBOX drawers
- Non-handed, symmetrical design
- Gray
- Custom logo printing available
- Order two cover caps per drawer

Part no.	
Blum logo cover cap	ZAA.532C.BT
Blank cover cap	ZAA.532C

Rear fixing bracket set

5

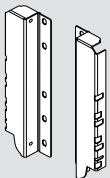

Set includes:

- Left and right bracket
- Gray (R906)

Part no.	
Rear fixing bracket set	Z30D000SL
Installation screw	612TH

Front fixing bracket

6

INSERTA



Screw-on



- Two required per drawer
- For use with M height drawer profiles only

Part no.	
INSERTA	ZSF.39A2
Screw-on*	ZSF.35A2

*Use of #6 x 3/4" minimum truss head screw is recommended

Cabinet profile installation

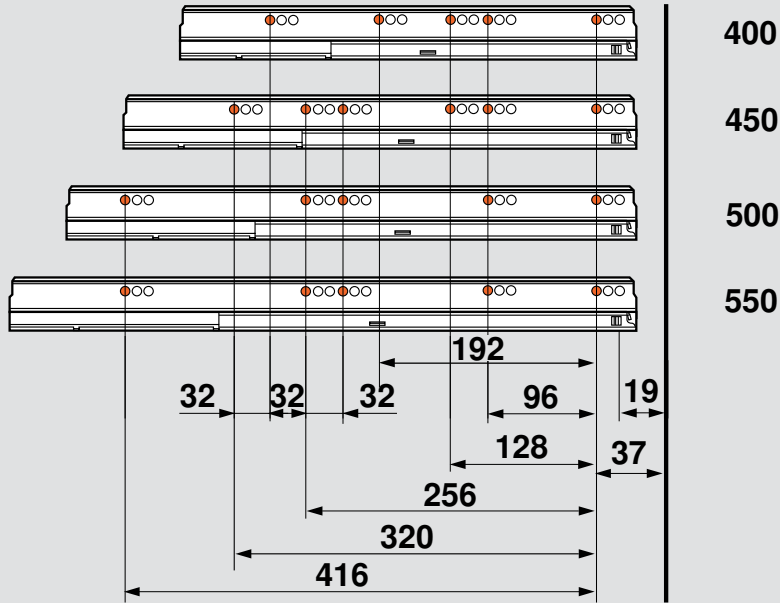

NOTE: Recommended screw locations in orange (system screws or #7 wood screws)

Cutting dimensions for bottom and back

Drawer bottom

Width = Inside cabinet width minus **75** (2-15/16")
Length = Actual cabinet profile length minus **24** (15/16")

Drawer back

Width = Inside cabinet width minus **87** (3-7/16")
Height = **199** (7-13/16")

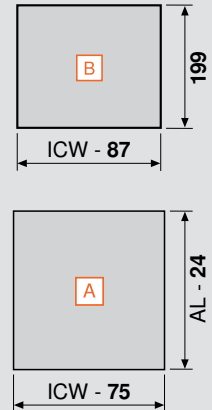
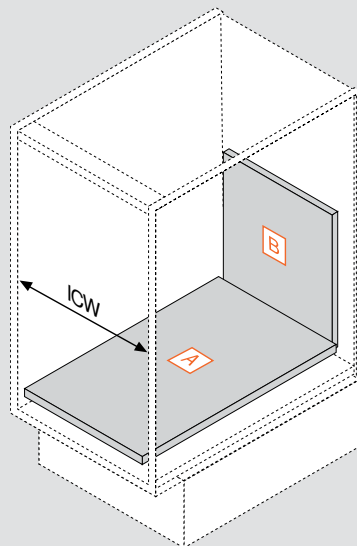

AL = Actual cabinet profile length
ICW = Inside cabinet width

NOTE: Use **16** (5/8") material for bottom and back

Front fixing bracket installation

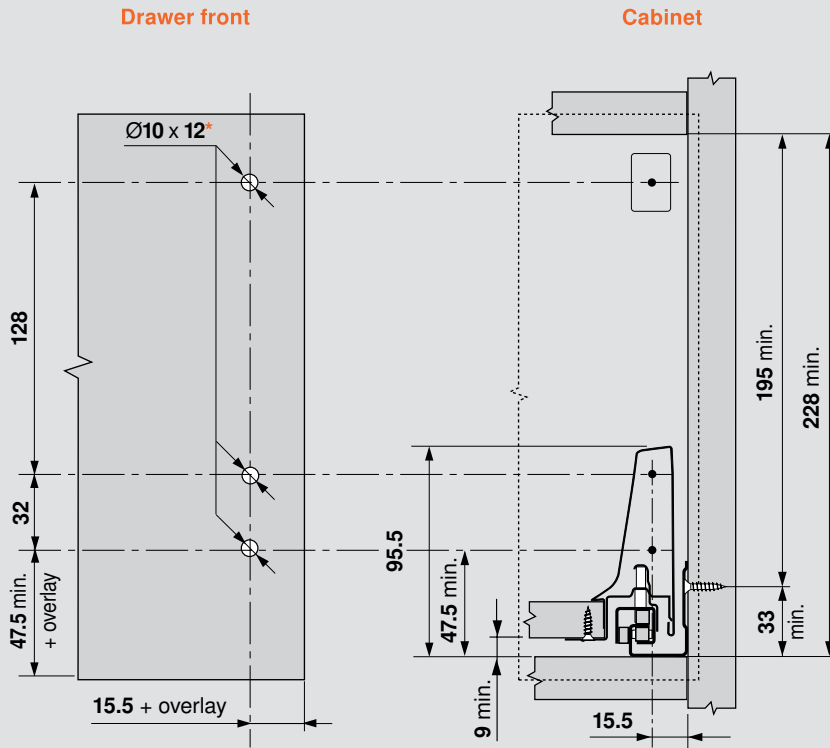

*Pre-boring dimensions for INSERTA and EXPANDO only, for screw-on pre-bore Ø2 x 2.5

Rear fixing bracket installation

Drawer back

