

Cleaning information

For Blum fittings



Quality for the lifetime of the furniture

Blum fittings should give pleasure for the lifetime of the furniture.
We have put together some helpful tips to make cleaning them easier for you.

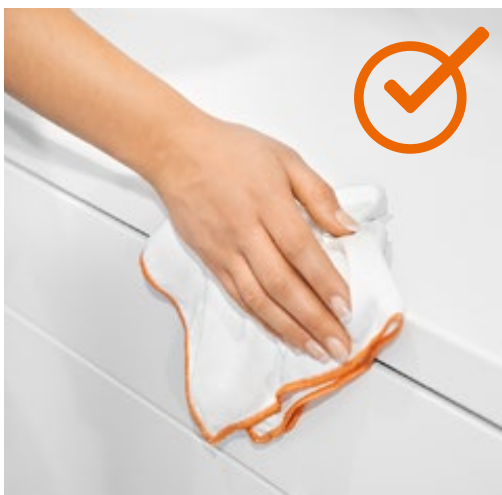

The best way to clean your Blum fittings is as follows:

- Use a soft, lint-free cloth, a chamois leather or a sponge
- Ensure that the material you use to wipe the furniture with is just damp, not wet
- Always wipe the furniture again afterwards with a dry cloth
- If possible, use cleaning products intended specifically for materials such as leather, stainless steel etc.; otherwise, use only clean water
- Wipe off dirt as soon as it appears

Damp cloth



Observe the following when cleaning Blum fittings:

- Do not use steam cleaners
- Do not use cleaning agents such as abrasive cleaning powders, steel wool and scourers, as well as cleaning agents that contain acetone, chlorine, nitro thinners and solvents starting with "tri" or "tetra"
- Be cautious when using biological cleaning agents that often contain organic acids
- Do not store items like cleaning agents, baking powder, dishwasher products or table salt in a damp environment, as direct contact and vapours can cause various metallic surfaces to corrode.

No chemical cleaning agents



Quality for premium furniture

All Blum products are subject to extensive quality tests.
They should give pleasure for the lifetime of the furniture.
We provide you with practical cleaning information.



Lift systems



Hinge systems



Box systems



Runner systems



Pocket systems



SERVO-DRIVE, the electric motion support system



ORGA-LINE containers



AMBIA-LINE cutlery insert in steel design



AMBIA-LINE frame, steel design



ORGA-LINE cross divider



AMBIA-LINE cutlery insert in wood design



AMBIA-LINE frame, wood design

Perfect motion for your furniture

Blum's innovative fittings solutions deliver top quality motion and enhanced convenience to all living areas, especially the kitchen. They make everyday kitchen use easy and more ergonomic. They turn opening and closing furniture into a mesmerising experience.

We hope you enjoy your Blum products – for the lifetime of the furniture.

PT. Blum Furniture Hardware Indonesia
ICE Business Park BSD
Blok A No. 1 & 2
Jl. BSD Grand Boulevard
Tangerang 15339, Indonesia
Ph. +62 21 3972 1050
E-mail: info.id@blum.com

Julius Blum GmbH
6973 Höchst, Austria
Tel.: +43 5578 705-0
Fax: +43 5578 705-44
E-mail: info@blum.com
www.blum.com

Our sites in Austria, Poland and China are certified to the international standards mentioned below.
Our site in the USA is certified to ISO 9001.
Our site in Brazil is certified to ISO 9001, ISO 14001 and ISO 45001.



Look for our
FSC™-certified
products

All content is copyrighted by Blum.
Subject to technical modifications and changes to the range without notice.
IDNR: 000.000.0 · FO-024/2 EN-ID/06.24