

COMBOX

Now even more convenience when using
SERVO-DRIVE

www.blum.com

 blum®

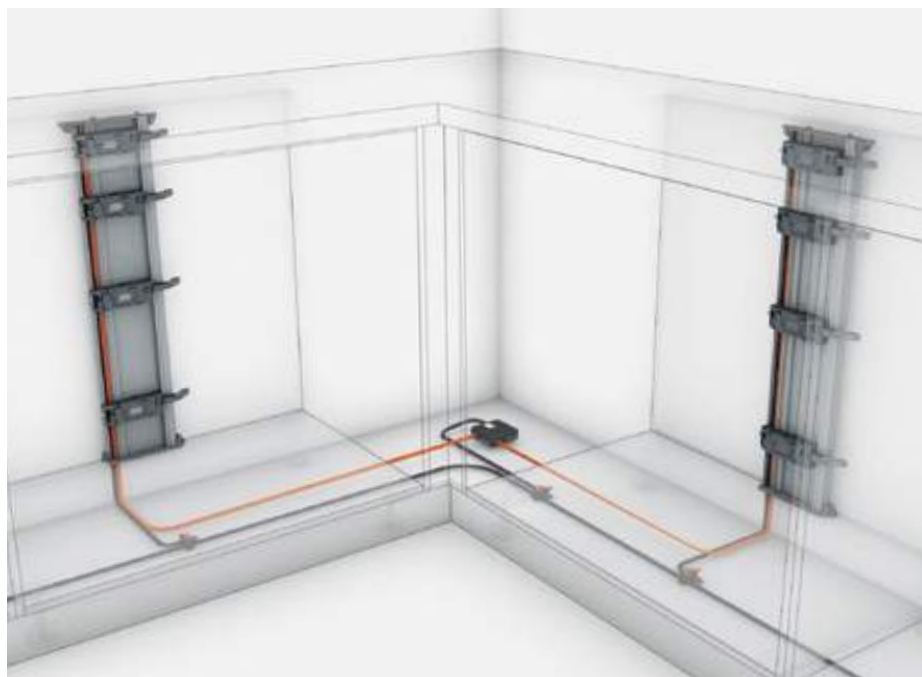

Memo

i

Details



Z10ZC00A

COMBOX prevents front collisions when using SERVO-DRIVE in corner situations, offering improved safety for the user.

- SERVO-DRIVE drive units communicate with each other so that simultaneous opening is avoided, thus preventing a collision of drawers in a corner situation.
- COMBOX ensures communication between the corresponding SERVO-DRIVE drive units. They are connected to each other via a communication cable from COMBOX.
- When a drawer is opened, then all drawers in the other cabinet situated in the corner are locked. The drawers in the same cabinet can continue to be opened as normal.
- Once the drawer has closed completely, then the drawers in the other cabinet can be opened again.
- COMBOX can only be used with the optimised SERVO-DRIVE drive unit and above: Z10A3000.02

i

Note

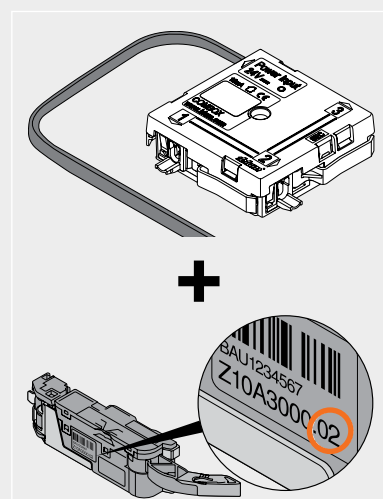

Z10A3000.02